

34-34-14W

KANSAS DRILLERS LOG

API No. 15 — 007 — 20,406
County Number

Operator
Cities Service Oil Company

Address
700 Sutton Pl. Bldg., 209 E. William, Wichita, Kansas 67202

Well No. 1 Lease Name Baier "C"

Footage Location
2310 feet from (N) (S) line 990 feet from (E) (W) line

Principal Contractor Geologist
Gabbert & Jones Sam Houston - Well Site

Spud Date Total Depth P.B.T.D.
3-24-76 4928' 4885'

Date Completed Oil Purchaser
6-4-76 None

S. 34 T. 34S R. 14 Ex W
Loc. 2310' FSL, 990' FEL

County Barber

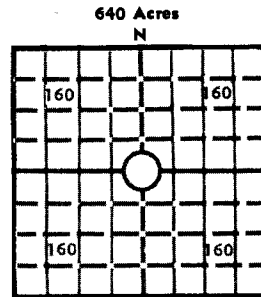

APR 07 1977

Locate well correctly
Elev.: Gr. 1600'
DF 1606' KB 1609'

CASING RECORD

Report of all strings set — surface, intermediate, production, etc.

Purpose of string	Size hole drilled	Size casing set (in O.D.)	Weight lbs/ft.	Setting depth	Type cement	Sacks	Type and percent additives
Surface	12-1/4"	8-5/8"	24#	428'	Reg. Portland Pozmix	150	2% CaCl ₂
Production	7-1/4"	4-1/2"	10.5#	4927'	Class "A"	300	7.5" CFR-2 10% Salt
					50-50 Pozmix	100	

LINER RECORD

PERFORATION RECORD

Top, ft.	Bottom, ft.	Sacks cement	Shots per ft.	Size & type	Depth interval
			4	1/2"	4832-38'
TUBING RECORD			1	1/2"	4869-76'
Size	Setting depth	Packer set at			
2"	4876'				

ACID, FRACTURE, SHOT, CEMENT SQUEEZE RECORD

Amount and kind of material used	Depth interval treated
Acidize with 1000 gal. 7-1/2" MCA and w/1000 gal 15% NE Acid	4832-76'
Frac. w/5000 gal. gelled water pad, 21,000 gals. gelled water, 21,000# 20-40 sand. Flushed with 2570 gal. water	4832-76'

INITIAL PRODUCTION

Date of first production Waiting on gas contract.		Producing method (flowing, pumping, gas lift, etc.) Flowing	
RATE OF PRODUCTION PER 24 HOURS	Oil bbls.	Gas 800 MCF	Water bbls.
Disposition of gas (vented, used on lease or sold) Sold		Gas-oil ratio CFPB	
Producing interval (s) 4832' - 4876'			

INSTRUCTIONS: As provided in KCC Rule 82-2-125, within 90 days after completion of a well, one completed copy of this Drillers Log shall be transmitted to the State Geological Survey of Kansas, 4150 Monroe Street, Wichita, Kansas 67209. Copies of this form are available from the Conservation Division, State Corporation Commission, 3830 So. Meridian (P.O. Box 17027), Wichita, Kansas 66217. Phone AC 316-522-2206. If confidential custody is desired, please note Rule 82-2-125. Drillers Logs will be on open file in the Oil and Gas Division, State Geological Survey of Kansas, Lawrence, Kansas 044.

operator

Cities Service Oil Co.

DESIGNATE TYPE OF COMP.: OIL, GAS, DRY HOLE, SWDW, ETC.:

Well No. 1	Lease Name Baier "C"	Gas
---------------	-------------------------	-----

S 34 T 34S R 14 ~~W~~
W

WELL LOG

Show all important zones of porosity and contents thereof; cored intervals, and all drill-stem tests, including depth interval tested, cushion used, time tool open, flowing and shut-in pressures, and recoveries.

SHOW GEOLOGICAL MARKERS, LOGS RUN, OR OTHER DESCRIPTIVE INFORMATION.

FORMATION DESCRIPTION, CONTENTS, ETC.	TOP	BOTTOM	NAME	DEPTH
See attached.				

USE ADDITIONAL SHEETS, IF NECESSARY, TO COMPLETE WELL RECORD.

Date Received

Signature W. J. Devaney

Region Operations Manager

Title

6/14/76

Date

3d-3d-1dcm

GABBERT-JONES, INC.
 WICHITA, KANSAS
 DRILLERS' WELL LOG

34-34-14W

Baier "C" #1
 Sec 34-34S-14W
 Barber County Kansas

Commenced: 3-24-76

Completed: 4-4-76

OPERATOR: CITIES SERVICE OIL CO.

Depth From	to	Formation	Remarks
0	400	Sand-Clay	Ran 10 jts of 24# 8 5/8" csg
400	1157	Redbed	set @ 428' Cemented w/
1157	1625	Shale	300 sks 50/50 Posmix 2% CC
1625	1665	Anhy	PD @ 7:50 a.m. 3-25-76
1665	1880	Shale	
1880	2197	Shale-Shells	
2197	2783	Shale-Lime	
2783	3290	Lime-Shale	
3290	3827	Shale-Lime	
3827	4600	Lime-Shale	Ran 152 jts of 10 1/2# K55
4600	4680	Lime	4 1/2" csg set @ 4927' Cemented
4680	4795	Lime-Shale	w/250 sks Class A .75%
4795	4928	Lime	CFR-2 + 10% Salt
			PD @ 4:45 p.m. 4-4-76
	4928 - TD		

I, James S. Sutton II, certify this is a correct copy of the Drillers' Log for the well drilled Sec 34-34S-14W, Barber County, Kansas to the best of my knowledge and belief.

 JAMES S. SUTTON II

STATE OF KANSAS)
) SS
 COUNTY OF SEDGWICK)

Before me, the undersigned, a Notary Public within and for said County and State, on this 12th day of April, 1976, personally appeared James S. Sutton II to me personally known to be the identical person who executed the within and foregoing instrument and acknowledged to me that he executed the same as his free and voluntary act and deed for the uses and purposes therein set forth.

IN WITNESS WHEREOF, I HAVE HEREUNTO SET MY HAND AND OFFICIAL SEAL THE DAY AND YEAR LAST ABOVE WRITTEN.

 ELIZABETH J. EDWARDS, Notary PUBLIC

My Commission Expires: February 6, 1979.

