

JUL

KANSAS

**IMPORTANT**  
Kans. Geo. Survey request  
samples on this well.

**CONFIDENTIAL** 5W

**WELL COMPLETION REPORT AND  
DRILLER'S LOG**

*State Geological Survey*

S. 29 T. 34S R. 15 <sup>XX</sup> <sub>W</sub>  
Loc. C SE  
Barber

API No. 15 — 007 — 21048 **WICHITA BRANCH**  
County Number

Operator  
F.C.D. OIL CORPORATION

**RELEASED**  
Date: MAY 28 1982  
FROM CONFIDENTIAL

Address  
P.O. Box 5589 Enid, OK 73702

Well No. 1-29 Lease Name Brownback

Footage Location  
1320 feet from <sup>XX</sup> (S) line 1320 feet from (E) <sup>XX</sup> line

Principal Contractor DaMac Drilling, Inc. Geologist Walter L. Baker

Spud Date 11-16-80 Date Completed 6-3-81 Total Depth 4950' P.B.T.D. 4885'

Directional Deviation None Oil and/or Gas Purchaser Western Crude - oil

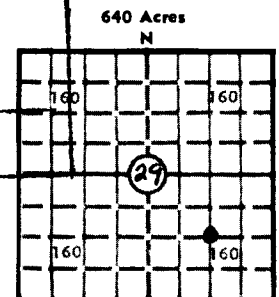

Elev.: Gr. 1606  
DF - KB 1616

**CASING RECORD**

Report of all strings set — surface, intermediate, production, etc.

Purpose of string	Size hole drilled	Size casing set (in O.D.)	Weight lbs/ft.	Setting depth	Type cement	Sacks	Type and percent additives
Surface	7 7/8	8 5/8	20#	894'	Class H	500	2% CC, 1/4# Flosal
Production	7 7/8	4 1/2	10.5#	4950'	Rodman Mix	300	None

**LINER RECORD**

**PERFORATION RECORD**

Top, ft.	Bottom, ft.	Sacks cement	Shots per ft.	Size & type	Depth interval
-	-	-	4	Jet - 1/2"	4876-4885'

Size	Setting depth	Packer set at
2 3/8	4804'	None

**ACID, FRACTURE, SHOT, CEMENT SQUEEZE RECORD**

Amount and kind of material used	Depth interval treated
Acidized w/2000 gal 15% DS-30	4876-4885'
Frac w/20,000 gal gel KCL water & 20,000#, 20/40 sd	4876-4885'

**INITIAL PRODUCTION**

Date of first production <u>8/3/81</u>	Producing method (flowing, pumping, gas lift, etc.) <u>Pumping</u>
RATE OF PRODUCTION PER 24 HOURS	Oil <u>6</u> bbls. Gas <u>150</u> MCF Water <u>40</u> bbls. Gas-oil ratio <u>25,000</u> CFPB
Disposition of gas (vented, used on lease or sold) <u>venting</u>	Producing interval (s) <u>4876-4885'</u>

INSTRUCTIONS: As provided in KCC Rule 82-2-125, within 90 days after completion of a well, one completed copy of this Drillers Log shall be transmitted to the State Geological Survey of Kansas, 4150 Monroe Street, Wichita, Kansas 67209. Copies of this form are available from the Conservation Division, State Corporation Commission, 245 No. Water, Wichita, Kansas 67202. Phone AC 316-522-2206. If confidential custody is desired, please note Rule 82-2-125. Drillers Logs will be on open file in the Oil and Gas Division, State Geological Survey of Kansas, Lawrence, Kansas 66044.

Operator F.C.D. OIL CORPORATION		DESIGNATE TYPE OF COMP.: OIL, GAS, DRY HOLE, SWDW, ETC.: Oil
Well No. 1-29	Lease Name Brownback	
S. 29 T. 34SR. 15 <sup>EX</sup> <sub>W</sub>		Barber

**WELL LOG**

Show all important zones of porosity and contents thereof; cored intervals, and all drill-stem tests, including depth interval tested, cushion used, time tool open, flowing and shut-in pressures, and recoveries.

SHOW GEOLOGICAL MARKERS, LOGS RUN, OR OTHER DESCRIPTIVE INFORMATION.

FORMATION DESCRIPTION, CONTENTS, ETC.	TOP	BOTTOM	NAME	DEPTH
Surface sand & gravel	0	350		
Shale & Anhydrite	350	1500		
Anhydrite & salt	1500	2900		
Shale & lime	2900	4200		
Lime	4200	4800		
Lime & Chat	4800	4939		

USE ADDITIONAL SHEETS, IF NECESSARY, TO COMPLETE WELL RECORD.

Date Received	Signature
	Vice-President
	Title
	9-3-81
	Date

9-3-81 - 1 PM

*State Geological Survey* WELL LOG  
WICHITA BRANCH

**CONFIDENTIAL** 29 34 15 W  
12

COMPANY F.C.D. Oil Corporation

SEC. 29 T. 34S R. 15W

FARM Brownback NO. 1-29

LOC. C-SE

TOTAL DEPTH 4950'

COUNTY Barber, Kansas

COMM. 11-16-80 COMP. 11-26-80

CONTRACTOR DaMac Drilling Inc.

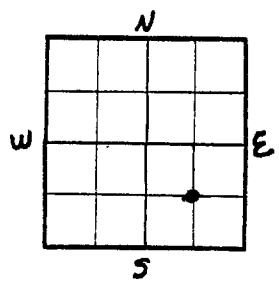

CASING 20" set @ 60'  
8 5/8 set @ 894

ELEVATION

PRODUCTION 4 1/2 set @ 4950

FIGURES INDICATE BOTTOM OF FORMATIONS

Surface Sand	0	900
Shale	900	3235
Shale, Lime	3235	4950 RTD

**RELEASED**  
Date: JAN 23 1982  
FROM CONFIDENTIAL