

KANSAS

36-34-15W

WELL COMPLETION REPORT AND DRILLER'S LOG

API No. 15 — 007 — 20,993
County Number

State Geological Survey
s. 36 T. 24S R. 15E W
SW NW SW
County Barber

Operator
CHAMPLIN PETROLEUM COMPANY

Address
6441 N.W. Grand Blvd., Suite 300, Okla. City, OK 73116

Well No. 3 Lease Name Davis Ranch 'Q'

Footage Location
1650 feet from XBC (S) line 330 feet from JEX (W) line

Principal Contractor H-30, Inc. Geologist Julie Osborne

Spud Date 9-13-80 Date Completed 12-12-80 Total Depth 4915' P.B.T.D. 4871'

Directional Deviation Oil and/or Gas Purchaser Permian

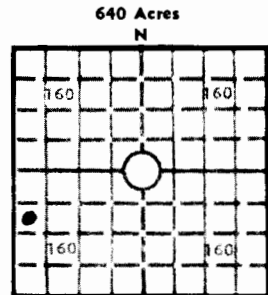

Locate well correctly

Elev.: Gr. 1552
DF KB 1564

CASING RECORD

Report of all strings set — surface, intermediate, production, etc.

Purpose of string	Size hole drilled	Size casing set (in O.D.)	Weight lbs/ft.	Setting depth	Type cement	Sacks	Type and percent additives
Surface	14-3/4"	10-3/4"	40.5#	286'	Pozmix	225	3% CaCl
	9-5/8"	8-5/8"		1090'	Class H	125	2% CaCl
Production	7-7/8"	5-1/2"	14#	4912'	50-50 Pozmix	200	18% salt

LINER RECORD

PERFORATION RECORD

Top, ft.	Bottom, ft.	Sacks cement	Shots per ft.	Size & type	Depth interval
			2	.05	4620-4630'

Size	Setting depth	Packer set at
2-3/8"	4734'	

ACID, FRACTURE, SHOT, CEMENT SQUEEZE RECORD

Amount and kind of material used	Depth interval treated
Acidized/1000 gal 15% MCA @ 5-8 BPM @ 850#	4620-30'

INITIAL PRODUCTION

Date of first production December 12, 1980	Producing method (flowing, pumping, gas lift, etc.) Pumping
RATE OF PRODUCTION PER 24 HOURS	Oil 4 bbls. Gas MCF 16 bbls. Water Gas-oil ratio CFPB
Disposition of gas (vented, used on lease or sold) Vented	Producing interval(s) 4620-30'

INSTRUCTIONS: As provided in KCC Rule 82-2-125, within 90 days after completion of a well, one completed copy of this Drillers Log shall be transmitted to the State Geological Survey of Kansas, 4150 Monroe Street, Wichita, Kansas 67209. Copies of this form are available from the Conservation Division, State Corporation Commission, 245 No. Water, Wichita, Kansas 67202. Phone AC 316-522-2206. If confidential custody is desired, please note Rule 82-2-125. Drillers Logs will be on open file in the Oil and Gas Division, State Geological Survey of Kansas, Lawrence, Kansas 66044.

Operator

CHAMPLIN PETROLEUM COMPANY

DESIGNATE TYPE OF COMP.: OIL, GAS,
DRY HOLE, SWDW, ETC.:
Single Oil

Well No.

3

Lease Name

Davis Ranch "O"

S 36 T 34 R 15 W

WELL LOG

Show all important zones of porosity and contents thereof; cored intervals, and all drill-stem tests, including depth interval tested, cushion used, time tool open, flowing and shut-in pressures, and recoveries.

SHOW GEOLOGICAL MARKERS, LOGS RUN, OR OTHER DESCRIPTIVE INFORMATION.

FORMATION DESCRIPTION, CONTENTS, ETC.	TOP	BOTTOM	NAME	DEPTH
<u>LOGS</u>				
Densilog Neutron	2900	4910		
Acoustilog	2900	4913		
Dual Induction	1120	4912		
Red Bed & Sand	0	295		
Red Bed	295	580		
Red Bed & Sand	580	1206		
Sand & Shale	1206	1857		
Shale & Anhydrite	1857	2013		
Shale	2013	2228		
Lime & Shale	2228	4670		
Lime	4670	4775		
Lime & Shale	4775	4899		
Lime, Shale & Chert	4899	4915		
RTD		4915		

USE ADDITIONAL SHEETS, IF NECESSARY, TO COMPLETE WELL RECORD.

Date Received

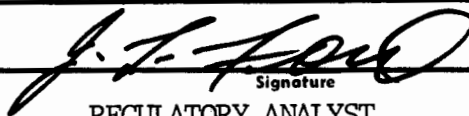
Signature

REGULATORY ANALYST

Title

December 19, 1980

Date

20-21-1980

P

KANSAS DRILLERS LOG

API No. 15-007-20,993

36-34-15W
State Geological Survey
WICHITA BRANCH
SW NW SW

COMPANY Champlin Petroleum Company

FARM Davis Ranch "Q" NO. 3

COUNTY Barber

ROTARY TOTAL DEPTH 4,915'
COMM. September 12, 1980 COMP. September 24, 1980
CONTRACTOR H-30, INC. (Rig #77)
ISSUED October 20, 1980

CASING

10 3/4" Set at 285' cemented w/225 sxs cement
8 5/8" Set at 1,115' cemented w/125 sxs cement
5 1/2" Set at 4,914' cemented w/200 sxs cement
4 1/2"

ELEVATION

FIGURES INDICATE BOTTOM OF FORMATIONS

Red Bed and Sand	295'
Red Bed	580'
Red Bed and Sand	1,206'
Sand and Shale	1,857'
Shale and Anhydrite	2,013'
Shale	2,228'
Lime and Shale	4,670'
Lime	4,775'
Lime and Shale	4,899'
Lime, Shale and Chert	4,915'
Rotary Total Depth	4,915'

I hereby certify the above and foregoing to be a true and correct log of the above described well as shown by the drilling reports.

H-30, INC.

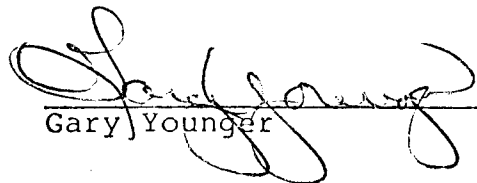
Gary Younger

State of Kansas)
) SS:
County of Sedgwick)

Subscribed and Sworn to before me a Notary Public in and for said county and state this 20th day of October, 1980.

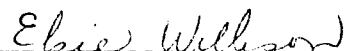
Elsie Willison - Notary Public

