

19-34-18W

KANSAS DRILLERS LOG

S. 19 T. 34 R. 18 ^E/_W

API No. 15 — 033 — 20,214
 County Number

Loc. C NE NE

County Comanche

Operator
The Maurice L. Brown Company & I. Wayne Woolsey

Address
1500 Vickers-KSB&T Building, Wichita, KS 67202

Well No. 1 Lease Name Huck

Footage Location
660 feet from (N) (S) line 660 feet from (E) (W) line

Principal Contractor Sage Drilling Company Geologist Toby Elster

Spud Date 11-16-76 Total Depth 6480 P.B.T.D.

Date Completed 12-8-76 Oil Purchaser

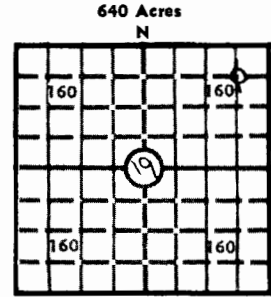

Locate well correctly
 Elev.: Gr. 1979

DF. KB 1990

CASING RECORD

Report of all strings set — surface, intermediate, production, etc.

Purpose of string	Size hole drilled	Size casing set (in O.D.)	Weight lbs/ft.	Setting depth	Type cement	Sacks	Type and percent additives
Surface	12 1/4	8 5/8	24	606	HLC Common	300 300	3%CC, 10#Gilsonite/sx 3% CC

LINER RECORD

PERFORATION RECORD

Top, ft.	Bottom, ft.	Sacks cement	Shots per ft.	Size & type	Depth interval

TUBING RECORD

Size	Setting depth	Packer set at

ACID, FRACTURE, SHOT, CEMENT SQUEEZE RECORD

Amount and kind of material used	Depth interval treated

INITIAL PRODUCTION

Date of first production	Producing method (flowing, pumping, gas lift, etc.)				
RATE OF PRODUCTION PER 24 HOURS	Oil	Gas	Water	Gas-oil ratio	
	bbls.	MCF	bbls.		CFPB
Disposition of gas (vented, used on lease or sold)			Producing interval (s)		

INSTRUCTIONS: As provided in KCC Rule 82-2-125, within 90 days after completion of a well, one completed copy of this Drillers Log shall be transmitted to the State Geological Survey of Kansas, 4150 Monroe Street, Wichita, Kansas 67209. Copies of this form are available from the Conservation Division, State Corporation Commission, 3830 So. Meridian (P.O. Box 17027), Wichita, Kansas 66217. Phone AC 316-522-2206. If confidential custody desired, please note Rule 82-2-125. Drillers Logs will be on open file in the Oil and Gas Division, State Geological Survey of Kansas, Lawrence, Kansas

19-34-18W

The Maurice L. Brown Company &
I. Wayne Woolsey

#1 Huck

19-34S-18W
C NE NE

Contr. Sage Drilling Company

Comanche County

Elev. 1990 KB

Comm. 11-16-76

Comp. 12-8-76

IP Dry Hole

Casing: 8 5/8 606/600 sxs

<u>Log Tops</u>	<u>Depth</u>	<u>Datum</u>
Stone Corral	975	+1015
Indian Cave	3401	-1411
Heebner	4394	-2404
Lansing	4609	-2619
Marmaton	5184	-3194
Cherokee	5282	-3292
Mississippian	5392	-3402
Viola	6212	-4222
Simpson	6434	-4444
Arbuckle	6612	-4622

DST #1 4505-4530'
45"-60" 45"-90"
Rec. 70' Mud
IFP 93-93#
ISIP 135#
FFP 93-93#
FSIP 125#

DST #5 6249-6309'
45"-60" 60"-60"
Rec. 10' Mud
IFP 62-62#
ISIP 83#
FFP 62-62#
FSIP 83#

DST #2 5020-5072'
45"-60" 45"-90"
Rec. 15' Mud
IFP 42-42#
ISIP 62#
FFP 42-42#
FSIP 62#

DST #6 6449-6480'
60"-60"-120"-90"
Rec. 5040' SW
IFP 207-1471#
ISIP 2463#
FFP 1481-2443#
FSIP 2463#

DST #3 5548-5641'
60"-60" 90"-120"
GTS/30", Ga 231 MCFPD,
decl. to 13 MCFPD, stab.,
Rec. 372' GCM, 2800' GCW
IFP 228-622#
ISIP 1989#
FFP 726-1140#
FSIP 2008#

DST #7 5460-5500' (Straddle)
45"-45"-45"-90"
Rec. 50' Mud
IFP 55-55#
ISIP 110#
FFP 55-55#
FSIP 110#

DST #4 6212-6249'
60"-60" 60"-120"
Rec. 50' Mud
IFP 42-42#
ISIP 208-291#
FFP 42-42#
FSIP 208-291#

DST #8 5398-5420' (Straddle)
60"-60"-60"-120"
Rec. 30' Mud
IFP 16-33#
ISIP 130#
FFP 33-33#
FSIP 162#