

19-34-19W

S. 19 T. 34 R. 19  $\frac{1}{2}$  W

API No. 15 — 033 — 20307 ✓  
 County Number

Loc. C NE NE

County Comanche

Operator  
 Lear Petroleum Exploration, Inc.

Address  
 2601 N. W. Expressway, Suite 1200, OKC. 73112

Well No. | Lease Name  
 | Lemon

Footage Location  
 660 feet from (N) ~~X~~ line 660 feet from (E) ~~X~~ line

Principal Contractor Geologist  
 Gabbert-Jones, Inc.

Spud Date Total Depth P.B.T.D.  
 9-4-79 5300 5250

Date Completed Oil Purchaser  
 9-30-79

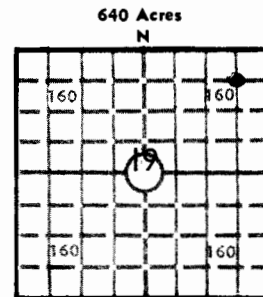

Locate well correctly  
 Elev.: Gr. 1773  
 DF 1775 KB 1778

**CASING RECORD**

Report of all strings set — surface, intermediate, production, etc.

Purpose of string	Size hole drilled	Size casing set (in O.D.)	Weight lbs/ft.	Setting depth	Type cement	Sacks	Type and percent additives
Surface	12 1/4"	8 5/8"	23	652'	Lite wt. Class "A"	275 200	3% cc 2% Gel/3%cc 18% salt
Production	7 7/8"	4 1/2"	10.5	5299'	50-50poz	250	3/4% cfr-2

**LINER RECORD**

**PERFORATION RECORD**

Top, ft.	Bottom, ft.	Sacks cement	Shots per ft.	Size & type	Depth interval
			1	Jet	5188-92
<b>TUBING RECORD</b>			1	Jet	5194-96
					5208-10
Size	Setting depth	Packer set at		Jet	5222-28
2 3/8	5093	5093		Jet	5234-40

**ACID, FRACTURE, SHOT, CEMENT SQUEEZE RECORD**

Amount and kind of material used	Depth interval treated
2000 Gal. 15% HCl Acid	5188-5240

**INITIAL PRODUCTION**

Date of first production SI WOPL Connection		Producing method (flowing, pumping, gas lift, etc.) Flowing			
RATE OF PRODUCTION PER 24 HOURS	Oil 0 bbls.	Gas 1064 MCF	Water 0 bbls.	Gas-oil ratio -	CFPB
Disposition of gas (vented, used on lease or sold) Sold - Rael Gas Company			Producing interval(s) Mississippi		

INSTRUCTIONS: As provided in KCC Rule 82-2-125, within 90 days after completion of a well, one completed copy of this Drillers Log shall be transmitted to the State Geological Survey of Kansas, 4150 Monroe Street, Wichita, Kansas 67209. Copies of this form are available from the Conservation Division, State Corporation Commission, 3830 So. Meridian (P.O. Box 17027), Wichita, Kansas 66217. Phone AC 316-522-2206. If confidential custody is desired, please note Rule 82-2-125. Drillers Logs will be on open file in the Oil and Gas Division, State Geological Survey of Kansas, Lawrence, Kansas 66044.

Operator  
Lear Petroleum Exploration, Inc.

DESIGNATE TYPE OF COMP.: OIL, GAS,  
DRY HOLE, SWDW, ETC.:

Well No. 1	Lease Name Lemon	Gas
S 19 T 34 R 19 W		

**WELL LOG**

Show all important zones of porosity and contents thereof; cored intervals, and all drill-stem tests, including depth interval tested, cushion used, time tool open, flowing and shut-in pressures, and recoveries.

SHOW GEOLOGICAL MARKERS, LOGS RUN, OR OTHER DESCRIPTIVE INFORMATION.

FORMATION DESCRIPTION, CONTENTS, ETC.	TOP	BOTTOM	NAME	DEPTH
Redbed - Sand	0	50	Heebner	4206
Redbed	50	310	Cherokee	5068
Redbed - Shale	310	805	Atoka	5177
Redbed	805	1265		
Shale - Lime	1265	2140	Miss. Det.	5186
Lime - Shale	2140	3480		
Shale - Lime	3480	3715	Miss. Lm.	5204
Lime - Shale	3715	4015		
Lime	4015	5300		

USE ADDITIONAL SHEETS, IF NECESSARY, TO COMPLETE WELL RECORD.

Date Received	<p><i>R. Stanley DeLong</i> Signature</p> <p>DIVISION ENGINEER Title</p> <p>March 25, 1980 Date</p>
---------------	---

10-30-100