

KANSAS

11-34-20W

WELL COMPLETION REPORT AND DRILLER'S LOG

S. 11 T. 34 R. 20 E W

API No. 15 — 033 — 20,363
County Number

Loc. C SW SW

County Comanche

Operator Inter North Inc.

Address P. O. Box 35288 Tulsa, Okla 74135

Well No. #2 Lease Name Girk II

Footage Location 660 feet from (S) line 660 feet from (W) line

Principal Contractor Rine Drilling Geologist

Spud Date 9/1/80 Date Completed 9/15/80 Total Depth 5300' P.B.T.D.

Directional Deviation Oil and/or Gas Purchaser Dry Hole

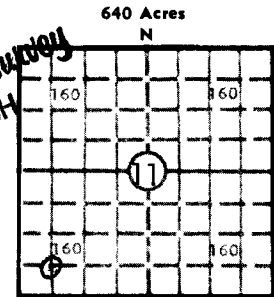

Elev.: Gr. 1772'

DF 1782' KB 1784'

CASING RECORD

Report of all strings set — surface, intermediate, production, etc.

Table with 8 columns: Purpose of string, Size hole drilled, Size casing set (in O.D.), Weight lbs/ft., Setting depth, Type cement, Sacks, Type and percent additives. Row 1: Surface, 12 1/4", 8-5/8", 24.00#, 608', Haliburton lite Class A, 250, 150.

LINER RECORD

PERFORATION RECORD

Tables for Liner Record and Perforation Record. Liner Record columns: Top, ft., Bottom, ft., Sacks cement. Perforation Record columns: Shots per ft., Size & type, Depth interval. Tubing Record columns: Size, Setting depth, Packer set at.

ACID, FRACTURE, SHOT, CEMENT SQUEEZE RECORD

Table with 2 columns: Amount and kind of material used, Depth interval treated.

INITIAL PRODUCTION

Date of first production None Producing method (flowing, pumping, gas lift, etc.)

RATE OF PRODUCTION PER 24 HOURS Oil bbls. Gas MCF Water bbls. Gas-oil ratio CFPB

Disposition of gas (vented, used on lease or sold) Producing interval (s)

INSTRUCTIONS: As provided in KCC Rule 82-2-125, within 90 days after completion of a well, one completed copy of this Drillers Log shall be transmitted to the State Geological Survey of Kansas, 4150 Monroe Street, Wichita, Kansas 67209.

Operator \_\_\_\_\_ DESIGNATE TYPE OF COMP.: OIL, GAS, DRY HOLE, SWDW, ETC.:

Well No. 2 Lease Name Girk 11 Dry

S 11 T 34S R 20<sup>W</sup>

**WELL LOG**  
 Show all important zones of porosity and contents thereof; cored intervals, and all drill-stem tests, including depth interval tested, cushion used, time tool open, flowing and shut-in pressures, and recoveries.  
 SHOW GEOLOGICAL MARKERS, LOGS RUN, OR OTHER DESCRIPTIVE INFORMATION.

FORMATION DESCRIPTION, CONTENTS, ETC.	TOP	BOTTOM	NAME	DEPTH
<p>Ran Compensated Neutron-Formation Density &amp; Dual Induction-Laterolog</p> <p>DST #1, 4744-70' (Misrun)            Open 30 mins, wk blw &amp; died, SI 60 mins            Open 15 mins plugged.</p> <p>DST #2, 4744-70'            Open 30 mins IF 239-239 psi            Closed 60 mins ISI 445 psi            Open 60 mins FF 239-239 psi            Closed 120 mins FSI 496 psi            Weak blow thru out tst. Rec 390' very sli O&amp;GCM.</p> <p>DST #3, 4752-84'            Open 60 mins IF 116-155 psi            Closed 120 mins ISI 406 psi            Open 120 mins FF 155-174 psi            Closed 4 hrs FSI 406 psi            Rec 120' very sli O&amp;GCM.</p>				

USE ADDITIONAL SHEETS, IF NECESSARY, TO COMPLETE WELL RECORD.

Date Received \_\_\_\_\_

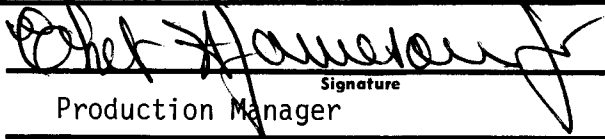
  
 Signature  
 Production Manager  
 Title  
 9/19/80  
 Date

20-500

11-34-20W

GIRK #2-11:

Contractor: RINE DRILLING COMPANY

Started: September 1, 1980

SW SW  
11 34S 20W  
Comanche County, Kansas

Completed: September 16, 1980

LOG

Surface	0 -	75'
Red Bed & Gypsum	75 -	275'
Red Bed	613 -	1500'
Red Bed & Anhydrite	1500 -	2270'
Dolomite	2270 -	2425'
Dolomite & Lime	2425 -	2577'
Lime	2577 -	2785'
Lime & Shale	2785 -	5300'

Ran 15 jts., 8 5/8" csg., set @ 608', cmt w/ 250 sx lt., 3% c.c. 1/2# flo, + 150 sx A, 2% gel, 3% c.c. 1/2# flo.  
TOTCO 1/2° @ 560'  
TOTCO 1° @ 2270'

TOTCO 3/4° @ 4770', 1° @ 5300'.  
Plugged and abandoned as follows:  
Through open end D.P.  
50 sx cmt @ 600'  
40 sx cmt @ 300'  
10 sx cmt. from 40' to -3'  
10 sx in RH  
10 sx in MH  
Job complete @ 8:00 PM 9/15/80  
Kansas State Plugger:  
Bill Owens  
Pratt, Kansas

STATE OF KANSAS: )  
                          ) ss:  
SEDGWICK COUNTY : )

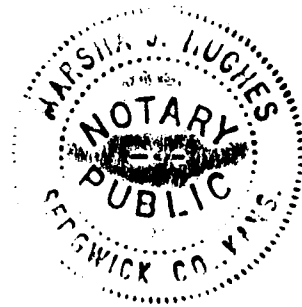

I, E.J. Rine, do hereby certify that the above is a true and accurate log of the GIRK #2-11, located SW SW 11 34S 20W, Comanche County, Kansas.

E.J. Rine  
E.J. Rine, President

Subscribed and sworn to before me this 17th day of September, 1980.

Marsha J. Hughes  
Marsha J. Hughes, Notary Public

My appointment expires: 6-20-84