

3-34s-21w

34

KANSAS DRILLERS LOG

State Geological Survey
WICHITA BRANCH

S. 3 T. 34S R. 21W **W**

API No. 15 — 025 — 20,325
County Number

JUL 3 0 REC'D

Loc. 200' N SE NE

County Clark

Operator
Texas Oil & Gas Corp.

Address
200 West Douglas, Suite 300, Wichita, Kansas 67202

Well No. #1 Lease Name Harper Ranch "B"

Footage Location
1780 feet from (N) (S) line 660 feet from (E) (W) line

Principal Contractor Xplor Drilling Co. Geologist N/A

Spud Date 10-13-79 Total Depth 5550' P.B.T.D. 5539'

Date Completed 11-17-79 Oil Purchaser Koch

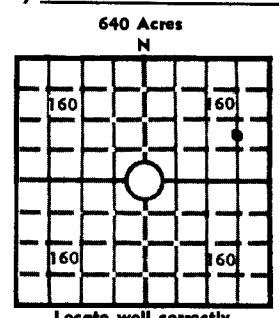

Elev.: Gr. 1889'

DF _____ KB 1897'

CASING RECORD

Report of all strings set — surface, intermediate, production, etc.

Purpose of string	Size hole drilled	Size casing set (in O.D.)	Weight lbs/ft.	Setting depth	Type cement	Sacks	Type and percent additives
Surface		8-5/8"	24#	546'		600	
Production		4-1/2	10.5#	5549'		150	

LINER RECORD

PERFORATION RECORD

Top, ft.	Bottom, ft.	Sacks cement	Shots per ft.	Size & type	Depth interval
N/A	N/A	N/A	2 JSPF	N/A	5444-52'

TUBING RECORD

Size	Setting depth	Packer set at
2-3/8"	5466'	N/A

ACID, FRACTURE, SHOT, CEMENT SQUEEZE RECORD

Amount and kind of material used	Depth interval treated
250 gals. acetic acid	5444-52'
Acidized w/450 gals. 15% HCl & 250 gals. 12% HCl & 3% HF	5444-52'
Frac w/1000 gals. 15% HCl + 6500 gals. 2% KCl wtr + 420,000 scf N ₂ + 22,500# sand	5444-52'
Acidized w/3000 gals. 3% HCl w/3 gals. aqua flow & 15 gals. WK-1	5444-52'

INITIAL PRODUCTION

Date of first production 12-1-79 Producing method (flowing, pumping, gas lift, etc.) pumping

RATE OF PRODUCTION PER 24 HOURS	Oil	Gas	Water	Gas-oil ratio
	3 bbls.	N/A MCF	6 bbls.	N/A CFPB

Disposition of gas (vented, used on lease or sold) N/A Producing interval (s) 5444-52'

INSTRUCTIONS: As provided in KCC Rule 82-2-125, within 90 days after completion of a well, one completed copy of this Drillers Log shall be transmitted to the State Geological Survey of Kansas, 4150 Monroe Street, Wichita, Kansas 67209. Copies of this form are available from the Conservation Division, State Corporation Commission, 3830 So. Meridian (P.O. Box 17027), Wichita, Kansas 66217. Phone AC 316-522-2206. If confidential custody is desired, please note Rule 82-2-125. Drillers Logs will be on open file in the Oil and Gas Division, State Geological Survey of Kansas, Lawrence, Kansas 66044.

Operator Texas Oil & Gas Corp. DESIGNATE TYPE OF COMP.: OIL, GAS, DRY HOLE, SWDW, ETC.:

Well No. #1 Lease Name Harper Ranch "B" Oil

S 3 T 32S R 21 E W

34 WELL LOG SHOW GEOLOGICAL MARKERS, LOGS RUN, OR OTHER DESCRIPTIVE INFORMATION. Show all important zones of porosity and contents thereof; cored intervals, and all drill-stem tests, including depth interval tested, cushion used, time tool open, flowing and shut-in pressures, and recoveries.

FORMATION DESCRIPTION, CONTENTS, ETC.	TOP	BOTTOM	NAME	DEPTH
Lansing	4533	-2636		
Swope	4996	-3099		
Hertha	5047	-3150		
B/Kansas City	5091	-3194		
Pawnee	5228	-3331		
Cherokee	5280	-3383		
Morrow	5398	-3501		
Mississippian	5502	-3605		
TD	5550			
PBTD	5539			
DST #1, 5443-54', (Morrow), w/results as follows: Mis-run.				
DST #2, 5447-58', (Morrow), w/results as follows: Mis-run.				
DST #3, 5488-5510', (Morrow), w/results as follows: Mis-run.				

USE ADDITIONAL SHEETS, IF NECESSARY, TO COMPLETE WELL RECORD.

Date Received _____ Signature Hal Brown
 HAL BROWN
 District Exploration Manager
 Title
 December 12, 1979
 Date