

KANSAS DRILLERS LOG

S. 19 T. 34 R. 27 ^N/_W
 Loc. 1250 FSL 1500 FWL
 County Meade

API No. 15 — 119 — 20,140
 County Number

Operator
The Headington Company

Address 801 First National Building
Oklahoma City, Oklahoma 73102

Well No. #1-19 Lease Name Baragree

Footage Location 1250 SL 1500 W.L.
 feet from (N) (S) line feet from (E) (W) line

Principal Contractor Zenith Drilling Co. Geologist Cranston W. Flesher

Spud Date 8-22-73 Total Depth 6280 P.B.T.D.

Date Completed 2-26-74 Oil Purchaser -

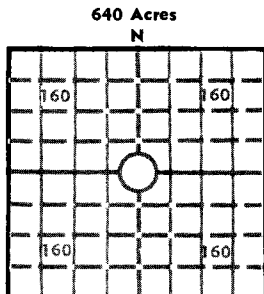

Locate well correctly
 Elev.: Gr. 2393
 DF 2402 KB

CASING RECORD

Report of all strings set — surface, intermediate, production, etc.

Purpose of string	Size hole drilled	Size casing set (in O.D.)	Weight lbs/ft.	Setting depth	Type cement	Sacks	Type and percent additives
Surface	12-1/4	8-5/8"	24#	1,307	Regular Posmix	150 450	3% cc 6% gel, 2% cc
Production	12-1/4"	4-1/2"	-	6,264	Regular	100	2% gel. 10% salt - gilsonit

LINER RECORD

PERFORATION RECORD

Top, ft.	Bottom, ft.	Sacks cement	Shots per ft.	Size & type	Depth interval

TUBING RECORD

Size	Setting depth	Packer set at
2-1/16"		

ACID, FRACTURE, SHOT, CEMENT SQUEEZE RECORD

Amount and kind of material used	Depth interval treated
Perforated Chester Formation - 20 holes from 6102-6112	

INITIAL PRODUCTION

Date of first production <u>Not on pipeline yet</u>	Producing method (flowing, pumping, gas lift, etc.) <u>Flowing</u>
RATE OF PRODUCTION PER 24 HOURS	Oil <u>12</u> bbls. Gas <u>971</u> MCF Water <u>-</u> bbls. Gas-oil ratio <u>57.3</u> CFPB
Disposition of gas (vented, used on lease or sold)	Producing interval (s) <u>6102-6112</u>

INSTRUCTIONS: As provided in KCC Rule 82-2-125, within 90 days after completion of a well, one completed copy of this Drillers Log shall be transmitted to the State Geological Survey of Kansas, 4150 Monroe Street, Wichita, Kansas 67209. Copies of this form are available from the Conservation Division, State Corporation Commission, 3830 So. Meridian (P.O. Box 17027), Wichita, Kansas 66217. Phone AC 316-522-2206. If confidential custody is desired, please note Rule 82-2-125. Drillers Logs will be on open file in the Oil and Gas Division, State Geological Survey of Kansas, Lawrence, Kansas 66044.

Operator		DESIGNATE TYPE OF COMP.: OIL, GAS, DRY HOLE, SWDW, ETC.:
Well No. 1-19	Lease Name Baragree	
S <u>19</u> T <u>34</u> R <u>27</u> W <u>E</u> W		

WELL LOG

Show all important zones of porosity and contents thereof; cored intervals, and all drill-stem tests, including depth interval tested, cushion used, time tool open, flowing and shut-in pressures, and recoveries.

SHOW GEOLOGICAL MARKERS, LOGS RUN, OR OTHER DESCRIPTIVE INFORMATION.

FORMATION DESCRIPTION, CONTENTS, ETC.	TOP	BOTTOM	NAME	DEPTH
Sand, Clay	0	105		
Sand, Red Bed	105	850		
Anhydrite	850	1980		
Anhydrite, Shale	1980	2450		
Shale, Lime	2450	5925		
Lime	5925	6280		

USE ADDITIONAL SHEETS, IF NECESSARY, TO COMPLETE WELL RECORD.

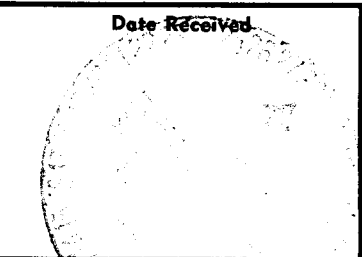

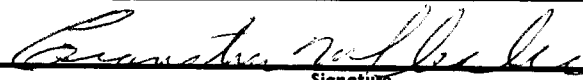

 Signature

 Engineer

 Title

 2-28-74

 Date