

KANSAS DRILLERS LOG

API No. 15 — 119 — 20,376
County Number

S. 27 T. 34 R. 27 ^{NE} _{SW}

Loc. C NW SE

County Meade

Operator
Mesa Petroleum Company

Address
50 Penn Place, Suite 1200 Oklahoma City, Okla 73118

Well No. #1-27 Lease Name Merkle

Footage Location
1980 feet from (N) (S) line 1980 feet from (E) (W) line

Principal Contractor Sage Drilling Geologist Don Huber

Spud Date 11-14-79 Total Depth 6177' P.B.T.D.

Date Completed 11-30-79 Oil Purchaser --

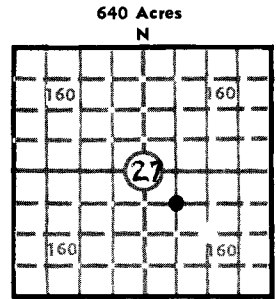

Locate well correctly
 Elev.: Gr. 2201

DF 2209 KB 2212

CASING RECORD

Report of all strings set — surface, intermediate, production, etc.

Purpose of string	Size hole drilled	Size casing set (in O.D.)	Weight lbs./ft.	Setting depth	Type cement	Sacks	Type and percent additives
Surface	12 1/4	8 5/8	24	714	Poz	500	2% CaCl

LINER RECORD

PERFORATION RECORD

Top, ft.	Bottom, ft.	Sacks cement	Shots per ft.	Size & type	Depth interval

TUBING RECORD

Size	Setting depth	Packer set at

ACID, FRACTURE, SHOT, CEMENT SQUEEZE RECORD

Amount and kind of material used	Depth interval treated

INITIAL PRODUCTION

Date of first production		Producing method (flowing, pumping, gas lift, etc.)			
RATE OF PRODUCTION PER 24 HOURS	Oil	Gas	Water	Gas-oil ratio	CFPB
	bbls.	MCF	bbls.		
Disposition of gas (vented, used on lease or sold)			Producing interval (s)		

INSTRUCTIONS: As provided in KCC Rule 82-2-125, within 90 days after completion of a well, one completed copy of this Drillers Log shall be transmitted to the State Geological Survey of Kansas, 4150 Monroe Street, Wichita, Kansas 67209. Copies of this form are available from the Conservation Division, State Corporation Commission, 3830 So. Meridian (P.O. Box 17027), Wichita, Kansas 66217. Phone AC 316-522-2206. If confidential custody is desired, please note Rule 82-2-125. Drillers Logs will be on open file in the Oil and Gas Division, State Geological Survey of Kansas, Lawrence, Kansas 66044.