

IMPORTANT
Kans. Geo. Survey request
samples on this well.

15-175-20415

SEP

KANSAS DRILLERS LOG

RECEIVED
AMARILLO PRODUCTION

S. 3 T. 34 R. 31 W
Loc. C NE SW

County Seward

API No. 15 — 175 — 20,415
County Number

Operator

Mesa Petroleum Company

AUG 13 1979

Address

P. O. Box 2009 Amarillo, Texas 79189

Well No. #1-3

Lease Name
Platt

Footage Location

1980 feet from (N) (S) line 1980

feet from (E) (W) line

Principal Contractor

Sage Drilling Co.

Geologist

Don Huber

Spud Date

8-14-79

Total Depth

6000

P.B.T.D.

5935

Date Completed

9-4-79

Oil Purchaser

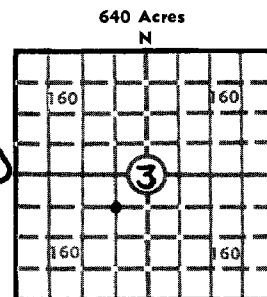

Elev.: Gr.

DF 2678 KB 2680

CASING RECORD

Report of all strings set— surface, intermediate, production, etc.

Purpose of string	Size hole drilled	Size casing set (in O.D.)	Weight lbs/ft.	Setting depth	Type cement	Sacks	Type and percent additives
Surface	12 1/4	8 5/8	24	1490	H	800	2% CaCl
Production	7 7/8	4 1/2	10.5	6000	50:50 Poz	250	12 1/2% gils. 18% Salt

LINER RECORD

PERFORATION RECORD

Top, ft.	Bottom, ft.	Sacks cement	Shots per ft.	Size & type	Depth interval
			1	.38" jet	35' net
TUBING RECORD					5756-5904
Size	Setting depth	Packer set at			
2 3/8	5723	5724			

ACID, FRACTURE, SHOT, CEMENT SQUEEZE RECORD

Amount and kind of material used	Depth interval treated
3500 gal 15% NE acid	5756-5904

INITIAL PRODUCTION

Date of first production 9-1-79		Producing method (flowing, pumping, gas lift, etc.) Flowing			
RATE OF PRODUCTION PER 24 HOURS		Oil tr bbls.	Gas 510 MCF	Water bbls.	Gas-oil ratio CFPB
Disposition of gas (vented, used on lease or sold) Vented				Producing interval (s) 5756-5904	

INSTRUCTIONS: As provided in KCC Rule 82-2-125, within 90 days after completion of a well, one completed copy of this Drillers Log shall be transmitted to the State Geological Survey of Kansas, 4150 Monroe Street, Wichita, Kansas 67209. Copies of this form are available from the Conservation Division, State Corporation Commission, 3830 So. Meridian (P.O. Box 17027), Wichita, Kansas 66217. Phone AC 316-522-2206. If confidential custody is desired, please note Rule 82-2-125. Drillers Logs will be on open file in the Oil and Gas Division, State Geological Survey of Kansas, Lawrence, Kansas 66044.

Operator MESA PETROLEUM CO.		DESIGNATE TYPE OF COMP.: OIL, GAS, DRY HOLE, SWDW, ETC.:	
Well No. 1-3	Lease Name Platt	Gas	
S <u>3</u> T <u>34S</u> R <u>31</u> ^{EX} _W			
WELL LOG		SHOW GEOLOGICAL MARKERS, LOGS RUN, OR OTHER DESCRIPTIVE INFORMATION.	
Show all important zones of porosity and contents thereof; cored intervals, and all drill-stem tests, including depth interval tested, cushion used, time tool open, flowing and shut-in pressures, and recoveries.			
FORMATION DESCRIPTION, CONTENTS, ETC.	TOP	BOTTOM	NAME
DST #1 5650-5756 IH, FH: 2704, 2720 IF, FF: 145-113, 97-113 ISI, FSI: 692, 789 Rec. 155' DM DST #2 5760-5830 IH, FH: 2680, 2615 IF, FF: 25-36, 20-33 ISI, FSI: 1824, 1800 Rec. 90' gas cut mud & 120' gas & oil cut mud			NAME Council Grove 2914 Toronto 4310 Marmaton 5115 Morrow 5637 Chester 5746
USE ADDITIONAL SHEETS, IF NECESSARY, TO COMPLETE WELL RECORD.			
Date Received	<div style="margin-bottom: 5px;">  Signature </div> <div style="margin-bottom: 5px;"> Staff Engineer Title </div> <div style="margin-bottom: 5px;"> October 2, 1979 Date </div>		