

ANSAS

State Geological Survey
"Tight Hat"
WICHITA BRANCH

CONFIDENTIAL

6-1-81

WELL COMPLETION REPORT AND
DRILLER'S LOG

API No. 15 — 175 — 20,527
County Number

16-34S-32W

S. 16 T. 36S R. 32W E PL
Loc. 660' FEL & 825' FSL
County Seward

Operator
Quinque Oil & Gas Producing Co.

DEC 29 1981

Address
18 West Third St., Liberal, KS 67901

Well No. 1-16 Lease Name Big E

Footage Location
825 feet from (N) (S) line 660 feet from (E) (W) line

Principal Contractor Zenith Drlg. Corporation Geologist W. R. Atkinson

Spud Date 3-23-81 Date Completed 4-27-81 Total Depth 6545 P.B.T.D. 5855'

Directional Deviation Oil end/or Gas Purchaser Panhandle Eastern PL Co. -Gas

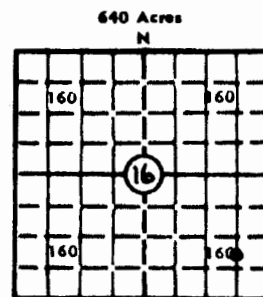

Locate well correctly
Elev.: Gr. 2770
DF 2778' KB 2781'

CASING RECORD

Report of all strings set — surface, intermediate, production, etc.

Purpose of string	Size hole drilled	Size casing set (in O.D.)	Weight lbs./ft.	Setting depth	Type cement	Sacks	Type and percent additives
Surface	12 1/4	8 5/8	24#	1532'	lite & class H	850	2% & 3% cc
Production	7 7/8	4 1/2	11.6#	6035'	RFC	385	12 1/2# Kolite

RECEIVED
STATE CORPORATION COMMISSION
AUG 12 1982

LINER RECORD

PERFORATION RECORD

Top, ft.	Bottom, ft.	Sacks cement	Shots per ft.	Size & W.P.	Depth interval
			2 spf	.38	5830-34'

CONSERVATION DIVISION
Wichita, Kansas

ACID, FRACTURE, SHOT, CEMENT SQUEEZE RECORD

Amount and kind of material used	Depth interval treated
400 gals. 7 1/2% NE acid using 8 ball sealers	5830-34'

INITIAL PRODUCTION

RECEIVED
STATE CORPORATION COMMISSION

Date of first production W. O. Pipeline 8-13-81	Producing method (flowing, pumping, gas lift, etc.) flowing
RATE OF PRODUCTION PER 24 HOURS Oil - Gas 600 MCF	Water - Gas-oil ratio - bbls. CFPB
Disposition of gas (vented, used on lease or sold) To be sold - Panhandle Eastern PL Co.	Producing interval (s) Morrow

MAY 21 1981

CONSERVATION DIVISION
Wichita, Kansas

INSTRUCTIONS: As provided in KCC Rule 82-2-125, within 90 days after completion of a well, one completed copy of this Drillers Log shall be transmitted to the State Geological Survey of Kansas, 4150 Monroe Street, Wichita, Kansas 67209. Copies of this form are available from the Conservation Division, State Corporation Commission, 245 No. Water, Wichita, Kansas 67202. Phone AC 316-522-2206. If confidential custody is desired, please note Rule 82-2-125. Drillers Logs will be on open file in the Oil and Gas Division, State Geological Survey of Kansas, Lawrence, Kansas 66044.

Operator Quinque Oil & Gas Producing Company		DESIGNATE TYPE OF COMP.: OIL, GAS, DRY HOLE, SWDW, ETC.: Gas
Well No. 1-16	Lease Name Big E	
S 16 T 34S R 32W E W		

WELL LOG

Show all important zones of porosity and contents thereof; cored intervals, and all drill-stem tests, including depth interval tested, cushion used, time tool open, flowing and shut-in pressures, and recoveries.

SHOW GEOLOGICAL MARKERS, LOGS RUN, OR OTHER DESCRIPTIVE INFORMATION.

FORMATION DESCRIPTION, CONTENTS, ETC.	TOP	BOTTOM	NAME	DEPTH
Surface Sand	0	330	Toronto	4382
Sand & Red Bed	330	1220	Lansing	4520
Red Bed	1220	2100	Kansas City	4820
Lime & Shale	2100	6545	Hodges	5014
			Kansas City B	5115
			Marmaton	5196
			Cherokee	5402
			Morrow Shale	5776
			L. Morrow Snd	5776
			Chester	6020
			St. Gen.	6370
			St. Louis	6486

DST #1 5762-5875' 30-30-30-60

IH 2983#
IFP 860-893#
ISIP 1132#
FFP 896-946#
FSIP 1128#
FH 2983#

Recovered 180' gas cut mud

USE ADDITIONAL SHEETS, IF NECESSARY, TO COMPLETE WELL RECORD.

Date Received	 Signature
	Janice Heckman, Coordinator Title
	May 19, 1981 August 10, 1982 Date