

21-34-33W

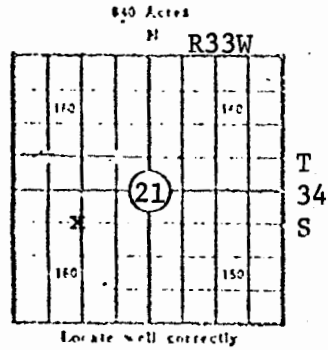

Lease Name: Bruns "A" Well No. 3
 Well Located: 1980' FSL, 1345' FWL of SW/4
SEC 21 TWP 34S RGE 33W
 Operator: Cities Service Oil Company
 Address: 3545 N. W. 58th Street, Okla. City, Okla. 73112
 Elevation: Ground 2839' D.F. 2847' K.B. 2848'
 Type Well: (Oil, gas, dry hole) Dry Hole

Drilling Commenced: 4-25 1976 Drilling Completed: 5-12 1976
 Well Completed: 5-12 1976 Total Depth 6500'
 Initial Production: Dry Hole

Casing Record

Size: 8-5/8" Set at 1569' Size: ---- Set at ----
 Size: ---- Set at ---- Size: ---- Set at ----

Liner Record

Size: ----- Set from ----- To -----

Cementing

Casing Size	Sacks	Type Cement and Additives
<u>8-5/8"</u>	<u>900</u>	<u>Cemented w/700 sx Howco Lite w/2% CaCl followed by 200 sx Class H w/3% CaCl. Cement circulated to surface.</u>
<u>-----</u>	<u>-----</u>	<u>-----</u>
<u>-----</u>	<u>-----</u>	<u>-----</u>

Perforations

Formation	Perforated Interval and Number Shots
<u>N/A</u>	<u>----</u>
<u>-----</u>	<u>-----</u>
<u>-----</u>	<u>-----</u>
<u>-----</u>	<u>-----</u>



Electric Log Run. (Show type log and depths covered)

Ran Dresser Atlas Dual Induction Focused Log Comp. Formation Density w/Neutron, GR & Caliper from 1569' Loggers T.D. to 6496'.

Show Drill Stem Tests,
Well Stimulation and
Production Tests

Formation Top Bottom

21-34-33w

Sand & Clay	0	500
Glorietta Sand	500	1210
Red Bed & Shale	1210	1553
Anhydrite	1553	1576
Shale	1576	3620
Lime	3620	3678
Shale	3678	4115
Shale & Lime	4115	4845
Lime	4845	6260
Lime & Shale	6260	6359
Lime	6359	6500
T.D.		6500

DST #1 Lower Morrow 6050-68'
DST #2 Lower Morrow 6005-95'
DST #2A Lower Morrow 6025-99'

21-34-33w