

**KANSAS DRILLERS LOG**

S. 32 T. 34 R. 34 <sup>W</sup>

API No. 15 — 175 — 20,385  
County Number

Loc. C SE SW

Operator  
Kennedy & Mitchell, Inc.

County Seward

Address  
Box 1578 Liberal, Kansas 67901

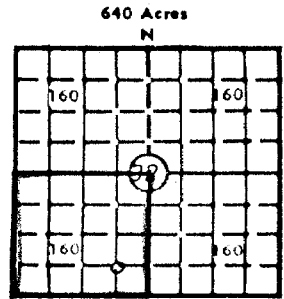

Well No. #23-357 Lease Name Dowdy

Footage Location  
660 feet from ~~XX~~ (S) line 1980 feet from ~~XX~~ (W) line

Principal Contractor DaMac Drilling Company Geologist  
 Spud Date 3-14-79 Total Depth 6700 P.B.T.D. 6568

Date Completed 10-12-79 Oil Purchaser UPG

Elev.: Gr. 2934  
 DF 2942 KB 2944

**CASING RECORD**

Report of all strings set — surface, intermediate, production, etc.

Purpose of string	Size hole drilled	Size casing set (in O.D.)	Weight lbs/ft.	Setting depth	Type cement	Sacks	Type and percent additives
surface	12 1/4"	8 5/8"	24#	1455'	Halco lite Class H	600 150	2%cc 3%cc
production	7 7/8"	4 1/2"	10.5#	6623'	1st: class H 50/50poz 2nd: class H	50 150 50	8%gel, 12 1/2#gilsonite salt 18% salt, 12 1/2#gilsonite .75%CFR-2 8%gel, 12 1/2#gilsonite salt

**LINER RECORD**

50/50poz 200 18% salt, 12 1/2#gilsonite .75%CFR-2  
**PERFORATION RECORD**

Top, ft.	Bottom, ft.	Sacks cement	Shots per ft.	Size & type	Depth interval
			2	3 1/8" gun, DP	6469-6474'
<b>TUBING RECORD</b>					
Size	Setting depth	Pecker set at			
2 3/8"	6455'	6455'	2	3 1/8" gun, DP	2722-2734' 2646-2652'

**ACID, FRACTURE, SHOT, CEMENT SQUEEZE RECORD**

Amount and kind of material used	Depth interval treated
500 gal Musol	
13,000 gal gelled diesel + 8,000# 20/40 frac sand	6469-6474'
1000 gal 15% Non-E acid + 1000 gal carbon dioxide.....	2722-2734'
1000 gal 15% Non-E acid + 1000 gal carbon dioxide.....	2646-2652'
20,000 gal gelled 3% acid, 10,000 gal carbon dioxide + 24,000# of 20/40 frac sand	2722-2734' & 2646-2652'

**INITIAL PRODUCTION**

Date of first production <u>10-21-79</u>	Producing method (flowing, pumping, gas lift, etc.) <u>pumping</u>
RATE OF PRODUCTION PER 24 HOURS	Oil <u>11</u> bbls. Gas <u>0</u> MCF Water <u>6</u> bbls. Gas-oil ratio <u>--</u> CFPB
Disposition of gas (vented, used on lease or sold)	Producing interval (s) <u>6469-6474' Morrow</u>

KENNEDY & MITCHELL, INC.  
 BBX 1578, LIBERAL, KS. 67901  
 CONTR DA MAC DRILLING CO. CTY SEWARD  
 FIELD WIDE AWAKE

copy of this Drillers Log shall be trans-  
 form are available from the Conservation  
 C 316-522-2206. If confidential custody  
 just Survey of Kansas, Lawrence, Kansas

C-10-1972

2944 KB CM 3/14/79 CARD ISSUED 1/10/80 IP F 11 BO & 6 BWPD  
 API 15-175-20,385 MRW 6469-74

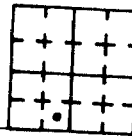

LOG TOPS	DEPTH	DATUM
NO TOPS RELEASED		
PBTD	6568	-3624
RTD	6700	-3756

8-5/8" 1455/800sx, 4 1/2" 6623/400sx  
 NO DST'S REPORTED  
 MICT - CO, PF (MRW) 10/6469-74, AC  
 500 MUSOL, FRAC 13,000 G GEL DIESEL &  
 8000#SD, TST GSO, PF 24/2722-34, AC  
 1000 (15%) & 1000 G CARBON DIOXIDE,  
 TSTD NS, PF 12/2646-52, AC 1000 (15%)  
 & 1000 G CARBON DIOXIDE, TST NS, FRAC  
 20,000 G GEL 3% AC & 10,000 G CARBON  
 DIOXIDE & 24,000#SD, TST NS, SI F 11  
 BO & 6 BWPD, NSG

Operator <b>Kennedy &amp; Mitchell, Inc.</b>		DESIGNATE TYPE OF COM. DRY HOLE, SWDW, ETC.: <i>Oil</i>
Well No. <i>23-357</i>	Lease Name <i>Dowdy</i>	
S <u>32</u> T <u>34S</u> R <u>34</u> <sup>EX</sup> W		

**WELL LOG**

Show all important zones of porosity and contents thereof; cored intervals, and all drill-stem tests, including depth interval tested, cushion used, time tool open, flowing and shut-in pressures, and recoveries.

SHOW GEOLOGICAL MARKERS, LOGS RUN, OR OTHER DESCRIPTIVE INFORMATION.

FORMATION DESCRIPTION, CONTENTS, ETC.	TOP	BOTTOM	NAME	DEPTH
<i>Sand, Red Bed</i>	<i>0</i>	<i>600</i>		
<i>Sand, Red Bed, Anhydrite</i>	<i>600</i>	<i>1437</i>		
<i>Anhydrite, Shale</i>	<i>1437</i>	<i>2390</i>		
<i>Shale</i>	<i>2390</i>	<i>2749</i>		
<i>Lime, Shale</i>	<i>2749</i>	<i>3545</i>		
<i>Lime, Shale, Dolomite</i>	<i>3545</i>	<i>3758</i>		
<i>Dolomite</i>	<i>3758</i>	<i>4110</i>		
<i>Lime, Shale</i>	<i>4110</i>	<i>6322</i>		
<i>Lime</i>	<i>6322</i>	<i>6380</i>		
<i>Lime, Shale</i>	<i>6380</i>	<i>6700RTD</i>		

USE ADDITIONAL SHEETS, IF NECESSARY, TO COMPLETE WELL RECORD.

Date Received	<i>Neil E. Lowery</i> Signature
	<i>Agent, Kennedy &amp; Mitchell, Inc.</i> Title
	<i>November 7, 1979</i> Date

**PLAT AND CERTIFICATION OF ACREAGE ATTRIBUTABLE TO A GAS WELL**

State Corporation Commission, Conservation Division

P. O. Box 17027 Wichita, Kansas 67217

OPERATOR Kennedy & Mitchell, Inc.

LOCATION OF WELL

LEASE Dowdy

660 feet from the south line  
1980 feet from the west line  
Of the SW/4 of Sec. 32 T. 34S R. 34W

WELL NUMBER 23-357

FIELD \_\_\_\_\_

COUNTY Seward

ORDER GRANTING ALLOWABLE ENTERED IN DOCKET NO. \_\_\_\_\_

NUMBER OF ACRES  
ATTRIBUTABLE TO WELL 160

DESCRIPTION OF ACREAGE:

PLAT

(Show location of Well and outline attributable acreage)

