

**KANSAS DRILLERS LOG**

API No. 15 — 175 — 20,560  
 County Number

S. 32 T. 34S R. 34 <sup>XX</sup>W

Loc. C NW NW SW NE

County Seward

Operator  
 Tucker Production Corporation

Address  
 2546 West Main, Littleton, CO 80120

Well No. 1 Lease Name Engel

Footage Location  
1485 feet from (N) ~~XX~~ line 2475 feet from (E) ~~XX~~ line

Principal Contractor NRG Drilling Geologist Don Huber

Spud Date 8-20-81 Total Depth 6740' P.B.T.D.

Date Completed D&A 9-3-81 Oil Purchaser

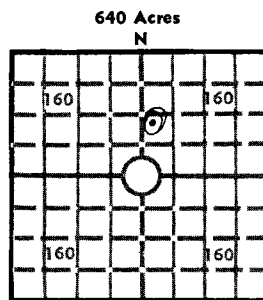

Elev.: Gr. 2935'

DF 2945' KB 2946'

**CASING RECORD**

Report of all strings set — surface, intermediate, production, etc.

Purpose of string	Size hole drilled	Size casing set (in O.D.)	Weight lbs/ft.	Setting depth	Type cement	Sacks	Type and percent additives
Surface	12-1/4"	8-5/8"	23#	1753	HLC Class H	700 150	2% CaCl; 1/4# F. 3% CaCl

**LINER RECORD**

**PERFORATION RECORD**

Top, ft.	Bottom, ft.	Sacks cement	Shots per ft.	Size & type	Depth interval

**TUBING RECORD**

Size	Setting depth	Packer set at

**ACID, FRACTURE, SHOT, CEMENT SQUEEZE RECORD**

Amount and kind of material used	Depth interval treated

**INITIAL PRODUCTION**

Date of first production		Producing method (flowing, pumping, gas lift, etc.)			
RATE OF PRODUCTION PER 24 HOURS	Oil	Gas	Water	Gas-oil ratio	
	bbls.	MCF	bbls.	CFPB	
Disposition of gas (vented, used on lease or sold)			Producing interval (s)		

INSTRUCTIONS: As provided in KCC Rule 82-2-125, within 90 days after completion of a well, one completed copy of this Drillers Log shall be transmitted to the State Geological Survey of Kansas, 4150 Monroe Street, Wichita, Kansas 67209. Copies of this form are available from the Conservation Division, State Corporation Commission, 3830 So. Meridian (P.O. Box 17027), Wichita, Kansas 66217. Phone AC 316-522-2206. If confidential custody is desired, please note Rule 82-2-125. Drillers Logs will be on open file in the Oil and Gas Division, State Geological Survey of Kansas, Lawrence, Kansas 66044.

Operator Tucker Production Corporation  
 DESIGNATE TYPE OF COMP.: OIL, GAS, DRY HOLE, SWDW, ETC.:  
 Dry Hole

Well No. 1 Lease Name Engel

S 32 T 34S R 34 <sup>KX</sup> W

**WELL LOG**  
 Show all important zones of porosity and contents thereof; cored intervals, and all drill-stem tests, including depth interval tested, cushion used, time tool open, flowing and shut-in pressures, and recoveries.  
 SHOW GEOLOGICAL MARKERS, LOGS RUN, OR OTHER DESCRIPTIVE INFORMATION.

FORMATION DESCRIPTION, CONTENTS, ETC.	TOP	BOTTOM	NAME	DEPTH
DST #1 (L. Morrow) 6152-6180'; 30, 60, 60, 120 min.; tool open w/ wk blo, dead after 20 min., rec. 15' drlg. mud. IHP 2938#; IFP 20-43#; ISIP 162#; FFP 38# - 51#; FSIP 138#; FH 2926#.			C. Grove	2968 (- 22)
			Heebner	4308 (- 1362)
			Toronto	4327 (- 1381)
			Lansing	4440 (- 1494)
			Marm.	5262 (- 2316)
			Morrow	5840 (- 2894)
DST #2 (St. Louis) 6690-6740'; 30, 60, 90, 120 min; gd blo on both op; rec. 60' sli GC & MCSW and 2055' sli GCSW. IHP 3375#; IFP 234-728; ISIP 1641#; FFP 761-1183#; FSIP 1706#.			L. Mor. Sd	6138 (- 3192)
			Ches.	6169 (- 3223)
			Ches. Sd	6478 (- 3532)
			St. Gen	6510 (- 3564)
			St. Louis	6566 (- 3620)
DST #3 (Toronto) 4330-4380'; misrun				
DST #4 (Toronto) 4334-80'; 15, 60, 60, 120 min.; tool op on 1st op w/ wk blo, sli inc., had wk blo, sli inc. on 2nd op; NGTS; rec. 240' DM & 267' SW; IH 2212; IFP 34-134#; ISIP 1117#; FFP 103-264#; FSIP 1114#; FH 2196#.				

USE ADDITIONAL SHEETS, IF NECESSARY, TO COMPLETE WELL RECORD.

Date Received \_\_\_\_\_  
 \_\_\_\_\_  
 Signature Reed A. Wacker  
 Engineer  
 Title  
 September 11, 1981  
 Date

DRILLERS LOG

TUCKER PRODUCTION CORPORATION  
 2546 W. Main  
 Littleton, Colorado 80120

TOTAL DEPTH: 6740

Engel #1  
 C-NW NW SW NE of Sec.32-34-34W  
 Seward County, Kansas

SURFACE CASING: Drilled 1774'  
 of 12 $\frac{1}{4}$ " hole. Ran 46 joints new  
 23# 8-5/8" surface casing 1774.22'  
 OA, set @ 1753' KB. Cemented with  
 700 sks. lite, 2% CC,  $\frac{1}{4}$ # flocele,  
 150 sks. class H 3%CC. Plug down

Commenced: August 21, 1981  
 Completed: September 3, 1981

FORMATION	FROM	TO	REMARKS
Surface sand, lime	0'	817'	RTD 6740'
Red bed	817	818	
Lime	818	1424	LTD 6731'
Red bed	1424	1754	
Lime	1754	2476	
Lime, shale	2476	6740	
RTD		6740	

I certify that this is a true and correct copy of the log on the above captioned well to the best of my knowledge.

NRG Drilling, Inc.

By Elmer Jack Taylor  
 Elmer Jack Taylor

Subscribed and sworn before me this 8th day of September, 19 81

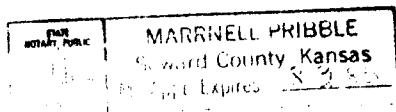

Marrnell Pribble  
 Notary Public Marrnell Pribble

My commission expires: 8-3-83