

25-34-36W

**IMPORTANT**  
 Kans. Geo. Survey request samples on this well.

S. 25 T. 34 R. 36 <sup>EX</sup> W

Loc. C SW SE  
 County Stevens

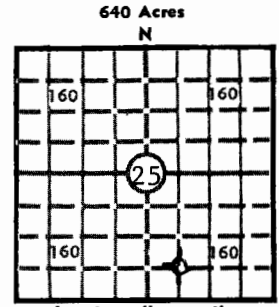

640 Acres  
 Locate well correctly  
 Elev.: Gr. 3026'  
 DF 3035' KB 3036'

**KANSAS DRILLERS LOG**

API No. 15 — 189 — 20,201  
 County Number State Geological Survey

Operator Graham-Michaelis Corporation **WICHITA BRANCH**

Address Box 247  
Wichita, Kansas

Well No. #1-25 Lease Name Stalcup

Footage Location  
660 feet from (N) (S) line 1980 feet from (E) (W) line

Principal Contractor Rains & Williamson Oil Co. Geologist Robert G. Brooks

Spud Date Aug. 15, 1973 Total Depth 6560 P.B.T.D.

Date Completed Aug. 31, 1973 Oil Purchaser None

**CASING RECORD**

Report of all strings set — surface, intermediate, production, etc.

Purpose of string	Size hole drilled	Size casing set (in O.D.)	Weight lbs/ft.	Setting depth	Type cement	Sacks	Type and percent additives
To protect shallow water zone	12 1/4"	8 5/8"	28#	1731'	600 sx li wt 200 sx common	800	600 sx w/2% cc 200 sx w/3% cc

**LINER RECORD**

**PERFORATION RECORD**

Top, ft.	Bottom, ft.	Sacks cement	Shots per ft.	Size & type	Depth interval
None			None		

Size	Setting depth	Packer set at
None		

**ACID, FRACTURE, SHOT, CEMENT SQUEEZE RECORD**

Amount and kind of material used	Depth interval treated
None	

**INITIAL PRODUCTION**

Date of first production	Producing method (flowing, pumping, gas lift, etc.)
None	None
RATE OF PRODUCTION PER 24 HOURS	Gas-oil ratio
Oil bbls.	Water MCF bbls.
Gas bbls.	CFPB
Disposition of gas (vented, used on lease or sold)	Producing interval (s)
	Dry & Abandoned

INSTRUCTIONS: As provided in KCC Rule 82-2-125, within 90 days after completion of a well, one completed copy of this Drillers Log shall be transmitted to the State Geological Survey of Kansas, 4150 Monroe Street, Wichita, Kansas 67209. Copies of this form are available from the Conservation Division, State Corporation Commission, 3830 So. Meridian (P.O. Box 17027), Wichita, Kansas 66217. Phone AC 316-522-2206. If confidential custody is desired, please note Rule 82-2-125. Drillers Logs will be on open file in the Oil and Gas Division, State Geological Survey of Kansas, Lawrence, Kansas 66044.

Operator **Graham-Michaelis Corporation**  
 Well No. **1-25** Lease Name **Stalcup**  
 S 25 T 34 R 36 <sup>E</sup>/<sub>W</sub> **Dry Hole**  
 DESIGNATE TYPE OF COMP.: OIL, GAS, DRY HOLE, SWDW, ETC.:

**WELL LOG**

Show all important zones of porosity and contents thereof; cored intervals, and all drill-stem tests, including depth interval tested, cushion used, time tool open, flowing and shut-in pressures, and recoveries.

SHOW GEOLOGICAL MARKERS, LOGS RUN, OR OTHER DESCRIPTIVE INFORMATION.

FORMATION DESCRIPTION, CONTENTS, ETC.	TOP	BOTTOM	NAME	DEPTH
Sand	0	440	Dresser Atlas	4100-6558'
Sand, Red Bed & Gyp Sand	440	1128	Densilog	
Sand & Red Bed	1128	1715		
Red Bed & Gyp	1715	1907	Dresser Atlas	1731-6558'
Red Bed Red	1907	2410	Dual Induction	
Red Bed & Anhydrite	2410	2464	Focused Log	
Shale & Lime	2464	2730		
Lime & Shale	2730	2895		
Shale & Lime	2895	3037		
Lime & Shale	3037	3205		
Shale & Lime	3205	3508	DRILL STEM TEST	6245-88
Lime & Shale	3508	3978	Open 60"	
Lime	3978	4585	Recovered 800'	gas in pipe
Lime & Shale	4585	4770	60'	sli. gas cut mud
Lime	4770	5284		no water.
Lime & Shale	5284	5502	ISIP: 581#	
Lime	5502	5903	FP: (48-96#)	
Lime & Shale	5903	6024	FSIP: 293#	
Shale	6024	6288		
Shale & Lime	6288	6390		
Lime & Shale	6390	6472		
Lime	6472	6560	DRILL STEM TEST	6478-6560
Rotary Total Depth	6560'		Open 60"	
			Recovered 360'	gas in pipe
			80'	mud w/spots oil
			ISIP: 1934#	
			FP: (60-70)	
			FSIP: 847#	

LOG	TOPS	DEPTH	DATUM
HEEB		4284	-1248
TOP		4324	-1288
LKC		4444	-1408
MRM		5207	-2171
MRW SH		5920	-2884
L" SD MKR		6237	-3201
CHEST SD		6498	-3462
RTD		6560	-3524

8 5/8" 1731/800sx  
 DST(1) 6243-88 FAILED  
 DST(2) 6245-88/10-45-60-45, 800' GIP,  
 60' SGCM, BHP 581-293#, FP 48-96# &  
 48-108#  
 DST(3) 6478-6560/10-45-60-45, 360' GIP,  
 80' M W/SP OIL, BHP 1934-847#, FP 24-  
 60# & 60-70#

USE ADDITIONAL SHEETS, IF NECESSARY, TO COMPLETE WELL RECORD.

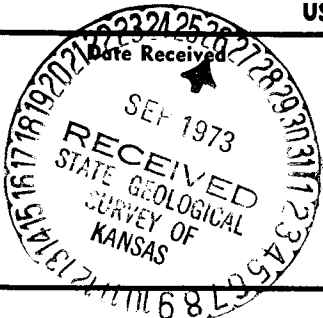

*Muriel F. C. Jeram*  
 Signature  
 Geological Secretary  
 Title  
 September 12, 1973  
 Date