

7-34-41W  
State Geological Survey

WELL COMPLETION REPORT AND  
DRILLER'S LOG

API No. 15 — 129 — 20,448  
County Number

Loc. 1650' FSL & WL  
County Morton

Operator  
Anadarko Production Company

Address  
P. O. Box 351, Liberal, Kansas 67901

Well No. 1 Lease Name GREGG "D"

Footage Location  
1650 feet from (N) (S) line 1650 feet from (E) (W) line

Principal Contractor Lohmann-Johnson Drlg. Co. Geologist Mr. Joe Blair

Spud Date 7/20/80 Date Completed 10/21/80 Total Depth 5317' P.B.T.D. 4383'

Directional Deviation not applicable ~~Oil and Gas~~ Gas Purchaser Panhandle Eastern Pipe line Co.

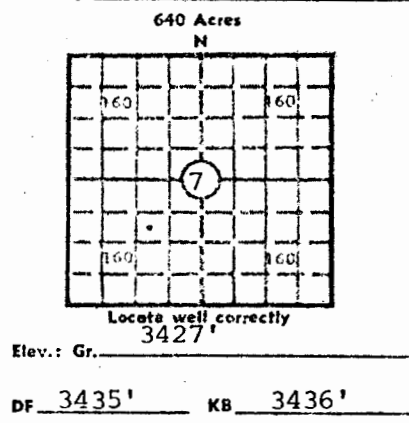

CASING RECORD

Report of all strings set — surface, intermediate, production, etc.

Purpose of string	Size hole drilled	Size casing set (in O.D.)	Weight lbs/ft.	Setting depth	Type cement	Sacks	Type and percent additives
Surface	12-1/4"	8-5/8"	24#	1365	Pozmix Common	600 200	4% gel 2% CaCl 2% CaCl
Production	7-7/8"	5-1/2"	15.5#	4530'	1st Lite-wate Stage SS Poz	50 70	.5% CFR-2 .5% CFR-2
					2nd Lite-wate Stage SS Poz	245 100	.5% CFR-2 .5% CFR-2

LINER RECORD

PERFORATION RECORD

Top, ft.	Bottom, ft.	Sacks cement	Shots per ft.	Size & type	Depth interval
			2	.43	4332-4340'

TUBING RECORD

Size	Setting depth	Packer set at
2-3/8"	4310'	

ACID, FRACTURE, SHOT, CEMENT SQUEEZE RECORD

Amount and kind of material used	Depth interval treated
A/2000 gal 15% Spearhead + 30 BS. F/29000 gals 70% Foamed 2%	
KCL wtr + 36,000 20/40 sand.	4332-4340'

INITIAL PRODUCTION

Date of first production SI for Pipeline Conn Producing method (flowing, pumping, gas lift, etc.) Flowing

RATE OF PRODUCTION PER 24 HOURS  
Oil -0- bbls. Gas 2420 MCF Water -0- bbls. Gas-oil ratio --- CFPB

Disposition of gas (vented, used on lease or sold) To be sold Producing interval (s) 4332-4340'

INSTRUCTIONS: As provided in KCC Rule 82-2-125, within 90 days after completion of a well, one completed copy of this Drillers Log shall be transmitted to the State Geological Survey of Kansas, 4150 Monroe Street, Wichita, Kansas 67209. Copies of this form are available from the Conservation Division, State Corporation Commission, 245 No. Water, Wichita, Kansas 67202. Phone AC 316-522-2206. If confidential custody is desired, please note Rule 82-2-125. Drillers Logs will be on open file in the Oil and Gas Division, State Geological Survey of Kansas, Lawrence, Kansas 66044.

Operator

Anadarko Production Company

DESIGNATE TYPE OF COMP.: OIL, GAS, DRY HOLE, SWDW, ETC.:

Well No.

1

Lease Name

GREGG "D"

GAS

S 7 T 34S R 41 Ex W

WELL LOG

Show all important zones of porosity and contents thereof; cored intervals, and all drill-stem tests, including depth interval tested, cushion used, time tool open, flowing and shut-in pressures, and recoveries.

SHOW GEOLOGICAL MARKERS, LOGS RUN, OR OTHER DESCRIPTIVE INFORMATION.

FORMATION DESCRIPTION, CONTENTS, ETC.	TOP	BOTTOM	NAME	DEPTH
Surface and Redbed	0'	388'	LOGS: SCHLUMBERGER Dual Induction-SFL Compensated Neutron- Formation Density	
Redbed and Sand	388'	1356'		
Anhydrite	1356'	1366'		
Shale	1366'	2795'		
Lime and Shale	2795'	5317'		
TD		5317'		
DST #1 4330-4385 (Cherokee) 30-60-60-120, IH 2117, FH 2117, IF 59-74 (30), ISIP 1087 (60), FF 59-118 (60), FSIP 1087 (120, rec 100' GCDM, gas to surface on second opening.				

USE ADDITIONAL SHEETS, IF NECESSARY, TO COMPLETE WELL RECORD.

Date Received

*Paul Campbell*  
Signature

Paul Campbell, Division Production Manager

Title

October 24, 1980

Date