

KANSAS DRILLERS LOG

State Geological Survey
WICHITA BRANCH

15-129-20339
18-34-43W

API No. 15 — 129 — 20,339
County Number

S. 18 T. 34 R. 43 ^SW
Loc. 1020' FWL & 1320' FWL
County Morton Sec. SW

Operator
EDGAR W. WHITE d/b/a C S W ENERGY

Address
701 Vilymaca Street - Elkhart, KS. 67950

Well No. #1 Lease Name Interstate Red Cave

Footage Location
1320' feet from (X) (S) line 1020 feet from (E) (W) line of SW 1/4

Principal Contractor KTM Drilling Company Geologist

Spud Date December 10, 1977 Total Depth 1316 ft. P.B.T.D.

Date Completed December 13, 1977 Oil Purchaser

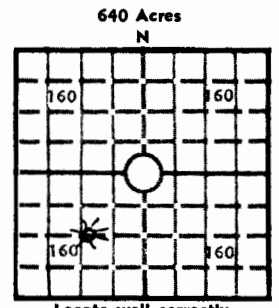

Elev.: Gr. 3561.4'
DF _____ KB _____

CASING RECORD

Report of all strings set — surface, intermediate, production, etc.

Purpose of string	Size hole drilled	Size casing set (in O.D.)	Weight lbs/ft.	Setting depth	Type cement	Sacks	Type and percent additives
Surface	12 1/8	8 5/8		376 ft.	Halliburton to bottom	cemented	solid top
Long	7 7/8	4 1/2		1316 ft.	Halliburton to bottom	cemented	solid top

LINER RECORD

PERFORATION RECORD

Top, ft.	Bottom, ft.	Sacks cement	Shots per ft.	Size & type	Depth interval
			two	jet	1288 to 1292

Size	Setting depth	Packer set at
2 3/8	1300	none

ACID, FRACTURE, SHOT, CEMENT SQUEEZE RECORD

Amount and kind of material used	Depth interval treated
Frac with 5,000# 20-40 sand, 24,000 cu. ft. Nitrogen foam with clay stay, 36 BBL total loan	1288 to 1292
Well completed and shut in 2-21-78 at 5 P.M. for testing on 2-23-78.	

INITIAL PRODUCTION

Date of first production tested 2-23-78 to 2-24-78 Producing method (flowing, pumping, gas lift, etc.) Flow gas thru casing-pump water thru tubing

RATE OF PRODUCTION PER 24 HOURS	Oil	Gas	Water	Gas-oil ratio
	bbls.	MCF	bbls.	CFPB

Disposition of gas (vented, used on lease or sold) Shut-in: Sold to Colorado Interstate Gas Company Producing interval (s) 1288 to 1292

INSTRUCTIONS: As provided in KCC Rule 82-2-125, within 90 days after completion of a well, one completed copy of this Drillers Log shall be transmitted to the State Geological Survey of Kansas, 4150 Monroe Street, Wichita, Kansas 67209. Copies of this form are available from the Conservation Division, State Corporation Commission, 3830 So. Meridian (P.O. Box 17027), Wichita, Kansas 66217. Phone AC 316-522-2206. If confidential custody is desired, please note Rule 82-2-125. Drillers Logs will be on open file in the Oil and Gas Division, State Geological Survey of Kansas, Lawrence, Kansas 66044.

Operator
EDGAR W. WHITE

DESIGNATE TYPE OF COMP.: OIL, GAS,
DRY HOLE, SWDW, ETC.:

Well No. 1 Lease Name Interstate Red Cave #1

S 18 T 34 R 43 W Morton County, Kansas

WELL LOG

Show all important zones of porosity and contents thereof; cored intervals, and all drill-stem tests, including depth interval tested, cushion used, time tool open, flowing and shut-in pressures, and recoveries.

SHOW GEOLOGICAL MARKERS, LOGS RUN,
OR OTHER DESCRIPTIVE INFORMATION.

FORMATION DESCRIPTION, CONTENTS, ETC.	TOP	BOTTOM	NAME	DEPTH
See Schlumberger Log Attached				

USE ADDITIONAL SHEETS, IF NECESSARY, TO COMPLETE WELL RECORD.

Date Received	
	Signature
	Owner
	Title
	3-7-78
	Date

8-30-88