

KANSAS DRILLERS LOG

S. 20 T. 34S R. 43W

Loc. 1980'FEI 1710'FNI

County Morton

API No. 15 — 129 County — 20358 Number

Operator Pan Eastern Exploration Co.

Address Box 828 Liberal, Ks. -67351- 67901

Well No. #2 Lease Name Interstate

Footage Location 1710 feet from (N) line 1980 feet from (E) line

Principal Contractor Gabbert-Jones Geologist C. L. Gadson

Spud Date 6/21/78 Total Depth 2970 P.B.T.D. ----

Date Completed 8/3/78 Oil Purchaser -----

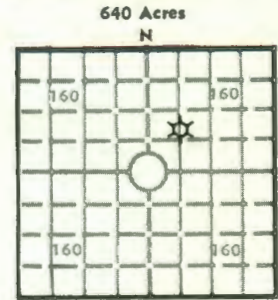

Locate well correctly
Elev.: Gr. 3484

DF ----- KB -----

CASING RECORD

Report of all strings set — surface, intermediate, production, etc.

Purpose of string	Size hole drilled	Size casing set (in O.D.)	Weight lbs/ft.	Setting depth	Type cement	Sacks	Type and percent additives
Surface	12-1/4	8-5/8	24	315	Common	350	3% CaCL
Production	7-7/8	4-1/2	10.5	2968	Pozmix	150	.5% CFR2

LINER RECORD

PERFORATION RECORD

Top, ft.	Bottom, ft.	Sacks cement	Shots per ft.	Size & type	Depth interval
			2	DP	
			2942-48	2728-32	2652-54 2515-20
Size	Setting depth	Packer set at	2910-20	2712-16	2498-02 2478-82
2-3/8	2950	None			

ACID, FRACTURE, SHOT, CEMENT SQUEEZE RECORD

Amount and kind of material used	Depth interval treated
9,000 gals Dolotrol acid and 100 ball sealers.	overall

INITIAL PRODUCTION

Date of first production		Producing method (flowing, pumping, gas lift, etc.) flow			
RATE OF PRODUCTION PER 24 HOURS	Oil ----- bbis.	Gas 2000 MCF	Water ----- bbis.	Gas-oil ratio -----	CFPB
Disposition of gas (vented, used on lease or sold) To be sold			Producing interval (s) Greenwood Series		

INSTRUCTIONS: As provided in KCC Rule 82-2-125, within 90 days after completion of a well, one completed copy of this Drillers Log shall be transmitted to the State Geological Survey of Kansas, 4150 Monroe Street, Wichita, Kansas 67209. Copies of this form are available from the Conservation Division, State Corporation Commission, 3830 So. Meridian (P.O. Box 17027), Wichita, Kansas 66217. Phone AC 316-522-2206. If confidential custody is desired, please note Rule 82-2-125. Drillers Logs will be on open file in the Oil and Gas Division, State Geological Survey of Kansas, Lawrence, Kansas 66044.

Operator **Pan Eastern Exploration Company** DESIGNATE TYPE OF COMP.: OIL, GAS, DRY HOLE, SWDW, ETC.: Gas

Well No. **2** Lease Name **Interstate**

S 20 T 34 R 43 E
W

WELL LOG

Show all important zones of porosity and contents thereof; cored intervals, and all drill-stem tests, including depth interval tested, cushion used, time tool open, flowing and shut-in pressures, and recoveries.

SHOW GEOLOGICAL MARKERS, LOGS RUN, OR OTHER DESCRIPTIVE INFORMATION.

FORMATION DESCRIPTION, CONTENTS, ETC.	TOP	BOTTOM	NAME	DEPTH
Sand-Surface Clay-Redbed	0	325		
Redbed	325	725		
Redbed-Sand	725	1162		
Sand-Redbed-Anhy	1162	1188		
Sand-Redbed	1188	1775		
Shale	1775	1862		
Lime+Shale	1862	2970		
		2970-TD		

USE ADDITIONAL SHEETS, IF NECESSARY, TO COMPLETE WELL RECORD.

Date Received _____

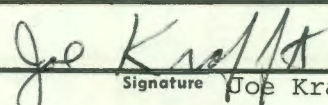
 Signature **Joe Krafft**
 Region Production Engineer
 Title
 August 7, 1978
 Date

6510HS

50-34-4300