

KANSAS

**WELL COMPLETION REPORT AND DRILLER'S LOG**

*State Geological Survey*  
**WICHITA, BRANCH**

S. 22 T. 34S R. 9 <sup>1/2</sup> <sub>W</sub>  
Loc. C SW SE SE  
County Harper

API No. 15 — Harper — 077-20,688  
County Number

Operator  
ROBINSON OIL COMPANY

Address  
737 R. H. Garvey Building, 200 W. Douglas, Wichita, KS 67202

Well No. 1 Lease Name Crow "A"

Footage Location  
330' feet from (X) (S) line 990 feet from (E) (W) line

Principal Contractor Sweetman Drilling, Inc. Geologist Lee Poulsen

Spud Date 4/29/81 Date Completed 5/6/81 Total Depth 4649' P.B.T.D.

Directional Deviation None Oil and/or Gas Purchaser N/A

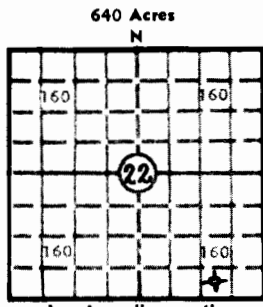

Elev.: Gr. 1275  
DF 1281 KB 1285

**CASING RECORD**

Report of all strings set — surface, intermediate, production, etc.

Purpose of string	Size hole drilled	Size casing set (in O.D.)	Weight lbs/ft.	Setting depth	Type cement	Sacks	Type and percent additives
Surface	12 1/4"	8-5/8"	24#	229'	Common	200	2% gel, 3% CC

**LINER RECORD**

**PERFORATION RECORD**

Top, ft.	Bottom, ft.	Sacks cement	Shots per ft.	Size & type	Depth interval

**TUBING RECORD**

Size	Setting depth	Packer set at

**ACID, FRACTURE, SHOT, CEMENT SQUEEZE RECORD**

Amount and kind of material used	Depth interval treated

**INITIAL PRODUCTION**

Date of first production		Producing method (flowing, pumping, gas lift, etc.)			
RATE OF PRODUCTION PER 24 HOURS	Oil	Gas	Water	Gas-oil ratio	
	bbls.	MCF	bbls.	CFPB	
Disposition of gas (vented, used on lease or sold)			Producing interval (s)		

INSTRUCTIONS: As provided in KCC Rule 82-2-125, within 90 days after completion of a well, one completed copy of this Drillers Log shall be transmitted to the State Geological Survey of Kansas, 4150 Monroe Street, Wichita, Kansas 67209. Copies of this form are available from the Conservation Division, State Corporation Commission, 245 No. Water, Wichita, Kansas 67202. Phone AC 316-522-2206. If confidential custody is desired, please note Rule 82-2-125. Drillers Logs will be on open file in the Oil and Gas Division, State Geological Survey of Kansas, Lawrence, Kansas 66044.

Operator  
ROBINSON OIL COMPANY

DESIGNATE TYPE OF COMP.: OIL, GAS,  
DRY HOLE, SWDW, ETC.:

Well No. 1 Lease Name Crow "A" Dry Hole

S 22 T 34S R 9 W

**WELL LOG**

Show all important zones of porosity and contents thereof; cored intervals, and all drill-stem tests, including depth interval tested, cushion used, time tool open, flowing and shut-in pressures, and recoveries.

SHOW GEOLOGICAL MARKERS, LOGS RUN, OR OTHER DESCRIPTIVE INFORMATION.

FORMATION DESCRIPTION, CONTENTS, ETC.	TOP	BOTTOM	NAME	DEPTH
Dst. #1 0 45"; SI 60"; 0 60"; SI 90"; Fair blow increasing to strong. Recovered 915' gas in pipe; 65' SOCM; IFP 30#-30# FFP 50#-50# IBHSIP 275# psi building FBHSIP 740# psi building	4582	4606	Sample Tops: Iatan Stalnaker Kansas City Stark Cherokee Mississippian	3760 3792 4060 4206 4470 4574
Dst. #2 0 60" SI 60"; 0 60"; SI 120" Weak blow increasing to strong. Recovered 685' gas in pipe; 105' SO&GCM IFP 85#-75# FFP 95#-95# IBHSIP 325# building FBHSIP 525# building	4592	4620	GRN-Log Log Tops: Heebner Iatan Stalnaker Kansas City Stark Base K.C. Cherokee Mississippi	3467 3756 3792 4063 4208 4297 4470 4575
Red Bed	0	233	Log T. D.	4649
Red Bed & Shale	233	1260		
Shale	1260	1806		
Lime & Shale	1806	4606		
Mississippi	4606	4649		
Total Depth		4649		

USE ADDITIONAL SHEETS, IF NECESSARY, TO COMPLETE WELL RECORD.

Date Received	
	Owner
	May 6, 1981
	Date