

State Geological Survey
WICHITA, BRANCH
KANSAS DRILLERS LOG

IMPORTANT
Kans. Geo. Survey request
samples on this well.

5-35-11W

S. 5 T. 35 R. 11 ^W
Loc. N2 NW NW
County Barber

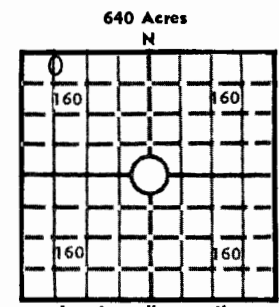

API No. 15 — 007 — 20,361
County Number

Operator
Molz Oil Company

Address
Route #2 Kiowa, Kansas 67070

Well No. #1 Lease Name Blond-Goldman

Footage Location
150 feet from (N) (30) line 660 feet from (E) (W) line

Principal Contractor Sweetman Drlg. Geologist Douglas H. McGinness

Spud Date 10-21-75 Total Depth 5259 P.B.T.D. 4906

Date Completed Oil Purchaser

Locate well correctly
Elev.: Gr. 1369
DF 1376 KB 1379

CASING RECORD

Report of all strings set — surface, intermediate, production, etc.

Purpose of string	Size hole drilled	Size casing set (in O.D.)	Weight lbs/ft.	Setting depth	Type cement	Sacks	Type and percent additives
Surface	12 3/4	10 3/4	20	247	common	150	3% cc 2% Gel
Production	7 7/8	4 1/2	15	4906	common	100	3% cc 2% Gel

LINER RECORD

PERFORATION RECORD

Top, ft.	Bottom, ft.	Sacks cement	Shots per ft.	Size & type	Depth interval
			4	D.P.	4782-4790 (SQ'D)
			4	D.P.	4749-4751 & 4763-4769

TUBING RECORD

Size	Setting depth	Packer set at
2 3/8	4787	hung

ACID, FRACTURE, SHOT, CEMENT SQUEEZE RECORD

Amount and kind of material used	Depth interval treated
@ 4782-90 500 ^{15%} Gal SME followed by 5000 Gal Gel wtr & 5000 # 20-40 sand size, Channel Sq'd w/200 sx common; reperforate &	4782-4790 (SQ'D)
500 ^{15%} Gal SME, channel Sq'd again w/200 sx common; then 750 Gal ^{15%} SME followed by 6000 Gal Gel wtr & 6000 # 20-40 size sand	@ 4749-51 & 4763-69

INITIAL PRODUCTION

Date of first production Producing method (flowing, pumping, gas lift, etc.)

RATE OF PRODUCTION PER 24 HOURS	Oil	Gas	Water	Gas-oil ratio
	bbls.	MCF	bbls.	CFPB
Disposition of gas (vented, used on lease or sold)			Producing interval (s)	

INSTRUCTIONS: As provided in KCC Rule 82-2-125, within 90 days after completion of a well, one completed copy of this Drillers Log shall be transmitted to the State Geological Survey of Kansas, 4150 Monroe Street, Wichita, Kansas 67209. Copies of this form are available from the Conservation Division, State Corporation Commission, 3830 So. Meridian (P.O. Box 17027), Wichita, Kansas 66217. Phone AC 316-522-2206. If confidential custody is desired, please note Rule 82-2-125. Drillers Logs will be on open file in the Oil and Gas Division, State Geological Survey of Kansas, Lawrence, Kansas 66044.

Operator

MOLZ OIL COMPANY

DESIGNATE TYPE OF COMP.: OIL, GAS, DRY HOLE, SWDW, ETC.:

OIL

Well No.

Lease Name
Blond-Goldman

S 5 T 35S R 11 K
W

WELL LOG

Show all important zones of porosity and contents thereof; cored intervals, and all drill-stem tests, including depth interval tested, cushion used, time tool open, flowing and shut-in pressures, and recoveries.

SHOW GEOLOGICAL MARKERS, LOGS RUN, OR OTHER DESCRIPTIVE INFORMATION.

FORMATION DESCRIPTION, CONTENTS, ETC.	TOP	BOTTOM	NAME	DEPTH
DST #1 Open 1½ hr., Gas/4", F/220 MCFG decl'd to 110 MCFG/90", Recovered 30' GCM BHP #1529 FP #51-20 FBHP #1354/60"	4750 -	4780	Kansas City Mississippi Misener Maquoketa	4306 4746 5078 5080
DST #2 Open 1½ hr., Gas 70" F/5 MCFG Rec. 75' O&GCM, 120' VHO&GCM, 180' GCM, BHP #1540/30" FP #92-133 FBHP #1728/60"	4780 -	4800	Viola Simpson Total Depth	5128 5229 5259
DST #3 Open 1½ hr., Rec 30' Mud BHP #51 FP #51-31 FBHP #51/30"	5056 @	5090		

USE ADDITIONAL SHEETS, IF NECESSARY, TO COMPLETE WELL RECORD.

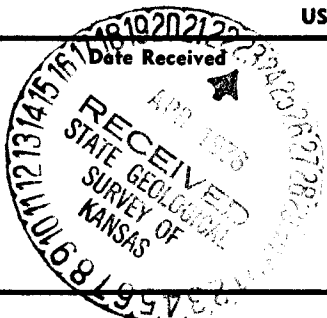

[Signature]
Signature
MOLZ OIL COMPANY President
Title

Date

32:111

5-35-11W

State Geological Survey
WICHITA, BRANCH

WELL LOG
Blond- Goldman #1
C N/2 NW NW 5-35S-11W
Barber County, Kansas

Name of Operator: Molz Oil Company
R.R.#2
Kiowa, Kansas 67070

Date Completed: November 5, 1975

<u>FROM</u>	<u>TO</u>	
0	30	Red bed and sand
30	965	Red bed and shale
965	1368	Shale
1368	3556	Lime and shale
3556	3610	Sand
3610	4309	Lime and shale
4309	4800	KC Lime
4800	5259	Miss.
5259		Total Depth

STATE OF KANSAS

COUNTY OF BARTON ss

Gary L. Hawk, Secretary of Sweetman Drilling, Inc., being first duly sworn on oath says: That I have knowledge of the facts, statements and matters herein contained and the log of the above described well as filed and that the same are true and correct.

Gary L. Hawk
Gary L. Hawk

Subscribed and sworn before me this 12th day of November, 1975.

Mary Ann Schwamborn
Notary Public Barton County