

1-35-12W and

WELL COMPLETION REPORT AND
DRILLER'S LOG

S. 1 T. 35 R. 12 ^W _E

API No. 15 — 007 — 20,892
County Number

Loc. 150' SW/C SW NE NW

Operator
Robinson Oil Co.

County Barber

Address
737 R. H. Garvey Bldg. Wichita, Kansas 67202

Well No. #1 Lease Name Achenbach "B-C" (Achenbach 'B' 1)

Footage Location
1096 feet from (N) (S) line 1544 feet from (E) (W) line

Principal Contractor Sweetman Drilling Geologist Raymond M. Goodin

Spud Date 2-13-80 Date Completed 5-21-80 Total Depth 4805 P.B.T.D. 4805

Directional Deviation 1/2° Oil and/or Gas Purchaser
Oil: Lawson GAS: Panhandle Eastern

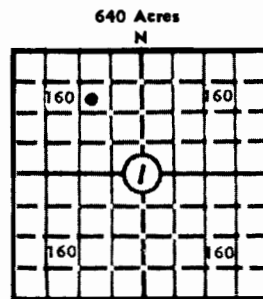

Locate well correctly
Elev.: Gr. 1419

DF 1426 KB 1429

CASING RECORD

Report of all strings set — surface, intermediate, production, etc.

Purpose of string	Size hole drilled	Size casing set (in O.D.)	Weight lbs/ft.	Setting depth	Type cement	Sacks	Type and percent additives
Surface	14-3/4"	10-3/4"	40#	303' KB	Common	300	2% gel, 3% cc
Production	7-7/8"	4-1/2"	10.5#	4790.45	Common	150	5% salt

LINER RECORD

PERFORATION RECORD

Top, ft.	Bottom, ft.	Sacks cement	Shots per ft.	Size & type	Depth interval
			None		4790-4805
TUBING RECORD					open hole
Size	Setting depth	Packer set at			
2-3/8"	4790'	-			

ACID, FRACTURE, SHOT, CEMENT SQUEEZE RECORD

Amount and kind of material used	Depth interval treated
500 15% MCA Acid	4790-4805
Frac w/15,500# (155 sx) 20-40 mesh sand 16,000gal. 70% foam	
2% KCL Water 81,000 SCF Nitrogen	

INITIAL PRODUCTION

Date of first production <u>2-29-80</u>	Producing method (flowing, pumping, gas lift, etc.) <u>Flowing</u>
RATE OF PRODUCTION PER 24 HOURS	Oil <u>60</u> bbls. Gas <u>577</u> MCF Water <u>9.617</u> bbls. Gas-oil ratio <u>CFPB</u>
Disposition of gas (vented, used on lease or sold) <u>Sold</u>	Producing interval(s) <u>4790-4805</u>

INSTRUCTIONS: As provided in KCC Rule 82-2-125, within 90 days after completion of a well, one completed copy of this Drillers Log shall be transmitted to the State Geological Survey of Kansas, 4150 Monroe Street, Wichita, Kansas 67209. Copies of this form are available from the Conservation Division, State Corporation Commission, 245 No. Water, Wichita, Kansas 67202. Phone AC 316-522-2206. If confidential custody is desired, please note 82-2-125. Drillers Logs will be on an open file in the Oil and Gas Division, State Geological Survey of Kansas, Lawrence, Kansas 66044.

ator ROBINSON OIL COMPANY

DESIGNATE TYPE OF COMP.: OIL, GAS, DRY HOLE, SWD, ETC.:

Well No. 1	Lease Name ACHENBACH "B-C"	Oil-
S 1 T 35 R 12 W		SW NE NW

WELL LOG

Show all important zones of porosity and contents thereof; cored intervals, and all drill-stem tests, including depth interval tested, cushion used, time tool open, flowing and shut-in pressures, and recoveries.

SHOW GEOLOGICAL MARKERS, LOGS RUN, OR OTHER DESCRIPTIVE INFORMATION.

FORMATION DESCRIPTION, CONTENTS, ETC.	TOP	BOTTOM	NAME	DEPTH
Dst. #1 (Mississippian) 0 45" SI 60" 0 60" SI 90" Strong blow w/GTS in 5". Gauged 242 MCF/D in 10" second gas opening; Stabilized at 577 MCF/D Rec. 806' clean GCO FFPS 106-202# ISIBHP 1852# FFPS 223-277# FBHP 1810# Red Bed & Sand Red Bed & Shale Lime & Shale Mississippi T. D.	4793 0 306 1755 4788 4805	4805 306 1755 4788 4805	Heebner Kansas City Stark B/Kansas City Cherokee Shale Cherokee Sand Mississippi	3821 4364 4521 4608 4741 4768 4788

USE ADDITIONAL SHEETS, IF NECESSARY, TO COMPLETE WELL RECORD.

Date Received	<i>Robinson</i> Signature
	Owner
	Title
	May 26, 1980 Date

32-15m