

5-35-12W

KANSAS
State Geological Survey
WICHITA, BRANCH
AUG 8 - 0 REC'D

WELL COMPLETION REPORT AND DRILLER'S LOG

S. 5 T. 35 R. 12W ^EW
Loc. SW SE SE
County Barber

API No. 15 _____ County _____ Number _____

Operator
Beren Corporation

Address
970 Fourth Financial Center, Wichita, Kansas 67202

Well No. 7 Lease Name BLACKSTOCK

Footage Location
feet from (N) (S) line _____ feet from (E) (W) line _____

Principal Contractor BEREDCO Geologist Bill Iversen

Spud Date May 9, 1980 Date Completed May 19, 1980 Total Depth 4850 P.B.T.D. _____

Directional Deviation _____ Oil and/or Gas Purchaser _____

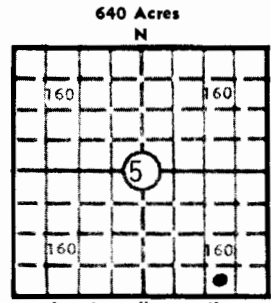

Elev.: Gr. 1458
DF _____ KB 1471

CASING RECORD

Report of all strings set — surface, intermediate, production, etc.

Purpose of string	Size hole drilled	Size casing set (in O.D.)	Weight lbs./ft.	Setting depth	Type cement	Sacks	Type and percent additives
Conductor		16"		110			
Surface		8-5/8	28#	414	60-40 pozmix	300	2% gel, 3% CC
Production		5½	14#	4849	60-40 pozmix	250	

LINER RECORD

PERFORATION RECORD

Top, ft.	Bottom, ft.	Sacks cement	Shots per ft.	Size & type	Depth interval

Size	Setting depth	Packer set at

ACID, FRACTURE, SHOT, CEMENT SQUEEZE RECORD

Amount and kind of material used	Depth interval treated

INITIAL PRODUCTION

Date of first production _____	Producing method (flowing, pumping, gas lift, etc.) _____
RATE OF PRODUCTION PER 24 HOURS	Oil _____ bbls. Gas _____ MCF Water _____ bbls. Gas-oil ratio _____ CFPB
Disposition of gas (vented, used on lease or sold) _____	Producing interval(s) _____

INSTRUCTIONS: As provided in KCC Rule 82-2-125, within 90 days after completion of a well, one completed copy of this Drillers Log shall be transmitted to the State Geological Survey of Kansas, 4150 Monroe Street, Wichita, Kansas 67209. Copies of this form are available from the Conservation Division, State Corporation Commission, 245 No. Water, Wichita, Kansas 67202. Phone AC 316-522-2206. If confidential custody is desired, please note Rule 82-2-125. Drillers Logs will be on open file in the Oil and Gas Division, State Geological Survey of Kansas, Lawrence, Kansas 66044.

erator

Beren Corporation

DESIGNATE TYPE OF COMP.: OIL, GAS, DRY HOLE, SWDW, ETC.:

Well No. 7 Lease Name BLACKSTOCK Oil

S 5 T 35 R 12 W E W

WELL LOG

Show all important zones of porosity and contents thereof; cored intervals, and all drill-stem tests, including depth interval tested, cushion used, time tool open, flowing and shut-in pressures, and recoveries.

SHOW GEOLOGICAL MARKERS, LOGS RUN, OR OTHER DESCRIPTIVE INFORMATION.

FORMATION DESCRIPTION, CONTENTS, ETC.	TOP	BOTTOM	NAME	DEPTH
RB	0	415		
RB and shale	415	1101		
Shale	1101	1767		
Shale and lime	1767	3086		
Shale and lime and sand	3086	3280		
Shale and lime	3280	4850		
RTD	4850			

USE ADDITIONAL SHEETS, IF NECESSARY, TO COMPLETE WELL RECORD.

Date Received

Don Beauchamp
Signature

Don Beauchamp - Geologist
Title

August 4, 1980
Date

2-22-18 11

PI

200

5-35-12W

DRILLERS LOG

State Geological Survey
WICHITA BRANCH

Blackstock #7
Barber County
SW SE SE of
Sec. 5-35S-12W

Company: BEREN CORPORATION

Contractor: BEREDCO

SEP

Comm.: May 9, 1980

Compl.: May 19, 1980

Casing: 8 5/8", 28# set at 414' with 300 sacks pozmix, 2% gel, 3% CC, 60-40

5 1/2", 14# set at 4849' with 250 sacks pozmix 60-40

<u>FORMATION</u>	<u>FROM</u>	<u>TO</u>
RB	0'	415'
RB and Shale	415'	1101'
Shale	1101'	1767'
Shale and Lime	1767'	3086'
Shale and Lime and Sand	3086'	3280'
Shale and Lime	3280'	4850'

Rotary Total Depth 4850'

STATE OF KANSAS

ss:

COUNTY OF SEDGWICK

I certify that this is a true and correct copy of the above log as shown by the drilling reports.

BEREDCO

Mary F. McGood

Subscribed and sworn to before me this 5th day of June, 1980.

Karen G. Berry

