

IMPORTANT  
Kans. Geo. Survey request  
samples on this well.

7-35-16W

S. 7 T. 35 R. 16 <sup>E</sup><sub>W</sub>  
Loc. C NW  
County Comanche

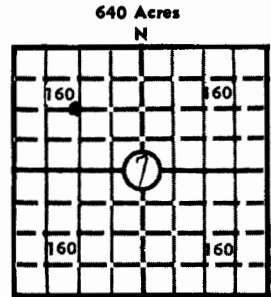

API No. 15 — 033 — 20,169  
County Number

Operator  
Samson Resources Co.

Address  
2700 First Place Tulsa, Oklahoma

Well No. # 1 Lease Name Beeley

Footage Location  
1320 feet from (N) 187 line 1280 feet from (E) (W) line

Principal Contractor Gabbert - Jones Geologist William A. Skitek

Spud Date 3-9-27 Total Depth 6075 P.B.T.D.

Date Completed 4-22-75 Oil Purchaser

Locate well correctly  
Elev.: Gr. 1855  
DF KB 1860

**CASING RECORD**

Report of all strings set — surface, intermediate, production, etc.

Purpose of string	Size hole drilled	Size casing set (in O.D.)	Weight lbs/ft.	Setting depth	Type cement	Sacks	Type and percent additives
<u>Surface</u>		<u>13 3/8"</u>	<u>54.5</u>	<u>434</u>	<u>Howco Light Class A</u>	<u>260</u> <u>100</u>	<u>3% CaCl<sub>2</sub> + 10% <sup>1/5x</sup> gilsonite</u> <u>3% CaCl<sub>2</sub></u>
<u>Production</u>		<u>4 1/2"</u>	<u>10.5</u>	<u>5550</u>	<u>Pozmix</u>	<u>125</u>	<u>18% salt + 3/4 of 1% CFR-2</u>

**LINER RECORD**

**PERFORATION RECORD**

Top, ft.	Bottom, ft.	Sacks cement	Shots per ft.	Size & type	Depth interval
			<u>1</u>	<u>3 1/8" csg Gun</u>	<u>5408, 5425, 5432,</u> <u>5441, 5450</u>
<b>TUBING RECORD</b>			<u>1</u>	<u>3 1/8" ✓ ✓</u>	<u>5370, 5378, 5382,</u> <u>5388, 5392, 5396</u>
Size	Setting depth	Packer set at			

**ACID, FRACTURE, SHOT, CEMENT SQUEEZE RECORD**

Amount and kind of material used	Depth interval treated
<u>450 gal 15% non-emulsion HCl</u>	<u>5450</u>
<u>1200 gal 15% ✓ ✓ HCl &amp; 12 ball sealers</u>	<u>5369 - 5395</u>
<u>1400 gal 15% ✓ ✓ HCl</u>	<u>5406 - 5448</u>

**INITIAL PRODUCTION**

Date of first production dry hole Producing method (flowing, pumping, gas lift, etc.)

RATE OF PRODUCTION PER 24 HOURS	Oil	Gas	Water	Gas-oil ratio
	bbls.	MCF	bbls.	CFPB
Disposition of gas (vented, used on lease or sold)			Producing interval(s)	

INSTRUCTIONS: As provided in KCC Rule 82-2-125, within 90 days after completion of a well, one completed copy of this Drillers Log shall be transmitted to the State Geological Survey of Kansas, 4150 Monroe Street, Wichita, Kansas 67209. Copies of this form are available from the Conservation Division, State Corporation Commission, 3830 So. Meridian (P.O. Box 17027), Wichita, Kansas 66217. Phone AC 316-522-2206. If confidential custody is desired, please note Rule 82-2-125. Drillers Logs will be on open file in the Oil and Gas Division, State Geological Survey of Kansas, Lawrence, Kansas 66044.

Operator **SAMSON RESOURCES CO.** DESIGNATE TYPE OF COMP.: OIL, GAS, DRY HOLE, SWDW, ETC.: **DRY HOLE**

Well No. **1** Lease Name **BEELEY**

S **7** T **355** R **16** W

**WELL LOG**

Show all important zones of porosity and contents thereof; record intervals, and all down-hole tests, including depth interval tested, cushion used, time tool open, flowing and shut-in pressures, and recoveries.

SHOW GEOLOGICAL MARKERS, LOGS RUN, OR OTHER DESCRIPTIVE INFORMATION.

FORMATION DESCRIPTION, CONTENTS, ETC.	TOP	BOTTOM	NAME	DEPTH
---------------------------------------	-----	--------	------	-------

**STRUCTURAL MARKERS - FORMATION TOPS ( ELECTRIC LOG )**

HERRINGTON	2512	( -652 )
WINFIELD	2583	( -723 )
TOWANDA	2650	( -790 )
FORT RILEY	2700	( -840 )
WREPFORD	2851	( -991 )
FUNSTON	2916	( -1056 )
BEATTIE	3054	( -1194 )
FORAKER	3226	( -1366 )
ADMIRE	3316	( -1456 )
WABAUNSEE	3440	( -1580 )
STOTLER	3584	( -1724 )
HOWARD	3812	( -1952 )
SHAWNEE	3957	( -2097 )
QUEEN HILL	4184	( -2324 )
KANWAKA	4200	( -2340 )
HEEBNER	4416	( -2556 )
TORONTO	4428	( -2568 )
IATAN ( BROWN LINE )	4608	( -2748 )
LANSING	4614	( -2754 )
SWOPE	5014	( -3154 )
BASE/KANSAS CITY	5174	( -3314 )
MARMATON	5206	( -3346 )
CHEROKEE	5288	( -3428 )
*ST. LOUIS	*5388	( -3528 )
SPERGEN	5400	( -3540 )
WARSAW	5511	( -3651 )
OSAGE ( "COWLEY" FACIES )	5606	( -3746 )
KINDERHOOK LIME	5940	( -4080 )
VIOLA	5982	( -4122 )

\* ALTHOUGH THIS DEPTH APPEARS TO BE THE LOGICAL ST. LOUIS TOP AS INDICATED BY THE ELECTRIC LOG, EXAMINATION OF THE DRILL CUTTING SAMPLES REVEAL THE PRESENCE OF LIMESTONE CHARACTERISTIC OF THE ST. LOUIS THROUGHOUT THE EROSIONAL SECTION FROM A DEPTH OF 5342-88.

USE ADDITIONAL SHEETS, IF NECESSARY, TO COMPLETE WELL RECORD.

Date Received

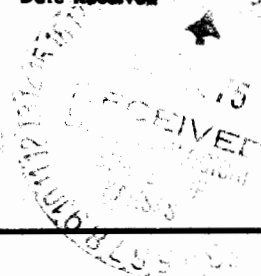

*Calvin Guthridge*

Signature

*Production Dept*

Title

*8/12/75*

Date

32-10M