

IMPORTANT
Kans. Geo. Survey request
samples on this well.

13-35-21W

KANSAS DRILLERS LOG

S. 13 T. 35S R. 21 ^W

Loc. C NE NW

County Clark

API No. 15 — Clark County — 15-025-20,166 Number

Operator
Kennedy & Mitchell, Inc.

Address
P.O. Box 1578 Liberal, Kansas 67901

Well No. #11-116 Lease Name Tuttle

Footage Location
660 feet from (N) (E) line 1980 feet from (E) (W) line

Principal Contractor DaMac Drilling Company Geologist

Spud Date September 26, 1977 Total Depth 6000 P.B.T.D. 5660

Date Completed October 11, 1977 Oil Purchaser

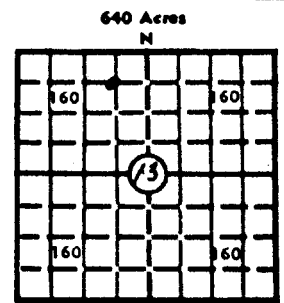

Elev.: Gr. 1786

Dr. 1795 KB 1798

CASING RECORD

Report of all strings set — surface, intermediate, production, etc.

Purpose of string	Size hole drilled	Size casing set (in O.D.)	Weight lbs/ft.	Setting depth	Type cement	Secks	Type and percent additives
Surface	12 $\frac{1}{2}$	8 5/8	23 & 24#	718'	35/65 poz 6% gel Class H	300 150	1/2# flocele 2% cc 3% cc
Production	7 7/8	4 $\frac{1}{2}$	10.5	5729'	Class H 8% gel 50/50 poz	50 150	12 $\frac{1}{2}$ # Kolite 10% sa 18% salt 12 $\frac{1}{2}$ # Kolite .75% TIC

LINER RECORD

PERFORATION RECORD

Top, ft.	Bottom, ft.	Secks cement	Shots per ft.	Size & type	Depth interval
			2 per foot	3 1/8 DP	5577-82'
			2 per foot	3 1/8 DP	5592-94'

TUBING RECORD

Size	Setting depth	Pecker set at
2 3/8	5586'	5586'

ACID, FRACTURE, SHOT, CEMENT SQUEEZE RECORD

Amount and kind of material used	Depth interval treated
Treated with 500 gals 15% DS-30 acid	5592-94'
Treated with 750 gals 15% DS-30 acid	5577-82'

INITIAL PRODUCTION

Date of first production _____ Producing method (flowing, pumping, gas lift, etc.) _____

RATE OF PRODUCTION PER 24 HOURS	Oil	Gas	Water	Gas-oil ratio
	5 bbls.	2500 MCF	1 bbls.	

Disposition of gas (vented, used on lease or sold) _____ Producing interval(s) Morrow 5577-82'; 5592-94'

to be sold				
Sand	0	72		
Red Bed, Shale	72	1356		
Shale	1356	1980		
Shale & Lime	1980	4870		
Lime	4870	6000		

13-35-21W

STATE OF KANSAS
STATE CORPORATION COMMISSION - CONSERVATION DIVISION
3830 South Meridian - Box 17027
Wichita, Kansas 67217

FORM C-2

DATA AND AFFIDAVIT

(On Cementing in Surface or Drive Pipe and required by Rule 82-2-123 of the Commission for compliance with Section 55-136, 55-137 and 55-138, 1947 Supplement to G. S. Kansas 1935)

LEASE OWNER Kennedy & Mitchell, Inc.

OFFICE ADDRESS P.O. Box 1578, Liberal, Kansas 67901

LEASE NAME Tuttle WELL NO. 11-116 COUNTY Clark

EXACT SPOT LOCATION C NE NW SEC. 13 TWP. 35S RGE. 21

CONTRACTOR DaMac Drilling Company

OFFICE ADDRESS Box 1164, Great Bend, Kansas 67530

Drilled with (Cable) or (Rotary) tools: Date pipe set 10-11-77

SURFACE HOLE DATA

SURFACE PIPE DATA

Size of Hole 12 1/4" Csg. (new) or (used) Size 8 5/8" Wt 23 & 24#

Depth 718' Where set 718'

METHOD OF CEMENTING

Cement: Amount and kind 300 sacks 35/65 - 6% gel - 1/4# flocele - 2% cc & 150 sack class H

Method: (By Service Co., Dump, Tog., etc.) Dowell pump

Est. Height Cement behind pipe circulated

GROUND WATER INFORMATION

Depth to bottom of lowest fresh water producing stratum 200'

Name of lowest fresh water producing stratum Ogalalla

Surface elevation of well 1786'

ADDITIONAL INFORMATION

(Additional information may be submitted on separate sheet)

A F F I D A V I T

STATE OF Kansas, COUNTY OF Seward SS,

STATE CORPORATION COMMISSION
CONSERVATION DIVISION

245 N. Water
Wichita, Kansas 67202

14 - 35 - 21W

KENNEDY & MITCHELL, INC.
TUTTLE # 11-116

Township 35S Range 21W County Clark Pool _____

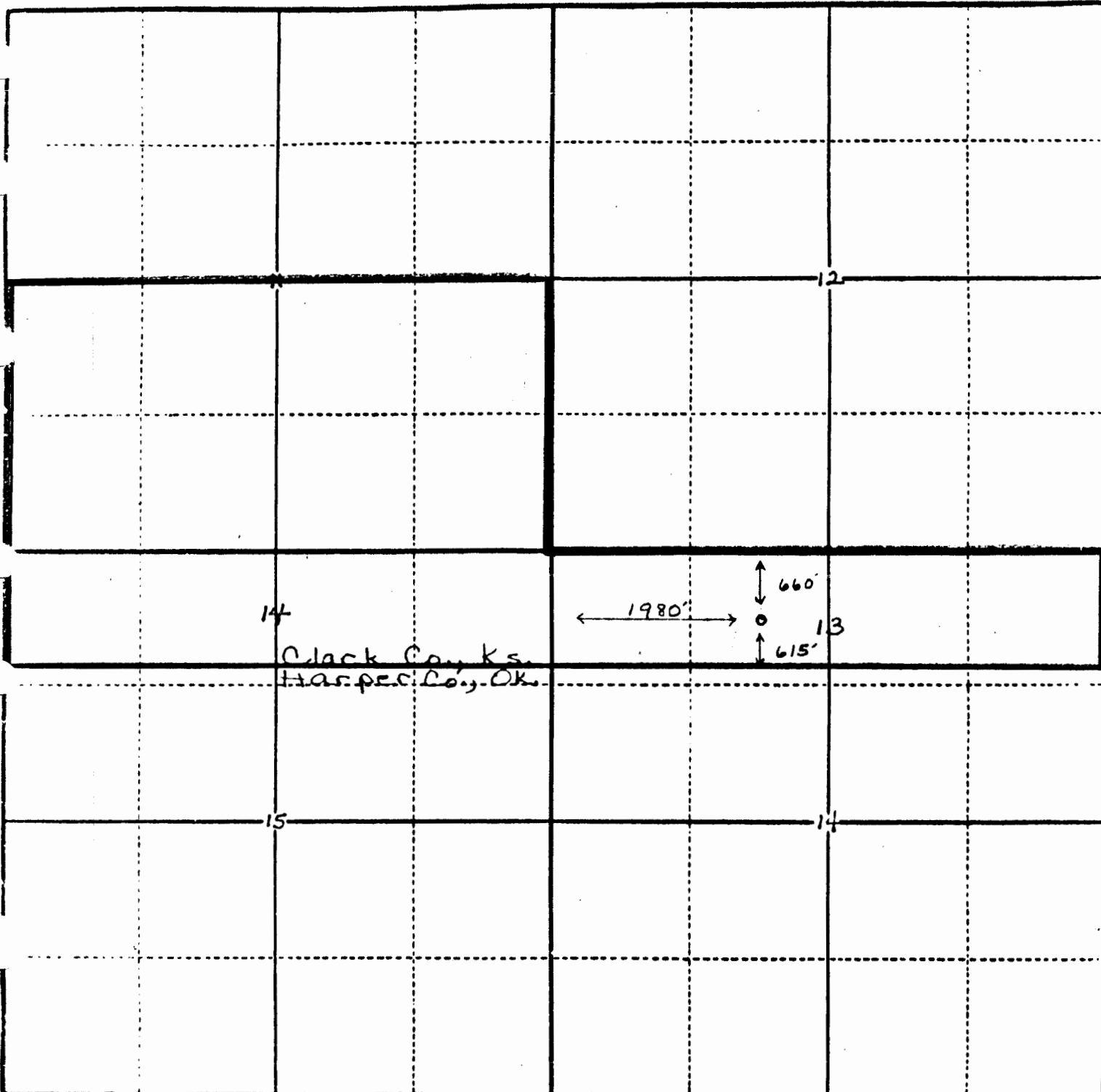

* Acreage attributed to well (632.44 acres)