

IMPORTANT

Geo. Survey request  
DRILLERS LOG

KANSAS GEOLOGICAL SOCIETY  
Wichita, Kansas  
State Geological Survey  
WICHITA, BRANCH

5-35-22W  
NW SE

S. 5 T. 35 R. 22 E W

Loc. C NW SE

County Clark

API No. 15 — 025 — 20,059  
County Number

Operator

Robert L. Haynie

Address

4155 East Jewell Avenue, Suite 802, Denver, Colorado

Well No.

#2 #3

Lease Name

Tuttle

Footage Location

feet from (N) (S) line

feet from (E) (W) line

Principal Contractor

DaMac Drilling Company

Geologist

Don G. Calvin

Spud Date

5/29/74

Total Depth

5700'

P.B.T.D.

Date Completed

6/16/74 P&A

Oil Purchaser

Dry Hole

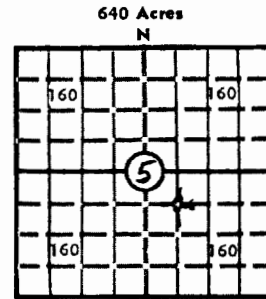

Locate well correctly

Elev.: Gr. 1933'

DF KB 1941'

CASING RECORD

Report of all strings set — surface, intermediate, production, etc.

Purpose of string	Size hole drilled	Size casing set (in O.D.)	Weight lbs/ft.	Setting depth	Type cement	Sacks	Type and percent additives
Surface		8 5/8"	20#	637'	common	1200	2% gel, 3% cal. chl 1000# loss circ. material

LINER RECORD

PERFORATION RECORD

Top, ft.	Bottom, ft.	Sacks cement	Shots per ft.	Size & type	Depth interval

Size	Setting depth	Packer set at

ACID, FRACTURE, SHOT, CEMENT SQUEEZE RECORD

Amount and kind of material used	Depth interval treated

INITIAL PRODUCTION

Date of first production		Producing method (flowing, pumping, gas lift, etc.)			
RATE OF PRODUCTION PER 24 HOURS	Oil	Gas	Water	Gas lift	CFPB
	bbls.	MCF	bbls.		
Disposition of gas (vented, used on lease or sold)			Producing interval (s)		

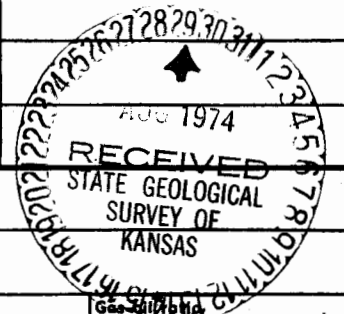

INSTRUCTIONS: As provided in KCC Rule 82-2-125, within 90 days after completion of a well, one completed copy of this Drillers Log shall be transmitted to the State Geological Survey of Kansas, 4150 Monroe Street, Wichita, Kansas 67209. Copies of this form are available from the Conservation Division, State Corporation Commission, 3830 So. Meridian (P.O. Box 17027), Wichita, Kansas 66217. Phone AC 316-522-2206. If confidential custody is desired, please note Rule 82-2-125. Drillers Logs will be on open file in the Oil and Gas Division, State Geological Survey of Kansas, Lawrence, Kansas 66044.

Robert L. Haynie

DESIGNATE TYPE OF COMP.: OIL, GAS, DRY HOLE, SWDW, ETC.:

Well No. 3	Lease Name Tuttle	Dry Hole
S 5 T35S R22 W		

**WELL LOG**

Show all important zones of porosity and contents thereof; cored intervals, and all drill-stem tests, including depth interval tested, cushion used, time tool open, flowing and shut-in pressures, and recoveries.

SHOW GEOLOGICAL MARKERS, LOGS RUN, OR OTHER DESCRIPTIVE INFORMATION.

FORMATION DESCRIPTION, CONTENTS, ETC.	TOP	BOTTOM	NAME	DEPTH
<u>Electric Log Top</u>				
Elevation 1941' Kelly Bushing				
Heebner Shale 4360 (-2419)				
Lansing Kansas City 4568 (-2627)				
Marmaton 5243 (-3302)				
Cherokee 5394 (-3453)				
Atoka-Morrow 5560 (-3619)				
Morrow Sand None				
Erosional Chester 5648 (-3707)				
RTD 5700 (-3759)				
<u>Drill Stem Test</u>				
One DST over an erosional Chester crinoidal limestone section which had favorable log calculations, but gave indication of low or no permeability. The DST had a weak blow throughout with no show of gas with 60# flow pressure and 105#/60" initial shut in pressure declining to 70#/60" final shut in pressure.				

USE ADDITIONAL SHEETS, IF NECESSARY, TO COMPLETE WELL RECORD.

Date Received	 _____ Secretary _____ 6/18/74 _____ Date