

**IMPORTANT**  
Kans. Geo. Survey request  
samples on this well.

8-35-22W

S. 8 T. 35 R. 22  $\frac{E}{W}$   
Loc. C NE  
County Clark

API No. 15 — 025 — 20,058  
County Number

Operator <b>Robert L. Haynie</b>		
Address <b>4155 East Jewell Ave., Suite 802 Denver, Colo, 80222</b>		
Well No. <b>#2</b>	Lease Name <b>Tuttle</b>	
Footage Location <b>1320</b> feet from (N) (3/4) line <b>1320</b> feet from (E) (3/4) line		
Principal Contractor <b>DaMac Drilling Co., Inc.</b>		Geologist <b>Don G. Calvin</b>
Spud Date <b>4/18/74</b>	Total Depth <b>5760</b>	P.B.T.D. <b>Log T.D. 5758'</b>
Date Completed <b>6/21/74</b>	Oil Purchaser <b>Shut-in gas well</b>	

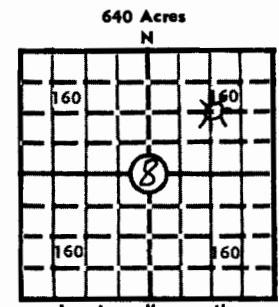

Locate well correctly  
Elev.: Gr. 1972  
DF 1977 KB 1979

**CASING RECORD**

Report of all strings set — surface, intermediate, production, etc.

Purpose of string	Size hole drilled	Size casing set (in O.D.)	Weight lbs/ft.	Setting depth	Type cement	Sacks	Type and percent additives
Surface casing	8 1/4"	8 5/8"	20#	631'	common	200	3% cal chl, 2% gel
		4 1/2"		5757'		150	

**LINER RECORD**

**PERFORATION RECORD**

Top, ft.	Bottom, ft.	Sacks cement	Shots per ft.	Size & type	Depth interval
			3/ft.		5707-5713'

Size	Setting depth	Packer set at
1 1/2"	5757'	

**ACID, FRACTURE, SHOT, CEMENT SQUEEZE RECORD**

Amount and kind of material used	Depth interval treated
	5707-5713

**INITIAL PRODUCTION**

Date of first production <b>SI Gas well</b>		Producing method (flowing, pumping, gas lift, etc.) <b>flowing</b>	
RATE OF PRODUCTION PER 24 HOURS	Oil bbls.	Gas MCF	Water bbls.
Disposition of gas (vented, used on lease or sold)		Producing interval (s) <b>5705-5716'</b>	
		CFPB	

INSTRUCTIONS: As provided in KCC Rule 82-2-125, within 90 days after completion of a well, one completed copy of this Drillers Log shall be transmitted to the State Geological Survey of Kansas, 4150 Monroe Street, Wichita, Kansas 67209. Copies of this form are available from the Conservation Division, State Corporation Commission, 3830 So. Meridian (P.O. Box 17027), Wichita, Kansas 66217. Phone AC 316-522-2206. If confidential custody is desired, please note Rule 82-2-125. Drillers Logs will be on open file in the Oil and Gas Division, State Geological Survey of Kansas, Lawrence, Kansas 66044.

Operator

Robert L. Haynie

DESIGNATE TYPE OF COMP.: OIL, GAS, DRY HOLE, SWDW, ETC.:

Well No.

2

Lease Name

Tuttle

SI Gas Well

S 8 T 35S R 22 E

W

C NE/4

WELL LOG

Show all important zones of porosity and contents thereof; cored intervals, and all drill-stem tests, including depth interval tested, cushion used, time tool open, flowing and shut-in pressures, and recoveries.

SHOW GEOLOGICAL MARKERS, LOGS RUN, OR OTHER DESCRIPTIVE INFORMATION.

FORMATION DESCRIPTION, CONTENTS, ETC.	TOP	BOTTOM	NAME	DEPTH
<u>Electric Log Tops</u>				
Heebner Shale	4414	(-2435)		
Lansing - Kansas City	4619	(-2640)		
Marmaton	5296	(-3317)		
Cherokee	5445	(-3466)		
Atoka-Morrow Marker	5614	(-3635)		
Morrow Sand Zone	5696	(-3717)		
Morrow Sand Porosity	5705	(-3726)		
Base Morrow Sand	5725	(-3746)		
Mississippian Chester	5728	(-3749)		
LTD	5758	(-3779)		
<p>DST #1: 5662-5723' - Strong gas to surface in 2", gauged 2,630,000 CFGPD on 2" choke in 5", Gauged 4,450,000 CFPD on 2" choke in 150"; on 2nd flow gauged 5,400,000 CFPD on 2" choke in 10", gauged 6,000,000 CFPD on 2" choke in 30", when the flow rate stabilized through the remainder of the 60" open flow period. 10' of very high gravity distillate was recovered in the tool. IFP 507#, FFP 1009#, ISIP 1967#/60" - FSIP 1923#/60".</p>				

USE ADDITIONAL SHEETS, IF NECESSARY, TO COMPLETE WELL RECORD.

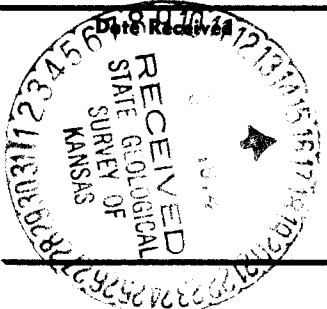

*Robert L. Haynie*  
Signature

Owner

Title

August 8, 1974

Date

3-22-35M

8-35-22w

COMPANY Robert L. Haynie

SEC. 8 T. 35 S. R. 22 W

AS Tuttle

NO. 2

LOC. NE

TOTAL DEPTH 5760'

API# 15-025-20,058

COUNTY Clark, Kansas

COMM. 4-18-74

COMP. 5-6-74

CONTRACTOR DeMac Drilling Company, Inc.

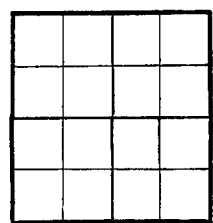

CASING

8 5/8" @ 631' w/400 sx  
4 1/2" @ 5759' w/150 sx

ELEVATION

PRODUCTION

FIGURES INDICATE BOTTOM OF FORMATIONS

- 150' Red Bed, Sand & Rock
- 1150' Shale
- 2085' Lime & Shale
- 2271' Lime
- 2550' Lime & Shale
- 3000' Lime
- 3052' Lime & Shale
- 3415' Lime
- 3578' Lime & Shale
- 4507' Lime
- 4714' Lime & Shale
- 4734' Lime & Shale
- 5238' Lime
- 5298' Lime & Shale
- 5356' Lime
- 5421' Lime & Shale
- 5548' Lime
- 5594' Lime & Shale
- 5660' Lime
- 5760' R.T.D.



RECEIVED  
STATE CORPORATION COMMISSION  
JUN 10 1974  
CONSERVATION DIVISION  
Wichita, Kansas

State Geological Survey  
WICHITA, BRANCH