

18-35-28W Selected 4/11/80
CONFIDENTIAL

KANSAS DRILLERS LOG

API No. 15 — 119 — 20,342
 County Number

Operator
Mesa Petroleum Company

Address
P. O. Box 2009 Amarillo, Texas

Well No. #2-18 Lease Name Adams

Footage Location
2646 feet from (N) (S) line 1000 feet from (E) (W) line

Principal Contractor Sage Drilling Co. Geologist Don Huber

Spud Date 12/13/78 Total Depth 6260' P.B.T.D. 6170'

Date Completed 1/22/79 Oil Purchaser Koch

S. 18 T. 35 R. 28 W.
 Loc. 1000' FSL & 2650' FNL
 County Meade

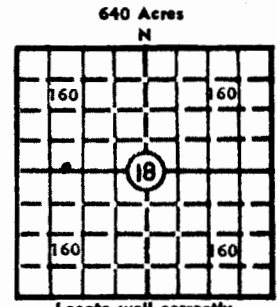

Elev.: Gr. 2291'
 DF 2300' KB 2302'

CASING RECORD

Report of all strings set — surface, intermediate, production, etc.

Purpose of string	Size hole drilled	Size casing set (in O.D.)	Weight lbs/ft.	Setting depth	Type cement	Sacks	Type and percent additives
Surface	12 1/2	8 5/8	24#	1490'	Lite H	600 200	2%CaCl 3%CaCl
Production	7 7/8	5 1/2	14 & 15.5	6266'	50:50 Poz H	315 50	18% salt 10% salt

LINER RECORD

PERFORATION RECORD

Top, ft.	Bottom, ft.	Sacks cement	Shots per ft.	Size & type	Depth interval
			1	.38" jet	5909-14 5928-36 (Chester)
			2	.38" jet	5826-38 (Morrow)

TUBING RECORD

Size	Setting depth	Packer set at
2 1/16"	5892	5892
2 1/16"	5566	--

ACID, FRACTURE, SHOT, CEMENT SQUEEZE RECORD

Amount and kind of material used	Depth interval treated
1300 gal 15% HCl, 4000 gal 28% foamed acid	5909-5936 (Chester)
1500 gal NE acid	5826-38 (Morrow)

INITIAL PRODUCTION

Date of first production <u>1/21/79 cleaning-up</u>	Producing method (flowing, pumping, gas lift, etc.) <u>Flowing</u>
RATE OF PRODUCTION PER 24 HOURS Oil --- bbls.	Gas Morrow 1305 Chester 1770 MCF bbls.
Disposition of gas (vented, used on lease or sold) <u>Vented</u>	Producing interval (s) Morrow 5826-38 Chester 5909-36

API # 15-114-20372
CONFIDENTIAL
RECEIVED
AMARILLO PRODUCTION

JAN 15 1979

JLF		GD	
SD		BC	
		TL	

DRILLERS LOG

ADAMS NO. 2-18

CASING RECORD:	OPERATOR: Mesa Petroleum Co.	DESCRIPTION:
8-5/8" set @ 1490' w/600 sax cement	CONTRACTOR: Sage Drilling Co., Inc.	1000'FWL & 2650'FNL
TOTAL DEPTH: 6260'	COMMENCED: December 13, 1978	Sec. 18-35S-28W Meade County, Kansas.
	COMPLETED: December 30, 1978	

<u>FORMATION</u>	<u>FROM</u>	<u>TO</u>	<u>REMARKS</u>
Surface Soil	0	1495	
Red Bed & Shale	1495	2475	
Lime & Shale	2475	4057	
Shale & Lime	4057	4209	
Lime & Shale	4209	5400	
Lime & Shale	5400	5868	
Lime & Shale	5868	6260	Ran DST#1; Ran DST#2; Logged Hole; 5½" set @ 6268' DV Tool @ 5315 ; Cemented w/total of 365 sax.