

State Geological Survey

WICHITA BRANCH
KANSAS DRILLERS LOG

15-119-20257
O 1-35-29W

API No. 15 — 119 — 20,257
County Number

S. 1 T. 35 R. 29 W
Loc. C NW NW
County Meade

Operator
Exxon Corporation

Address
P.O. Box 1600, Midland, Texas 79702

Well No. 2 Lease Name Adams Ranch

Footage Location
660 feet from (N) line 660 feet from (W) line

Principal Contractor Service Drilling Co. Geologist

Spud Date 5-5-77 Total Depth 4625 P.B.T.D.

Date Completed 6-28-77 Oil Purchaser ---

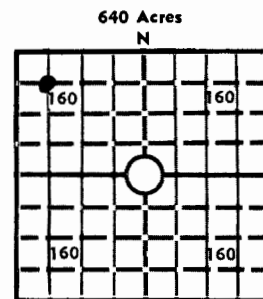

Locate well correctly
Elev.: Gr. 2431
DF 2438 KB 2440

CASING RECORD

Report of all strings set — surface, intermediate, production, etc.

Purpose of string	Size hole drilled	Size casing set (in O.D.)	Weight lbs/ft.	Setting depth	Type cement	Sacks	Type and percent additives
	12-1/4	8-5/8	24	1480	Com.	900	700 sx 8% gel, 2 Cal. Chlmide 200 sx 3 Cal. Chl.
		4-1/2	15.5 17	4625	Cl. H Neat	400	8% Gel
Pulled 3130' of 4-1/2" prior to plugging - Left 1485'							

LINER RECORD

PERFORATION RECORD

Top, ft.	Bottom, ft.	Sacks cement	Shots per ft.	Size & type	Depth interval
			1	3-1/8" csg. gum	4467-4489

TUBING RECORD

Size	Setting depth	Packer set at
Pulled all prior to P&A		

ACID, FRACTURE, SHOT, CEMENT SQUEEZE RECORD

Amount and kind of material used	Depth interval treated
7000 gal. 28% HCl, 35 bbl. KCl water	4467-4489
4000 gal. gelled KCl water pad, 3500 gal. 20% HCl, 7 Ball Sealers	4467-4489

INITIAL PRODUCTION

Date of first production None Producing method (flowing, pumping, gas lift, etc.) None

RATE OF PRODUCTION PER 24 HOURS	Oil	Gas	Water	Gas-oil ratio
	None bbls.	None MCF	--- bbls.	--- CFPB

Disposition of gas (vented, used on lease or sold) --- Producing interval (s) ---

INSTRUCTIONS: As provided in KCC Rule 82-2-125, within 90 days after completion of a well, one completed copy of this Drillers Log shall be transmitted to the State Geological Survey of Kansas, 4150 Monroe Street, Wichita, Kansas 67209. Copies of this form are available from the Conservation Division, State Corporation Commission, 3830 So. Meridian (P.O. Box 17027), Wichita, Kansas 66217. Phone AC 316-522-2206. If confidential custody is desired, please note Rule 82-2-125. Drillers Logs will be on open file in the Oil and Gas Division, State Geological Survey of Kansas, Lawrence, Kansas 66044.

Operator Exxon Corporation		DESIGNATE TYPE OF COMP.: OIL, GAS, DRY HOLE, SWDW, ETC.:
Well No. 2	Lease Name Adams Ranch	Dry Hole
S <u>1</u> T <u>35</u> R <u>29</u> ^X _W		

WELL LOG

Show all important zones of porosity and contents thereof; cored intervals, and all drill-stem tests, including depth interval tested, cushion used, time tool open, flowing and shut-in pressures, and recoveries.

SHOW GEOLOGICAL MARKERS, LOGS RUN, OR OTHER DESCRIPTIVE INFORMATION.

FORMATION DESCRIPTION, CONTENTS, ETC.	TOP	BOTTOM	NAME	DEPTH
Toronto Ls. Perf 4467-89 Tstd. water w/small amt. gas	4466	4592	Hebner Sh. Lansing Logs: DIG & CDL	4422 4592

USE ADDITIONAL SHEETS, IF NECESSARY, TO COMPLETE WELL RECORD.

Date Received	<p align="center"><i>Marvin Ochs</i> Signature</p> <p align="center">Unit Head Title</p> <p align="center">11-18-1977 Date</p>
---------------	--