

17-35-33W

STATE CORPORATION COMMISSION OF KANSAS
OIL & GAS CONSERVATION DIVISION
WELL COMPLETION OR RECOMPLETION FORM
ACO-1 WELL HISTORY

DESCRIPTION OF WELL AND LEASE

Operator: license # 5941
name Rosel Energy, Inc.
address P.O. Box 1823
City/State/Zip Liberal, KS 67901

Operator Contact Person George D. Rosel
Phone (316) 624-4994

Contractor: license # 5147
name BEREDCO, INC.

Wellsite Geologist Herb Deines
Phone (913) 625-3380

PURCHASER

Designate Type of Completion

New Well Re-Entry Workover

- Oil SWD Temp Abd
- Gas Inj Delayed Comp.
- Dry Other (Core, Water Supply etc.)

If () /O: old well info as follows:

Operator
Well Name
Comp. Date Old Total Depth

WELL HISTORY

Drilling Method: Mud Rotary Air Rotary Cable
4/26/86 5/5/86 5/7/86
Spurte Date Reached TD Completion Date

6900' 4900'
Total Depth PBTD

Ann of Surface Pipe Set and Cemented at 1585' feet

Multiple Stage Cementing Collar Used? Yes No

If Yes, Show Depth Set feet

If alternate 2 completion, cement circulated from feet depth to w/ SX cmt

API NO. 15 175-20,900
County Seward
NW NE Sec 17 Twp 35S Rge 33W
4,950 Ft North from Southeast Corner of Sec
2,310 Ft West from Southeast Corner of Sec
(Note: locate well in section plat below)

Lease Name Parsons-Jones Well# 2

Field Name

Producing Formation

Elevation: Ground 2846 KB 12'

Section Plat

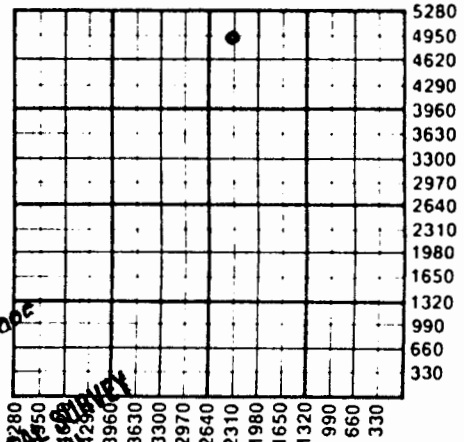

JUL 21 1986
KANSAS GEOLOGICAL SURVEY
WICHITA BRANCH

WATER SUPPLY INFORMATION

Division of Water Resources Permit #

Groundwater Ft North From Southeast Corner (Well) Ft West From Southeast Corn Sec Twp Rge East West

Surface Water Ft North From Southeast Corner (Stream, Pond etc.) Ft West From Southeast Corn Sec Twp Rge East West

Other (explain) (purchased from city, R.W.D.#)

Disposition of Produced Water: Disposal Repressuring

Docket #

INSTRUCTIONS: This form shall be completed in duplicate and filed with the Kansas Corporation Commission, 200 Colorado Derby Building Wichita, Kansas 67202, within 90 days after completion or recompletion of any well. Rules 82-3-130 and 82-3-107 apply.

Information on side two of this form will be held confidential for a period of 12 months if requested in writing and submitted with the form. See rule 82-3-11 for confidentiality in excess of 12 months.

One copy of all wireline logs and drillers time log shall be attached with this form. Submit CP-4 form with all plugged wells. Submit CP-111 form with all temporarily abandoned wells.

17-35-33W

SIDE TWO

Operator Name Rosel Energy Inc. Lease Name Parsons-Jones Well # 2 SEC. 17 TWP. 35S RGE. 33W East West

WELL LOG

INSTRUCTIONS: Show important tops and base of formations penetrated. Detail all cores. Report all drill stem tests giving interval tested, time tool open and closed, flowing and shut-in pressures, whether shut-in pressure reached static level, hydrostatic pressures, bottom hole temperature, fluid recovery, and flow rates if gas to surface during test. Attach extra sheet if more space is needed. Attach copy of log.

Drill Stem Tests Taken Yes No
 Samples Sent to Geological Survey Yes No
 Cores Taken Yes No

Formation Description
 Log Sample

Name	Top	Bottom
Sand & Red Bed	0'	1585'
RedBed & Shale	1585'	1720'
Lime & Shale	1720'	2870'
Dole	2870'	3450'
Lime & Shale	3450'	3960'
Shale & Lime	3960'	4165'
Lime & Shale	4165'	4565'
Shale & Lime	4565'	4648'
Lime & Shale	4648'	5000'
Shale & Lime	5000'	5200'
Lime & Shale	5200'	5515'
Shale & Lime	5515'	5700'
Lime & Shale	5700'	6060'
Shale & Lime	6060'	6255'
Lime & Shale	6255'	6470'
Shale & Lime	6470'	6620'
Lime & Shale	6620'	6860'
Shale & Lime	6860'	6900'

Making application for completion as SWDW.

TUBING RECORD size 2 3/8 set at packer at 2682 Liner Run Yes No

Date of First Production T A Producing method flowing pumping gas lift Other (explain)

Estimated Production Per 24 Hours	Oil	Gas	Water	Gas-Oil Ratio	Gravity
	Bbls	MCF	Bbls	CFPB	

Disposition of gas: vented sold used on lease

METHOD OF COMPLETION open hole perforation other (specify)

PRODUCTION INTERVAL

CASING RECORD new used

Report all strings set - conductor, surface, intermediate, production, etc.

Purpose of string	size hole drilled	size casing set (in O.D.)	weight lbs/ft.	setting depth	type of cement	# sacks used	type and percent additives
Surface	12-1/4"	8-5/8"	24#	1585'	Dowell Lite	530	2% CC
Production	7-7/8"	4-1/2"	10.5#	4590'	Class H	150	2% CC
					Cl. H.	75	1% CC, 10#D42
							10% salt

PERFORATION RECORD

shots per foot	specify footage of each interval perforated	Acid, Fracture, Shot, Cement Squeeze Record (amount and kind of material used)	Depth
2	4426-36, 4411-13, 4401-04	1000 gals. 20% HCL, 30% OF	at perfs
2	2710-13	1000 gals. 20% HCL	at perfs
2	2679-85	Squeeze 100sks., 1 1/2 bbls. per min., 1500#	
2	2654-64, 2644-50	8,000 gals. 20%	at perfs

17-35-33W

Handwritten initials

SIDE ONE

STATE CORPORATION COMMISSION OF KANSAS
OIL & GAS CONSERVATION DIVISION
WELL COMPLETION OR RECOMPLETION FORM
ACO-1 WELL HISTORY
DESCRIPTION OF WELL AND LEASE

Operator: License # 5941
Name ROSEL ENERGY, INC.
Address P.O. Box 1068
Liberal, KS 67901
City/State/Zip

Purchaser Phillips
waiting on tie in for gas sales

Operator Contact Person George D. Rosel
Phone 316-624-4994

Contractor: License # 5147
Name Beredco

Wellsite Geologist Herb Deines
Phone 913-625-3380

Designate Type of Completion
New Well Re-Entry Workover
Oil SWD Temp Abd
 Gas Inj Delayed Comp.
Dry Other (Core, Water Supply etc.)

If **OWWO**: old well info as follows:
Operator
Well Name
Comp. Date Old Total Depth

WELL HISTORY

Drilling Method:
 Mud Rotary Air Rotary Cable
4/26/86 5/5/86 5/7/86
Spud Date Date Reached TD Completion Date
6900' 4900'
Total Depth PBD

Amount of Surface Pipe Set and Cemented at 1585 feet
Multiple Stage Cementing Collar Used? Yes No
If yes, show depth set feet
If alternate 2 completion, cement circulated from feet depth to w/SX cmt
Cement Company Name
Invoice #

API NO. 15-175-20,900
County Seward
NW NW NE 17 35S 33W
Sec Twp Rge East West

4,950 Ft North from Southeast Corner of Section
2,310 Ft West from Southeast Corner of Section
(Note: Locate well in section plat below)

Lease Name Parsons-Jones Well # 2

Field Name

Producing Formation

Elevation: Ground 2846 KB 12'

Section Plat

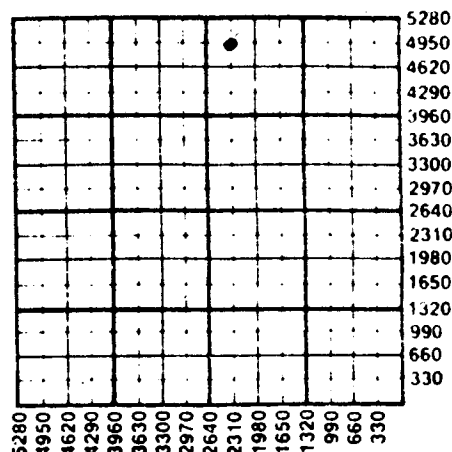

WATER SUPPLY INFORMATION

Disposition of Produced Water: Disposal
Docket # Repressuring

Questions on this portion of the ACO-1 call:

Water Resources Board (913) 296-3717

Source of Water:
Division of Water Resources Permit #

Groundwater Ft North from Southeast Corner (Well) Ft West from Southeast Corner of Sec Twp Rge East West

Surface Water Ft North from Southeast Corner (Stream, pond etc) Ft West from Southeast Corner Sec Twp Rge East West

Other (explain) (purchased from city, R.W.D. #)

INSTRUCTIONS: This form shall be completed in triplicate and filed with the Kansas Corporation Commission, 200 Colorado Derby Building, Wichita, Kansas 67202, within 120 days of the spud date of any well. Rule 82-3-130, 82-3-107 and 82-3-106 apply.

Information on side two of this form will be held confidential for a period of 12 months if requested in writing and submitted with the form. See rule 82-3-107 for confidentiality in excess of 12 months. One copy of all wireline logs and drillers time log shall be attached with this form. Submit CP-4 form with all plugged wells. Submit CP-111 form with all temporarily abandoned wells.

All requirements of the statutes, rules and regulations promulgated to regulate the oil and gas industry have been fully complied with and the statements herein are complete and correct to the best of my knowledge.

Signature *Ruth Gibson*

Title Secretary Date 7/15/87

Subscribed and sworn to before me this 15th day of July 1987

Notary Public Rhonda L. Bohannon

Date Commission Expires June 10, 1990

KANSAS GEOLOGICAL SURVEY PUBLIC - State of Kansas
WICHITA BRANCH RHONDA L. BOHANNAN
My Appt. Exp. 6-10-90

K.C.C. OFFICE USE ONLY
Letter of Confidentiality Attached
Wireline Log Received
Drillers Timelog Received
Distribution
KCC SWD/Rep NGPA
KGS Plug Other (Specify)
JUL 16 1987

Section 17, Twp 35, Rge 33 W

SIDE TWO

Operator Name **ROSEL ENERGY, INC.** Lease Name **Parsons-Jones** Well # **2**

2 Twp. **17** Rge. **35W** East West County **Seward**

WELL LOG

INSTRUCTIONS: Show important tops and base of formations penetrated. Detail all cores. Report all drill stem tests giving interval tested, time tool open and closed, flowing and shut-in pressures, whether shut-in pressure reached static level, hydrostatic pressures, bottom hole temperature, fluid recovery, and flow rates of gas to surface during test. Attach extra sheet if more space is needed. Attach copy of log.

Drill Stem Tests Taken Yes No
 Samples Sent to Geological Survey Yes No
 Cores Taken Yes No

Formation Description
 Log Sample

Name	Top	Bottom
Sand & Red Bed	0	1585
Red Bed & Shale	1585	1720
Lime & Shale	1720	2870
Dol	2870	3450
Lime & Shale	3450	3960
Shale & Lime	3960	6900

2-17S-35W
 17-35S-33W
 PARSONS-JONES #2

CASING RECORD <input checked="" type="checkbox"/> New <input type="checkbox"/> Used							
Report all strings set-conductor, surface, intermediate, production, etc.							
Purpose of String	Size Hole Drilled	Size Casing Set (in O.D.)	Weight Lbs/Ft.	Setting Depth	Type of Cement	#Sacks Used	Type and Percent Additives
Surf.	12 1/4	8 5/8	24#	1585	Lime	530	2%cc
Prod.	7 7/8	4 3/4	10.5	4590	ClSH	150	2%cc
					ClSH	75	1%cc

PERFORATION RECORD		Acid, Fracture, Shot, Cement Squeeze Record	
Shots Per Foot	Specify Footage of Each Interval Perforated	(Amount and Kind of Material Used)	Depth
2	4426-36, 4411-13, 4401-04	1000 gals 20%HCl, 30%OF	perfs.
2	2710-13	1000 gals 20%HCl	"
2	2679-85	Size 100 sks 1 bbls per	"
2	2654-64, 2644-50	1500#	"
		8000 gals 20%	"

TUBING RECORD	Size 2 3/8 Set At	Packer at 2682	Liner Run <input type="checkbox"/> Yes <input checked="" type="checkbox"/> No
---------------	-------------------	----------------	---

Date of First Production waiting on pipeline hookup _____ Producing Method Flowing Pumping Gas Lift Other (explain) _____

Estimated Production Per 24 Hours	Oil Bbls	Gas MCF	Water Bbls	Gas-Oil Ratio CFPB	Gravity
		50MCFPD	50BPD		

METHOD OF COMPLETION

Production Interval

Disposition of gas: Vented Open Hole Perforation
 Solid Other (Specify) _____
 Used on Lease Dually Completed _____
 Commingled _____

***Waiting on pipeline hookup for gas sales.

17-32-33m