

# WELL COMPLETION REPORT AND DRILLER'S LOG

State Geological Survey  
WICHITA BRANCH

1-35-35W

API No. 15 — 189 — 20492  
County Number

S. 1 T. 35 R. 35 E. W

Loc. C-SW

County Stevens

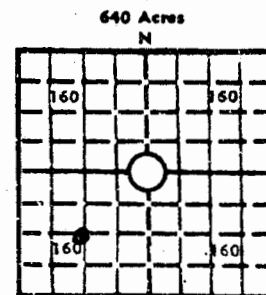

Elev.: Gr. 2954'

DF KB

Operator  
Southland Royalty Company

Address  
2900 Liberty Tower, Okla. City, OK 73102

Well No. 1-1  
Lease Name Littell

Footage Location  
1320 feet from NW (S) line 1320 feet from SE (W) line

Principal Contractor Lohmann & Johnson  
Geologist Art Moore

Spud Date 9-28-80  
Date Completed 12-9-80  
Total Depth 6750'  
P.S.T.D. 6540'

Directional Deviation None  
Oil and/or Gas Purchaser Northern Nat'l Gas Co.

## CASING RECORD

Report of all strings set—surface, intermediate, production, etc.

Purpose of string	Size hole drilled	Size casing set (in O.D.)	Weight lbs./ft.	Setting depth	Type cement	Sacks	Type and percent additives
Surface	12-1/4"	8-5/8"	24	1629	POZ Class H	400	
Production	7-7/8"	4-1/2"	10.5	6749	Class H	400	

## LINER RECORD

## PERFORATION RECORD

Top, ft.	Bottom, ft.	Sacks cement	Shots per ft.	Size & type	Depth interval
			2 SPF	.45"	6303-6315'
			2 SPF	.45"	6375-6392'
Size	Setting depth	Packer set at			
2-3/8"	6461'				

## ACID, FRACTURE, SHOT, CEMENT SQUEEZE RECORD

Amount and kind of material used	Depth interval treated
2000 gals 15% NEA, 30,000 gals gelled 3% acid + 30,000# 20/40sd	6303-6315'
Frac'd w/8,000 gals 15% acid + 13,000 gals gelled fresh water	6375-6392'

## INITIAL PRODUCTION

Date of first production 5-12-81	Producing method (flowing, pumping, gas lift, etc.) Flowing
RATE OF PRODUCTION PER 24 HOURS	Oil 0 bbls. Gas 1.334 MCF Water 0 bbls. Gas-oil ratio ----- CFPB
Disposition of gas (vented, used on lease or sold) Sold	Producing interval (s) Morrow 6303-6315'

INSTRUCTIONS: As provided in KCC Rule 82-2-125, within 90 days after completion of a well, one completed copy of this Drillers Log shall be transmitted to the State Geological Survey of Kansas, 4150 Monroe Street, Wichita, Kansas 67209. Copies of this form are available from the Conservation Division, State Corporation Commission, 245 No. Water, Wichita, Kansas 67202. Phone AC 316-522-2206. If confidential custody is desired, please note Rule 82-2-125. Drillers Logs will be on open file in the Oil and Gas Division, State Geological Survey of Kansas, Lawrence, Kansas 66044.

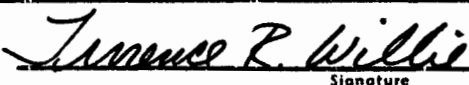
Operator Southland Royalty Company		DESIGNATE TYPE OF COMP.: OIL, DRY HOLE, SWDW, ETC.: <b>GAS</b>	
Well No. 1-1	Lease Name Littell		
S <u>1</u> T <u>35</u> R <u>35</u> <del>R</del> W			
<b>WELL LOG</b>		SHOW GEOLOGICAL MARKERS, LOGS RUN, OR OTHER DESCRIPTIVE INFORMATION.	
Show all important zones of porosity and contents thereof; cored intervals, and all drill-stem tests, including depth interval tested, cushion used, time tool open, flowing and shut-in pressures, and recoveries.			
FORMATION DESCRIPTION, CONTENTS, ETC.	TOP	BOTTOM	NAME
Council Grove	2992		
Toronto	4348		
Lansing	4470		
Base 13 Finger	5958		
L. Morrow Sd.	6290		
Chester	6434		
USE ADDITIONAL SHEETS, IF NECESSARY, TO COMPLETE WELL RECORD.			
Date Received	<div style="text-align: center;">             Signature            Terrence R. Willie, District Engineer            Title            June 16, 1981            Date         </div>		