

STATE CORPORATION COMMISSION OF KANSAS
OIL & GAS CONSERVATION DIVISION
WELL COMPLETION OR RECOMPLETION FORM
DATE: JAN 1988
ACCT WELL HISTORY
FROM CONFIDENTIAL
DESCRIPTION OF WELL AND LEASE

Operator: license # 5153
name Texaco Inc.
address Box 2420
City/State/Zip Tulsa, Ok 74102

Operator Contact Person T. C. Williams III
Phone 316-792-2193

Contractor: license #
name H-30 Inc. 251 N. Water,
Wichita, Ks

Well Geologist Kim Moore-Texaco, Inc. - Denver
Phone 303-793-4461

PURCHASER To be furnished later

Designate Type of Completion

New Well Re-Entry Workover

- SWD Temp Abd Gas Inj Delayed Comp. Dry Other (Core, Water Supply etc.)

NO: old well info as follows:

Operator
Well Name
Comp. Date Old Total Depth

WELL HISTORY

Drilling Method: Mud Rotary Air Rotary Cable
9/23/86 10/6/86 11/1/86
Spud Date Date Reached TD Completion Date

629' 6440'
Total Depth PBD

Amount of Surface Pipe Set and Cemented at 1769' feet

Mud Stage Cementing Collar Used? Yes No

If Yes, Show Depth Set feet

If alternate 2 completion, cement circulated from surface feet depth to 1768 w/ 720 SX cmt

API NO. 15-189-20928

County Stevens

NE NE SW Sec 3 Twp 35S Rge 35 East
(location)

2310 Ft North from Southeast Corner of Section
2970 Ft West from Southeast Corner of Section
(Note: locate well in section plat below)

Lease Name Mary Grizzell Well# 1

Field Name Wide Awake

Producing Formation Morrow

Elevation: Ground 2975' KB 2987'

Section Plat

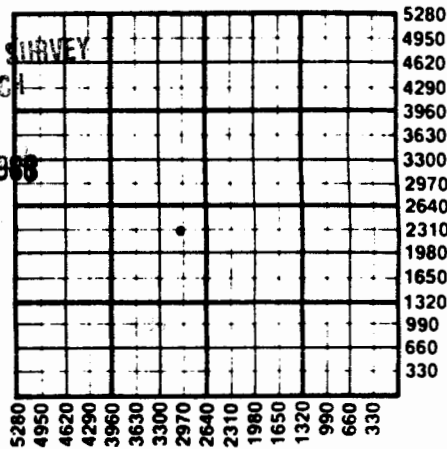

KANSAS GEOLOGICAL SURVEY
WICHITA BRANCH

JAN 16 1988

WATER SUPPLY INFORMATION

Source of Water: NA

Division of Water Resources Permit #

Groundwater Ft North From Southeast Corner and
(Well) Ft. West From Southeast Corner of
Sec Twp Rge East West

Surface Water Ft North From Southeast Corner and
(Stream, Pond etc.) Ft West From Southeast Corner
Sec Twp Rge East West

Other (explain) (purchased from city, R.W.D.#)

Disposition of Produced Water: Disposal Repressuring

Docket #

INSTRUCTIONS: This form shall be completed in duplicate and filed with the Kansas Corporation Commission, 200 Colorado Derby Building, Wichita, Kansas 67202, within 90 days after completion or recompletion of any well. Rules 82-3-130 and 82-3-107 apply.

Information on side two of this form will be held confidential for a period of 12 months if requested in writing and submitted with the form. See rule 82-3-107 for confidentiality in excess of 12 months.

One copy of all wireline logs and drillers time log shall be attached with this form. Submit CP-4 form with all plugged wells. Submit CP-111 form with all temporarily abandoned wells.

SIDE TWO

Operator Name **Texaco Inc.** Lease Name **Mary** Well# **1** SEC **3** TWP. **35S** RGE. **35** East West
Grizzell

WELL LOG

INSTRUCTIONS: Show important tops and base of formations penetrated. Detail all cores. Report all drill stem tests giving interval tested, time tool open and closed, flowing and shut-in pressures, whether shut-in pressure reached static level, hydrostatic pressures, bottom hole temperature, fluid recovery, and flow rates if gas to surface during test. Attach extra sheet if more space is needed. Attach copy of log.

Drill Stem Tests Taken Yes No
 Samples Sent to Geological Survey Yes No
 Cores Taken Yes No *Re-Run*

Formation Description
 Log Sample

Redbed Surface - 1300
 Lime/Shale 1300 - 1768
 Shale/Sand 1768 - 2242
 Shale/Lime 2242 - 6859 TD

Name	Top	Bottom
Chase	2678	
Neva	3292	
Topeka	4092	
Toronto	4357	
Lansing	4458	
KC	4897	
Marmaton	5206	
Cherokee	5474	
13 Finger Lime	5876	
Morrow	5979	
B. Morrow Sd	6270	
Chester	6289	
St Louis	6744	
TD		

TUBING RECORD size 2-7/8" set at 6201 packer at 6201		Liner Run <input type="checkbox"/> Yes <input checked="" type="checkbox"/> No	
Date of First Production 10-15-86	Producing method <input type="checkbox"/> flowing <input type="checkbox"/> pumping <input type="checkbox"/> gas lift <input checked="" type="checkbox"/> Other (explain) ... Swab		
Estimated Production Per 24 Hours 11-1-86	Oil Trace Bbls	Gas 2.117 MCF	Water Trace Bbls
			Gas-Oil Ratio CFPB
			Gravity

Disposition of gas: vented sold used on lease
 METHOD OF COMPLETION: open hole perforation other (specify) _____
 PRODUCTION INTERVAL: **6272-83**
 Dually Completed.
 Commingled

CASING RECORD <input checked="" type="checkbox"/> new <input type="checkbox"/> used							
Report all strings set - conductor, surface, intermediate, production, etc.							
Purpose of string	size hole drilled	size casing set (in O.D.)	weight lbs/ft.	setting depth	type of cement	# sacks used	type and percent additives
Surface	12-1/4	9-5/8"	43#	1768	C1 H	720	10% salt; 3% CC
Production	7-7/8	5-1/2	17#	6857	pozmix	580	10% salt; 3% CC

PERFORATION RECORD		Acid, Fracture, Shot, Cement Squeeze Record	
shots per foot	specify footage of each interval perforated	(amount and kind of material used)	Depth
2	6518-22'	2000 gal 15% NEA	6518-22'
2	6272-83'	700 gals 15% NEA	6272-83'