

7-35-39W

**KANSAS DRILLERS LOG**

STATE Geological Survey  
WICHITA BRANCH

S. 7 T. 35S R. 39  W  
Loc. SW/4  
County Morton

API No. 15 — 129 — 20432 — 20435  
County Number

Operator  
**Mobil Oil Corporation ATTN. L.C. Case**

Address  
**P.O. Box 5444 Denver, CO 80217**

Well No. 2 Lease Name Mingenback Unit

Footage Location  
1250 feet from  (S) line 1250 feet from  (W) line

Principal Contractor **Earl F. Wakefield, Inc.** Geologist **P. B. Nichols**

Spud Date 3-27-80 Total Depth 3120' P.B.T.D. 3090'

Date Completed 4-22-80 Div/Purchaser GAS  
**Northern Natural Gas Co.**

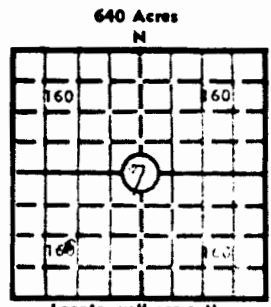

Locate well correctly  
Elev.: Gr. 3323'  
DF \_\_\_\_\_ KB 3331'

**CASING RECORD**

Report of all strings set — surface, intermediate, production, etc.

Purpose of string	Size hole drilled	Size casing set (in O.D.)	Weight lbs./ft.	Setting depth	Type cement	Sacks	Type and percent additives
Surface Casing	12 1/4"	8-5/8"	24#	558'	Class H Reg	150	12% gel + 3% CaCl <sub>2</sub>
Production Casing	7-7/8"	5 1/2"	14#	3120'	Howco Lite	500	1/4#/flocel
					Class H Reg	150	18% salt + .75% CFI

**LINER RECORD**

**PERFORATION RECORD**

Top, ft.	Bottom, ft.	Sacks cement	Shots per ft.	Size & type	Depth interval
			2		2908-13
			2		2917-23
			2		2931-42
			2		2952-68

**TUBING RECORD**

Size	Setting depth	Pecker set at
2-3/8"	2983'	

**ACID, FRACTURE, SHOT, CEMENT SQUEEZE RECORD**

Amount and kind of material used	Depth interval treated
6000 gal 15% HCl acid + additives + 85 ball sealers.	2908-2968
76,000 gal of fresh gelled water containing 228,000# of 20/40 frac sand + additives	

**INITIAL PRODUCTION**

Date of first production <u>6-16-80</u>	Producing method (flowing, pumping, gas lift, etc.) <u>Pumping</u>
RATE OF PRODUCTION PER 24 HOURS	Oil Gas Water Gas-oil ratio
	bbbls. <u>1 pt OFP 1200 MCF</u> bbbls. _____ CFPB
Disposition of gas (vented, used on lease or sold) <u>Sold</u>	Producing interval (s) <u>2908-2968'</u>

INSTRUCTIONS: As provided in KCC Rule 82-2-125, within 90 days after completion of a well, one completed copy of this Drillers Log shall be transmitted to the State Geological Survey of Kansas, 4150 Meares Street, Wichita, Kansas 67209. Copies of this form are available from the Conservation Division, State Corporation Commission, 3830 So. Meridian (P.O. Box 17027), Wichita, Kansas 66217. Phone AC 316-522-2206. If confidential custody is desired, please note Rule 82-2-125. Drillers Logs will be on open file in the Oil and Gas Division, State Geological Survey of Kansas, Lawrence, Kansas 66044.

Operator Mobil Oil Corporation DESIGNATE TYPE OF COMP.: OIL, GAS, DRY HOLE, SWDW, ETC.:

Well No. 2 Lease Name Mingenback Unit Gas

s 7 T35S R 39 <sup>XX</sup> W

**WELL LOG**

Show all important zones of porosity and contents thereof; cored intervals, and all drill-stem tests, including depth interval tested, cushion used, time tool open, flowing and shut-in pressures, and recoveries.

SHOW GEOLOGICAL MARKERS, LOGS RUN, OR OTHER DESCRIPTIVE INFORMATION.

FORMATION DESCRIPTION, CONTENTS, ETC.	TOP	BOTTOM	NAME	DEPTH
Sand & Clay	0	500	Stone Corral	1675'
Red Bed	500	1110	Chase	2575'
Gyp & Red Bed	1110	1215	Council Grove	2903'
Sand	1215	1390		
Gyp & Shale	1390	1600	TOTAL DEPTH	3120'
Red Bed & Shale	1600	1730		
Anhydrite	1730	1737		
Shale & Shells	1737	1825		
Red Bed	1825	2200		
Shale & Lime	2200	2440		
Shale & Shells	2440	2615		
Shale & Lime	2615	2790		
Lime & Shale	2790	2920		
Shale & Shells	2920	3030		
Lime & Shale	3030	3120		
TOTAL DEPTH		3120		

USE ADDITIONAL SHEETS, IF NECESSARY, TO COMPLETE WELL RECORD.

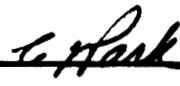
Date Received	 <b>C. J. PARK</b> <small>Signature</small> <b>Producing Accounting Supervisor</b> <small>Title</small> <b>6-26-80</b> <small>Date</small>
---------------	--------------------------------------------------------------------------------------------------------------------------------------------------------------------------------------------------------------------------------------------------

2nd  
PI

State Geological Survey  
WICHITA BRANCH  
7-35-39W

KANSAS DRILLER'S LOG

LEASE: MINGENBACK UNIT #2  
OWNER: MOBIL OIL CORPORATION  
CONT: EARL F. WAKEFIELD, INC.  
SPUD: 3-27-80  
COMP: 4-8-80

LOCATION: SW/4  
SECTION 7-35S-39W  
MORTON COUNTY, KANSAS  
CASING: 8 5/8" SET @ 558'  
5 1/2" SET @ 3120'

Sand & Clay	500
Red Bed	1110
Gyp & Red Bed	1215
Sand	1390
Gyp & Shale	1600
Red Bed & Shale	1730
Anhydrite	1737
Shale & Shells	1825
Red Bed	2200
Shale & Lime	2440
Shale & Shells	2615
Shale & Lime	2790
Lime & Shale	2920
Shale & Shells	3030
Lime & Shale	3120
R.T.D.	3120

STATE OF KANSAS )  
                  ) ss.  
COUNTY OF SEDGWICK )

I, William C. Wakefield, do hereby certify that this is a true and correct log on the MINGENBACK UNIT #2, located SW/4 SECTION 7-35S-39W, MORTON COUNTY.