

KANSAS

WELL COMPLETION REPORT AND DRILLER'S LOG WICHITA BRANCH

S. 4 T. 35S R. 43 W Loc. 30' N & E of C SW/4

API No. 15 129 20,416 County Number

County Morton

Operator: Anadarko Production Company
Address: P. o. Box 351, Liberal, Kansas 67901
Well No. 2 Lease Name MOORE "C"
Footage Location: 690 feet from HH (S) line, 690 feet from OE (W) line
Principal Contractor: Gabbert-Jones, Inc. Geologist: NA
Spud Date: 11/6/79 Date Completed: 6/19/81 Total Depth: 4850' P.B.T.D.: 1445'
Directional Deviation: not applicable Oil and/or Gas Purchaser: DRY HOLE

RELEASED

Date: MAY 28 1982

FROM CONFIDENTIAL

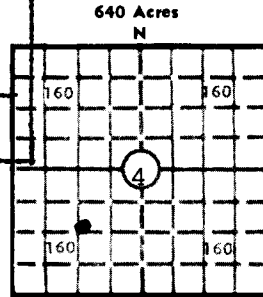

Elev.: Gr. 3564.6
DF 3568.6 KB 3569.6

CASING RECORD

Report of all strings set — surface, intermediate, production, etc.

Table with 8 columns: Purpose of string, Size hole drilled, Size casing set (in O.D.), Weight lbs/ft., Setting depth, Type cement, Sacks, Type and percent additives. Rows include Surface and Production strings with details on cement types like Pozmix, Litewate, and CFR-2.

LINER RECORD

PERFORATION RECORD

Tables for Liner and Perforation records. Liner record has columns: Top, ft., Bottom, ft., Sacks cement. Perforation record has columns: Shots per ft., Size & type, Depth interval. Tubing record has columns: Size, Setting depth, Packer set at.

ACID, FRACTURE, SHOT, CEMENT SQUEEZE RECORD

Table with 2 columns: Amount and kind of material used, Depth interval treated. Lists materials like A/800 gal 15% DS-30, F/20,000 gal Titial III, and various BS treatments.

INITIAL PRODUCTION

Date of first production: DRY HOLE Producing method (flowing, pumping, gas lift, etc.)

Table with 5 columns: RATE OF PRODUCTION PER 24 HOURS, Oil (bbls.), Gas (MCF), Water (bbls.), Gas-oil ratio (CFPB).

Disposition of gas (vented, used on lease or sold) Producing interval (s)

INSTRUCTIONS: As provided in KCC Rule 82-2-125, within 90 days after completion of a well, one completed copy of this Drillers Log shall be transmitted to the State Geological Survey of Kansas, 4150 Monroe Street, Wichita, Kansas 67209.

Paul Campbell = Liberal

Operator Anadarko Production Company		DESIGNATE TYPE OF COMP.: OIL, GAS, DRY HOLE, SWDW, ETC.:
Well No. 2	Lease Name MOORE "C"	DRY HOLE
S <u>4</u> T <u>35S</u> R <u>43W</u> ^E _W		

AUG

WELL LOG

Show all important zones of porosity and contents thereof; cored intervals, and all drill-stem tests, including depth interval tested, cushion used, time tool open, flowing and shut-in pressures, and recoveries.

SHOW GEOLOGICAL MARKERS, LOGS RUN, OR OTHER DESCRIPTIVE INFORMATION.

FORMATION DESCRIPTION, CONTENTS, ETC.	TOP	BOTTOM	NAME	DEPTH
Surface Clay, Sand, Redbed	0'	290'	LOGS: SCHLUMBERGER Compensated Neutron- Formation Density Dual Induction-SFL	
Redbed, Sand	290'	825'		
Redbed, Anhydrite	825'	1272'		
Redbed, Anhydrite, Sand	1272'	1402'		
Shale, Lime	1402'	1810'		
Shale, Shale w/Lime	1810'	2242'		
Lime, Shale	2242'	4850'		
TD		4850'		
DST #1 20-30-30-100, op w/vry wk blow, no blow on second open, rec 10' DM, IFP 33-33, ISIP 166 (30), FFP 33-33, FSIP 595 (100), HP 2100-2067.				

USE ADDITIONAL SHEETS, IF NECESSARY TO COMPLETE WELL RECORD.

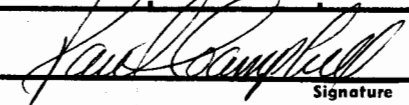
Date Received	
	Signature
	Paul Campbell, Division Operations Manager
	Title
	July 13, 1981
	Date