

State Geological Survey
WICHITA, BRANCH

15-35-43W

KANSAS DRILLERS LOG

S. 15 T. 35S R. 43 ^W

API No. 15 — 129 — 20,180
County Number

Loc. NW SE

County Morton

Operator
Anadarko Production Company

Address
Box 351, Liberal, Kansas 67901

Well No. #1 Lease Name Pritchett "C"

Footage Location
1980 feet from (S) line 1980 feet from (E) EW line

Principal Contractor Gabbert-Jones, Inc. Geologist

Spud Date 3-27-75 Total Depth 4355' P.B.T.D.

Date Completed 6-5-75 Oil Purchaser

640 Acres
N

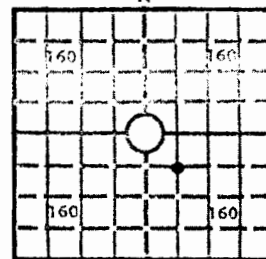

Elev.: Gr. 3653.80'

DF _____ KB _____

CASING RECORD

Report of all strings set — surface, intermediate, production, etc.

Purpose of string	Size hole drilled	Size casing set (in O.D.)	Weight lbs/ft.	Setting depth	Type cement	Sacks	Type and percent additives
Surface	12-1/4"	8-5/8"	23#	1377'	Pozmix Common	500 200	4% gel 2% CC 2% CC
Production	7-7/8"	5-1/2"	14#	4354	Pozmix	350	0.5% CFR-2

LINER RECORD

PERFORATION RECORD

Top, ft.	Bottom, ft.	Sacks cement	Shots per ft.	Size & type	Depth interval
TUBING RECORD			4 SPF		4270-72'
Size	Setting depth	Packer set at	2 SPF		4258-70'
2-3/8"	4276'				

ACID, FRACTURE, SHOT, CEMENT SQUEEZE RECORD

Amount and kind of material used	Depth interval treated
Acidized w/500 gallons 7-1/2% NE + 10 ball sealers.	4270-72'
Fraced w/10,000 gallons geled lease crude + 10,000# 10-20 sand.	4258-70'

INITIAL PRODUCTION

Date of first production <u>6-5-75</u>	Producing method (flowing, pumping, gas lift, etc.) <u>Pumping</u>		
RATE OF PRODUCTION PER 24 HOURS	Oil <u>63</u> bbls.	Gas <u> </u> MCF	Water <u> </u> bbls.
Disposition of gas (vented, used on lease or sold) <u>Used on lease</u>		Producing interval (s) <u>4258-72' Morrow</u>	
		Gas-oil ratio <u> </u> CFPB	

INSTRUCTIONS: As provided in KCC Rule 82-2-125, within 90 days after completion of a well, one completed copy of this Drillers Log shall be transmitted to the State Geological Survey of Kansas, 4150 Monroe Street, Wichita, Kansas 67209. Copies of this form are available from the Conservation Division, State Corporation Commission, 3830 So. Meridian (P.O. Box 17027), Wichita, Kansas 66217. Phone AC 316-522-2206. If confidential custody is desired, please note Rule 82-2-125. Drillers Logs will be on open file in the Oil and Gas Division, State Geological Survey of Kansas, Lawrence, Kansas 66044.

Operator Anadarko Production Company		DESIGNATE TYPE OF COMP.: OIL, GAS, DRY HOLE, SWDW, ETC.:
Well No. #1	Lease Name Pritchett "C"	Oil
S 15 T 35S R 43 EX W		

WELL LOG

Show all important zones of porosity and contents thereof; cored intervals, and all drill-stem tests, including depth interval tested, cushion used, time tool open, flowing and shut-in pressures, and recoveries.

SHOW GEOLOGICAL MARKERS, LOGS RUN, OR OTHER DESCRIPTIVE INFORMATION.

FORMATION DESCRIPTION, CONTENTS, ETC.	TOP	BOTTOM	NAME	DEPTH
Surface Sand-Clay	0	390		
Redbed-Anhy	390	844		
Redbed-Anhy-Sand	844	1094		
Redbed	1094	1360		
Anhy	1360	1379		
Shale-Anhy	1379	1680		
Shale	1680	2080		
Shale-Anhy	2080	2360		
Shale-Lime	2360	2590		
Lime-Shale	2590	4082		
Lime	4082	4163		
Lime-Shale	4163	4355		
Total Depth		4355		



USE ADDITIONAL SHEETS, IF NECESSARY, TO COMPLETE WELL RECORD.

Date Received	<i>T. W. Williams</i> T. W. Williams Signature Division Office Supervisor Title
	June 19, 1975 Date

KANSAS DRILLERS LOG

S. 15 T. 35S R. 43W $\frac{2}{W}$

API No. 15 — 129 — 20,180
County Number

Loc. C NW SE

County Morton

Operator

Anadarko Production Company

Address

P. O. Box 351, Liberal, Kansas 67901

Well No.

1

Lease Name

PRITCHETT "C"

Footage Location

1980 feet from ~~SW~~ (S) line

1980 feet from (E) ~~SW~~ line

Principal Contractor

Gabbert-Jones, Inc.

Geologist

Spud Date

3-27-75

Total Depth

4355'

P.B.T.D.

4292'

Date Completed

6-5-75, Duald 7-19-78

Oil Purchaser

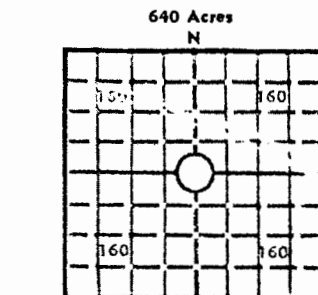

Locate well correctly

Elev.: Gr. 3653.80'

DF _____ KB _____

CASING RECORD

Report of all strings set — surface, intermediate, production, etc.

Purpose of string	Size hole drilled	Size casing set (in O.D.)	Weight lbs/ft.	Setting depth	Type cement	Sacks	Type and percent additives
Surface	12-1/4"	8-5/8"	23#	1377'	Pozmix Common	500 200	4% gel 2% CC 2% CC
Production	7-7/8"	5-1/2"	14#	4354'	Pozmix	350	0.5% CFR-2

LINER RECORD

PERFORATION RECORD

Top, ft.	Bottom, ft.	Sacks cement	Shots per ft.	Size & type	Depth interval
			2 SPF		3112-3118
Size 2-3/8"	Setting depth 4223'	Packer set at 4238'			
1-1/4"	4237'				

ACID, FRACTURE, SHOT, CEMENT SQUEEZE RECORD

Amount and kind of material used	Depth interval treated
1,000 gals 15% FE Acid	3112-3118'
10,000 SCF N ₂ + 2,000 gals MRS 100 acid w/500 SCF/BBL N ₂	3112-3118'

INITIAL PRODUCTION

Date of first production	Producing method (flowing, pumping, gas lift, etc.)				
7-19-78	Flowing				
RATE OF PRODUCTION PER 24 HOURS	Oil	Gas	Water	Gas-oil ratio	
	bbls.	501 MCF		bbls.	CFPB
Disposition of gas (vented, used on lease or sold)				Producing interval (s)	
Sold					

INSTRUCTIONS: As provided in KCC Rule 82-2-125, within 90 days after completion of a well, one completed copy of this Drillers Log shall be transmitted to the State Geological Survey of Kansas, 4150 Monroe Street, Wichita, Kansas 67209. Copies of this form are available from the Conservation Division, State Corporation Commission, 3830 So. Meridian (P.O. Box 17027), Wichita, Kansas 66217. Phone AC 316-522-2206. If confidential custody is desired, please note Rule 82-2-125. Drillers Logs will be on open file in the Oil and Gas Division, State Geological Survey of Kansas, Lawrence, Kansas 66044.

NOTE: Drillers Log for Morrow zone submitted June 19, 1975.

Operator
Anadarko Production Company

Well No. 1

Lease Name "C" PRITCHETT

Dual Oil and Gas

S 15 T355 R 43 W

DESIGNATE TYPE OF COMP.: OIL, GAS, DRY HOLE, SWDW, ETC.

Date Received

Signature Paul Campbell
Division Production Manager

Title
October 10, 1978

Date

USE ADDITIONAL SHEETS, IF NECESSARY, TO COMPLETE WELL RECORD.

FORMATION DESCRIPTION, CONTENTS, ETC.	TOP	BOTTOM	NAME	DEPTH
Surface Sand-Clay	0	390		390
Redbed-Anhy	390	844		844
Redbed-Anhy-Sand	844	1094		1094
Redbed	1094	1360		1360
Anhy	1360	1379		1379
Shale-Anhy	1379	1680		1680
Shale	1680	2080		2080
Shale-Anhy	2080	2360		2360
Shale-Lime	2360	2590		2590
Lime-Shale	2590	4082		4082
Lime	4082	4163		4163
Lime-Shale	4163	4355		4355
Total Depth		4355		4355

WELL LOG

Show all important zones of porosity and contents thereof; cored intervals, and all drill-stem tests, including depth interval tested, cushion used, time tool open, flowing and shut-in pressures, and recoveries.

SHOW GEOLOGICAL MARKERS, LOGS RUN, OR OTHER DESCRIPTIVE INFORMATION.