

DX 78-1

Norton **KANSAS**

Section 30 Township 3 Range 23 W
Well No. # 3 Horning
Company Harry Gore

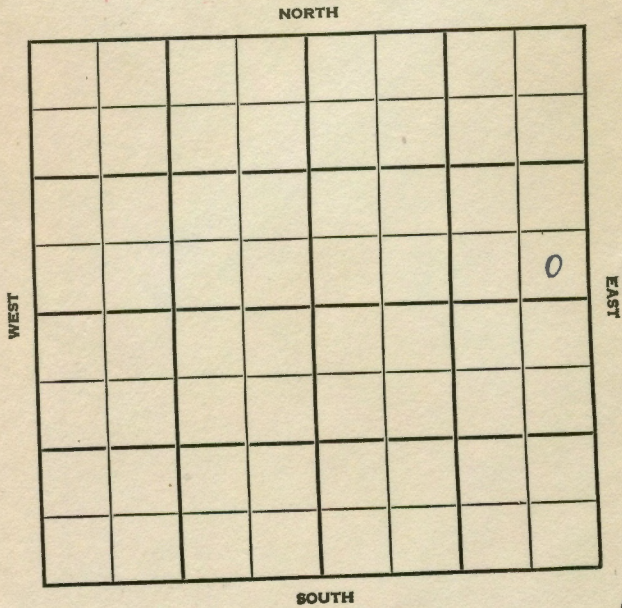

8

Norton **KANSAS**

SEC. 30 TWP. 3 R. 23W

WELL NO. #3 Horning FARM

COMPANY Harry Gore

CONTRACTOR

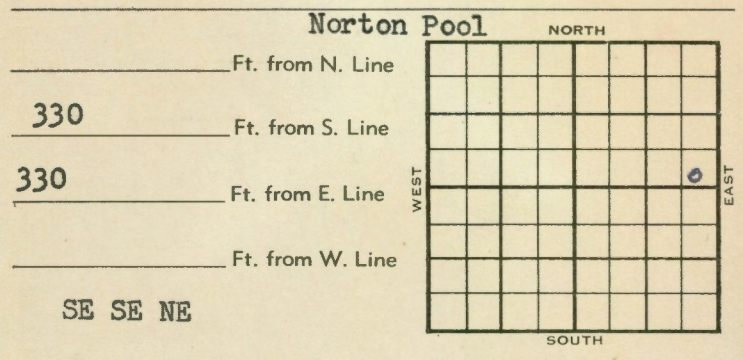

	ELEVATION	REPORT
1954	2442'	
9/15	Location	
12/1	Spud 9-21-54 - Oil Well	
	TD 3766'	
	8" @ 293'	
	Anhy 2040', Heeb 3486', Tor. 3513',	
	Lans 3529', B KC 3708', Arb. 3760'	
	TD 3766'	
	5" @ 3762'	
	CO to 3766', 1000A	
	P/120 bo 10 hrs.	
	Comp. 374 bopd	
	COMPLETED	

DX-78

