

Section 35 Township 3 Range 24W
 Well No. 8 Schoen
 Company Derby Oil

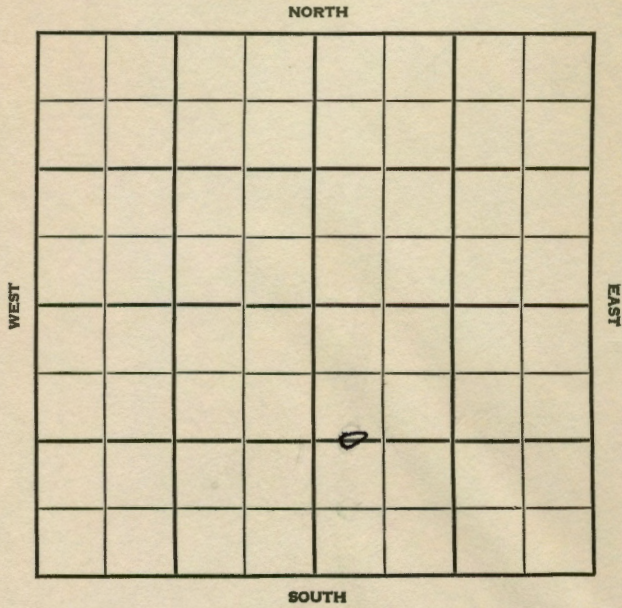

SEC. 35 TWP. 3 R. 24W **KANSAS**
 WELL NO. #8 Schoen FARM
 COMPANY Derby Oil
 CONTRACTOR Glenn Peel

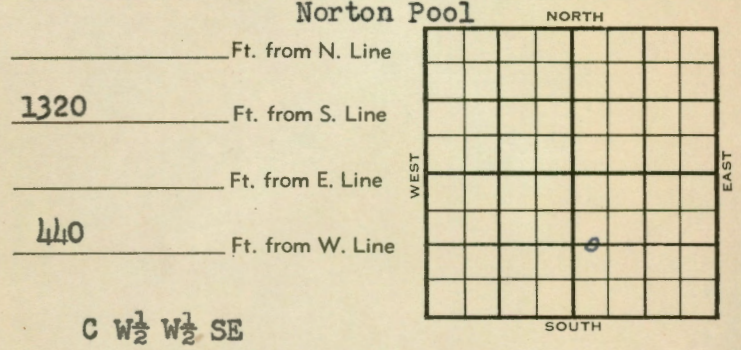

	ELEVATION	REPORT
1954	2456'	
5/26	Spud 5-22-54 8" @ 316' Drlg 2380'	
6/2	H _{eeb} 3476 L _{ans} 3518 Arb. 3775 DST 3757-79, 3/4 hr, 435' gas, 70' hvly OCM, 110' MCO, 105' clean oil, 760# RTD 3779' 5" @ 3776'	
6/9	RUST	
6/23	RUCT	
6/30	"	
7/7	"	
7/14	Spud 5-22-54 Oil well TD 3779 8" @ 316' H _{eeb} 3476 L _{ans} 3518 Arb. 3775 DST 3757-79 open 3/4 hr, rec 435' gas 70' HOCM, 110' MCO, 105' clean oil 760# TD 3779 5" @ 3776 CO to 3779 6 BOPH 10 hr. 500 A S/10 BO 1 hr. S/12 BO 3rd hr. Comp. 149 BOPD	
		COMPLETED

County Norton State Kansas
 Sec. 35 (Blk. 3 (Sur. 24W Map No.
 Operator Derby Oil
 Well No. 8 Farm Schoen
 Elev. 2456 Location C W $\frac{1}{2}$ W $\frac{1}{2}$ SE

COMPLETE

1320 Ft. From S Line SE
440 Ft. From W Line Quarter
 Ist. Report _____
 Completion JUL 14 1954
 Remarks Norton Pool
Glenn Peel - Contr.
 Spudding Date 5-22-54

Drig. Data Oil well TD 3779
8" @ 316 Heeb. 3476 Lans. 3518
 Arb. 3775 DST 3757-79 open 3/4 hr.
 Rec. 435' gas 70' hocom 110' mco
105' clean oil 760# TD 3779 5" @ 3776
CO to 3779 6 boph 10 hr. 500 A
S/ 10 bo 1 hr. S/ 12 bo 3rd hr.
 Comp. 149 bopd

J. G. McGEHEE

County Norton State Kansas
 Sec. 35 (Blk. 3 (Sur. 24W Map No.
 Operator Derby Oil
 Well No. 8 Farm Schoen
 Elev. _____ Location C W $\frac{1}{2}$ W $\frac{1}{2}$ SE

FIRST REPORT

1320 Ft. From S Line SE
440 Ft. From W Line Quarter
 Ist. Report MAY 26 1954
 Completion _____
 Remarks _____
Glenn Peel - Contr.
 Spudding Date 5-22-54

Drig. Data Norton Pool
8" @ 316 drlg. 2380

J. G. McGEHEE