

State Geological Survey

WICHITA BRANCH

KANSAS DRILLERS LOG

15-02-3-20034  
 O 2-3-41W

API No. 15 \_\_\_\_\_  
 County \_\_\_\_\_ Number \_\_\_\_\_

S. 2 T. 3S R. 41 NE

Loc. C SW NE

County Cheyenne, Ks

Operator  
 Murfin Drilling

Address  
 617 Union Center, Wichita, Ks 67202

Well No. 1 Lease Name KRIEN

Footage Location  
 660 feet from (S) line 660 feet from (W) line NE

Principal Contractor Geologist  
 Murfin Drilling Roger Welty

Spud Date Total Depth P.B.T.D.  
 3/30/77 5285' 1511'

Date Completed Purchaser  
 4/10/77 Not avail. at present

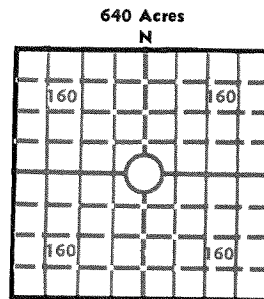

Elev.: Gr. 3543'

DF \_\_\_\_\_ KB \_\_\_\_\_

CASING RECORD

Report of all strings set — surface, intermediate, production, etc.

Purpose of string	Size hole drilled	Size casing set (in O.D.)	Weight lbs/ft.	Setting depth	Type cement	Sacks	Type and percent additives
Surface	12 1/4"	8 5/8"	24#	275	60/40 Poz	225	3% CaCl
Production	7 7/8"	4 1/2"	10.5#	1558'	Latex Common	50 50	10% salt, 3/4% CFR

LINER RECORD

PERFORATION RECORD

Top, ft.	Bottom, ft.	Sacks cement	Shots per ft.	Size & type	Depth interval
			4	Super Dyna	1408-12'
				w/reactive lnrs.	1414-18'
					1424-27'

TUBING RECORD

Size	Setting depth	Packer set at
1 1/2"	1436'	--

ACID, FRACTURE, SHOT, CEMENT SQUEEZE RECORD

Amount and kind of material used	Depth interval treated
1000 gal. 15% regular	1408-27'

INITIAL PRODUCTION

Date of first production --	Producing method (flowing, pumping, gas lift, etc.) Flowing This is a shut-in gas well			
RATE OF PRODUCTION PER 24 HOURS	Oil bbls.	Gas MCF	Water bbls.	Gas-oil ratio CFPB
Disposition of gas (vented, used on lease or sold)			Producing interval (s) above	

INSTRUCTIONS: As provided in KCC Rule 82-2-125, within 90 days after completion of a well, one completed copy of this Drillers Log shall be transmitted to the State Geological Survey of Kansas, 4150 Monroe Street, Wichita, Kansas 67209. Copies of this form are available from the Conservation Division, State Corporation Commission, 3830 So. Meridian (P.O. Box 17027), Wichita, Kansas 66217. Phone AC 316-522-2206. If confidential custody is desired, please note Rule 82-2-125. Drillers Logs will be on open file in the Oil and Gas Division, State Geological Survey of Kansas, Lawrence, Kansas 66044.

Operator Murfin Drilling		DESIGNATE TYPE OF COMP.: OIL, GAS, DRY HOLE, SWDW, ETC.: Gas
Well No. 1	Lease Name KRIEN	
S <u>2</u> T <u>3</u> S <u>R</u> <u>41</u> <sup>W</sup>		

**WELL LOG**

Show all important zones of porosity and contents thereof; cored intervals, and all drill-stem tests, including depth interval tested, cushion used, time tool open, flowing and shut-in pressures, and recoveries.

SHOW GEOLOGICAL MARKERS, LOGS RUN, OR OTHER DESCRIPTIVE INFORMATION.

FORMATION DESCRIPTION, CONTENTS, ETC.	TOP	BOTTOM	NAME	DEPTH
shale		1523	Niobrara	1405 +2148
shale, sand		2844	Anhy	3400 +153
lime, shale		4650	Topeka	4242 -689
lime		4700	Oread	4308 -755
lime, shale		4805	LKC	4391 -838
lime		4930	BKC	4701 -1148
lime, shale w/chert		5040	LTD	4705'
lime, sand, shale		5125		
lime		5285		
RTD		5285		
<p>DST #1: 4303-4410/45-60-45-60, rec. 100' M, 740' MSW, 1330-1343, FP 65-429, 120°.</p> <p>DST #2: 4410-70/30-30-30-30, 30' M, 56-37-37-47#.</p> <p>DST #3: 4524-95/45-60-45-60, 125' M, 1437-19/95-93/121-1399#.</p>				

USE ADDITIONAL SHEETS, IF NECESSARY, TO COMPLETE WELL RECORD.

Date Received	 Signature
	Wm. S. Shropshire, Asst. Gen. Manager
	Title
	July 20, 1977
	Date

7-2-110