

**KANSAS DRILLERS LOG**  
 the Cambrian, the survey would like to have ALL the cuttings that contain crystalline samples.  
 This in addition to the samples normally sent in to the Wichita Well Sample Library.  
 IMPORTANT: Kansas Geo. Survey requests samples on this well.

22-4-22W

S. 22 T. 4 R. 22 W

Loc. 100' N/C SW NE

County Norton

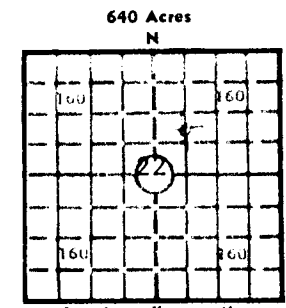

Elev.: Gr. 2232

DF 2235 KB 2237

State Geological Survey  
 AUG 30 1980  
 WICHITA BRANCH

API No. 15 — 137 — 20,184  
 County Number

Operator  
Hummon Corp.

Address  
400 C ne Main Place Wichita, Kansas 67202

Well No. # 1 Lease Name Griffin

Footage Location  
1880 feet from (N) ~~EX~~ line 1650 feet from (E) ~~XW~~ line

Principal Contractor Red Tiger Drilling Co. Geologist John Carnes

Spud Date 6/13/80 Total Depth 3790 P.B.T.D.

Date Completed 6/23/80 Oil Purchaser -----

**CASING RECORD**

Report of all strings set — surface, intermediate, production, etc.

| Purpose of string | Size hole drilled | Size casing set (in O.D.) | Weight lbs/ft. | Setting depth | Type cement | Sacks | Type and percent additives |
|-------------------|-------------------|---------------------------|----------------|---------------|-------------|-------|----------------------------|
| Surface           |                   | 8-5/8"                    | 28#            | 285           | Com         | 185   | 2% gel 3% cc               |
|                   |                   |                           |                |               |             |       |                            |
|                   |                   |                           |                |               |             |       |                            |
|                   |                   |                           |                |               |             |       |                            |

**LINER RECORD**

**PERFORATION RECORD**

| Top, ft. | Bottom, ft. | Sacks cement | Shots per ft. | Size & type | Depth interval |
|----------|-------------|--------------|---------------|-------------|----------------|
|          |             |              |               |             |                |
|          |             |              |               |             |                |

**TUBING RECORD**

| Size | Setting depth | Packer set at |
|------|---------------|---------------|
|      |               |               |

**ACID, FRACTURE, SHOT, CEMENT SQUEEZE RECORD**

| Amount and kind of material used | Depth interval treated |
|----------------------------------|------------------------|
|                                  |                        |
|                                  |                        |
|                                  |                        |

**INITIAL PRODUCTION**

Date of first production \_\_\_\_\_ Producing method (flowing, pumping, gas lift, etc.) \_\_\_\_\_

| RATE OF PRODUCTION PER 24 HOURS | Oil   | Gas   | Water | Gas-oil ratio |
|---------------------------------|-------|-------|-------|---------------|
|                                 | bbls. | bbls. | MCF   | CFPB          |

Disposition of gas (vented, used on lease or sold) \_\_\_\_\_ Producing interval (s) \_\_\_\_\_

INSTRUCTIONS: As provided in KCC Rule 82-2-125, within 90 days after completion of a well, one completed copy of this Drillers Log shall be transmitted to the State Geological Survey of Kansas, 4150 Monroe Street, Wichita, Kansas 67209. Copies of this form are available from the Conservation Division, State Corporation Commission, 3830 So. Meridian (P.O. Box 17027), Wichita, Kansas 66217. Phone AC 316-522-2206. If confidential custody is desired, please note Rule 82-2-125. Drillers Logs will be on open file in the Oil and Gas Division, State Geological Survey of Kansas, Lawrence, Kansas 66044.

Operator  
Hummon Corporation

DESIGNATE TYPE OF COMP.: OIL, GAS,  
DRY HOLE, SWDW, ETC.:  
dry hole

Well No.  
#1

Lease Name  
Griffin

S 22 T 4 R 22 E  
W

**WELL LOG**

Show all important zones of porosity and contents thereof; cored intervals, and all drill-stem tests, including depth interval tested, cushion used, time tool open, flowing and shut-in pressures, and recoveries.

SHOW GEOLOGICAL MARKERS, LOGS RUN, OR OTHER DESCRIPTIVE INFORMATION.

| FORMATION DESCRIPTION, CONTENTS, ETC.  | TOP | BOTTOM | NAME | DEPTH |
|--|-----|--------|------|-------|
| DST #1: 3422-3455<br>OP 30-30-45-45<br>Rec. 90' mud<br>SIP 1263-1295, FP 53-86   |     |        |      |       |
| DST #2: 3453-3470<br>OP 30-45-45-60<br>Rec. 200' total fluid<br>140' OCM<br>60' WM<br>SIP 1210-1178, FP 43-118                   |     |        |      |       |
| DST #3: 3470-96<br>OP 30-45-45-60<br>Fair blow 1st open, weak blow 2nd open<br>Rec. 40' wm<br>60' mud<br>SIP 1306/1306, FP 32-53 |     |        |      |       |
| DST #4: 3516-36<br>OP 30-45-30-60<br>Rec. 100' mud, 50' thin mud w/ SSO in tool<br>SIP 1317-1317, FP 43-96                       |     |        |      |       |
| DST #5: 3555-86<br>OP 30-30-30-45<br>Rec. 40' mud, no show<br>SIP 1146-1168, FP 53-64  |     |        |      |       |
| DST #6: 3694-3710<br>OP 30-30-30-45<br>Rec. 70' mud<br>ISIP false FSIP 923, FP 75-96   |     |        |      |       |

USE ADDITIONAL SHEETS, IF NECESSARY, TO COMPLETE WELL RECORD.

|               |   |
|---------------|---|
| Date Received | <p><i>Wilber Berg</i></p> <p>_____<br/>Signature</p> <p>_____<br/>Title</p> <p>_____<br/>Date</p> |
|---------------|---|