

OPERATOR John O. Farmer, Inc. & Consolidated Oil & Gas, Inc **FORMATION RECORD**

ADDRESS Box 352, Russell, Kansas

Give detailed description and thickness of all formation drilled through, contents of sand, whether dry, water, oil or gas.

AUG 8 1970  
 WICHITA, KANSAS  
 WELLS NO. 4  
 COUNTY Decatur  
 SEC. 22  
 TWP. 4S  
 RGE. 27W

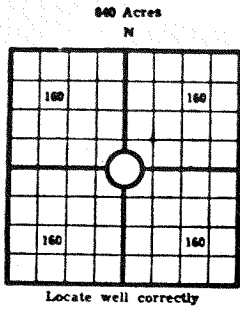

COUNTY Decatur, SEC. 22, TWP. 4S, RGE. 27W  
 COMPANY OPERATING John O. Farmer, Inc.  
 OFFICE ADDRESS Box 352, Russell, Ks.  
 DRILLING STARTED 7/13/70, DRILLING FINISHED 7/21/70  
 DATE OF FIRST PRODUCTION \_\_\_\_\_ COMPLETED \_\_\_\_\_  
 WELL LOCATED SW 1/4 NW 1/4 SE 1/4, North of South  
 Line and \_\_\_\_\_ ft. East of West Line of Quarter Section  
 Elevation (Relative to sea level) DERRICK FLOOR 2550 GROUND 2547  
 CHARACTER OF WELL (Oil, gas or dryhole) Dryhole

OIL OR GAS SANDS OR ZONES

Name	From	To	Name	From	To
1			4		
2			5		
3			6		

Perforating Record If Any

Shot Record

Formation	From	To	No. of Shots	Formation	From	To	Size of Shot

CASING RECORD

Amount Set						Amount Pulled		Packer Record			
Size	Wt.	Thds.	Make	Ft.	In.	Ft.	In.	Size	Length	Depth Set	Make

Line Record: Amount \_\_\_\_\_ Kind \_\_\_\_\_ Top \_\_\_\_\_ Bottom \_\_\_\_\_

CEMENTING AND MUDDING

Size	Amount Set	Sacks	Chemical	Method of	Amount	Mudding	Results
	Ft.	Cement	Gal.	Make		Method	(See Note)
5/8"	207'	150	sx.	cement			

Note: What method was used to protect sands if outer strings were pulled? \_\_\_\_\_

NOTE: Were bottom hole plugs used? \_\_\_\_\_ If so, state kind, depth set and results obtained \_\_\_\_\_

TOOLS USED

Rotary Tools were used from 0 feet to R.T.D. Cable tools were used from \_\_\_\_\_ feet to \_\_\_\_\_ feet, and from \_\_\_\_\_ feet to \_\_\_\_\_ feet, and from \_\_\_\_\_ feet to \_\_\_\_\_ feet  
 Type Rig? Rotary

INITIAL PRODUCTION TEST

Describe initial test: whether by flow through tubing or casing or by pumping \_\_\_\_\_  
 Amount of Oil Production \_\_\_\_\_ bbls. Size of choke, if any \_\_\_\_\_ Length of test \_\_\_\_\_ Water  
 Production \_\_\_\_\_ bbls. Gravity of oil \_\_\_\_\_ Type of Pump if pump is used, describe \_\_\_\_\_

Formation	Top	Bottom	Formation	Top	Bottom
Surface					
Shale	207	1110			
Shale Sand	1110	1490			
Sand	1490	1930			
Redbed	1930	2112			
Anhydrite	2112	2150			
Shale shells	2150	2650			
Shale lime	2650	2910			
Lime shale	2910	3710			
R.T.D.	3710				
			Log Tops		Top
			Tarkio		3190'
			Howard		3280'
			Heebner		3464'
			Toronto		3494'
			Lansing		3510'
			B/ Kansas City		3704'
			L.T.D.		3710'

I, the undersigned, being first duly sworn upon oath, state that this well record is true, correct and complete according to the records of this office and to the best of my knowledge and belief.

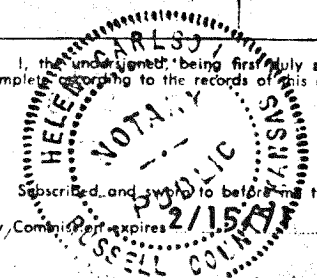

John O. Farmer  
 Name and title of representative of company President  
 Subscribed and sworn to before me this 24th day of July, 1970  
Helen Carlson  
 Notary Public

22-45-27w