

## KANSAS CORPORATION COMMISSION

## WELL RECORD

8-4-28W

(Mail to Kansas Geological Survey, 4150 Monroe Street, Wichita, Kansas 67209)

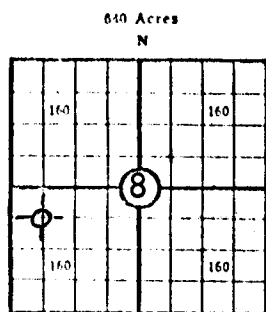

API #15-039-20, 227

Lease Name: BISHOP Well No. 3  
Well Located: NW NW SW  
SEC 8 TWP 4S RGE 28W  
Operator: C-G DRILLING CO.  
Address: 1107 UNION NATIONAL BLDG. WICHITA KS 67202  
Elevation: Ground 2763 D.F. 2768 K.B. 2768  
Type Well: (Oil, gas, dry hole) OIL

Drilling Commenced: MAR 11 1972 Drilling Completed: MAR 20 1972  
Well Completed: 19 Total Depth 4130'  
Initial Production: \_\_\_\_\_

Casing Record

Size: 8 5/8" Set at 274.34' Size: \_\_\_\_\_ Set at \_\_\_\_\_  
Size: \_\_\_\_\_ Set at \_\_\_\_\_ Size: \_\_\_\_\_ Set at \_\_\_\_\_

Liner Record

Size: \_\_\_\_\_ Set from \_\_\_\_\_ To \_\_\_\_\_

Cementing

Casing Size	Sacks	Type Cement and Additives
<u>8 5/8"</u>	<u>200</u>	<u>QUICKSET</u>
_____	_____	_____
_____	_____	_____

Perforations

Formation	Perforated Interval and Number Shots
_____	_____
_____	_____
_____	_____
_____	_____

Electric Log Run (Show type log and depths covered)

cont. 8-4-28w

FORMATION, TESTING AND COMPLETION RECORD

Show Drill Stem Tests,  
Well Stimulation and  
Production Tests

Formation	Top	Bottom	
SHALE & SAND	0	2563	
ANHYDRITE	2562	2596	
RED BED & SHL	2596	2830	
SHALE & SHELLS	2830	3313	
LIME & SHALE	3313	3926	DST #1 3907'-3950'
LIME	3926	4130	DST #2 3952'-3980'
TOTAL DEPTH	4130		DST #3 4004'-4020'
SMP TOPS	DEPTH		
ANHY	2553		
B ANHY	2594		
Heel	3863		
Tor	3892		
LKC	3907		
BKC	4120		
RTD	4130		

