

State Geological Survey
33-4-396

KANSAS DRILLERS LOG

S. 33 T. 4S R. 39 **(W)**
Loc. C NW/4
County Cheyenne

API No. 15 — 023 — 20,059
County Number

Operator
Murfin Drilling Company

Address
617 Union Center Bldg. Wichita, Kansas 67202

Well No. 1-33 Lease Name Schield

Footage Location
1320' feet from **(N)** (S) line 1320' feet from **(E)** **(W)** line

Principal Contractor Geologist
Murfin Drilling Co. -----

Spud Date 12/13/77 Total Depth 1825' P.B.T.D. 1413'

Date Completed 12/14/77 Oil Purchaser None

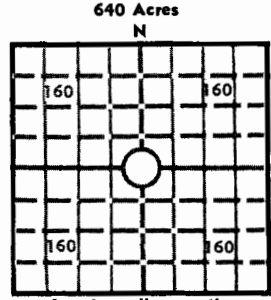

Elev.: Gr. 3526'
DF _____ KB 3521'

CASING RECORD

Report of all strings set — surface, intermediate, production, etc.

Purpose of string	Size hole drilled	Size casing set (in O.D.)	Weight lbs/ft.	Setting depth	Type cement	Sacks	Type and percent additives
Surface	9 5/8"	7"	24	342	60-40 posmix	225	3% CaCl
Production	6 1/4"	4 1/2"		1485'	25 Sx. Class A 50 Sx. Class A latex	75	

LINER RECORD

PERFORATION RECORD

Top, ft.	Bottom, ft.	Sacks cement	Shots per ft.	Size & type	Depth interval
			4		1296' - 98' 1308' - 12'
					1316' - 22'

TUBING RECORD

Size	Setting depth	Packer set at
1 1/2"	1298'	None

ACID, FRACTURE, SHOT, CEMENT SQUEEZE RECORD

Amount and kind of material used	Depth interval treated
Acidized w/ 100 gal. Acetic Acid	1296' - 1322'
Frac. w/ 100 bbls KCl water, 225 sx. Sand, & 200,000 SCF N ₂ .	1296' - 1322'

INITIAL PRODUCTION

Date of first production 5/22/80	Producing method (flowing, pumping, gas lift, etc.)
RATE OF PRODUCTION PER 24 HOURS	Oil ----- bbls. Gas 21 MCF Water ----- bbls. Gas-oil ratio ----- CFPB
Disposition of gas (vented, used on lease or sold) Sold	Producing interval (s) 1296' - 1322'

INSTRUCTIONS: As provided in KCC Rule 82-2-125, within 90 days after completion of a well, one completed copy of this Drillers Log shall be transmitted to the State Geological Survey of Kansas, 4150 Monroe Street, Wichita, Kansas 67209. Copies of this form are available from the Conservation Division, State Corporation Commission, 3830 So. Meridian (P.O. Box 17027), Wichita, Kansas 66217. Phone AC 316-522-2206. If confidential custody is desired, please note Rule 82-2-125. Drillers Logs will be on open file in the Oil and Gas Division, State Geological Survey of Kansas, Lawrence, Kansas 66044.

Operator Murfin Drilling Company		DESIGNATE TYPE OF COMP.: OIL, GAS, DRY HOLE, SWDW, ETC.:
Well No. 1-33	Lease Name Schild	Gas
S <u>33</u> T <u>4S</u> R <u>39</u> ^F _W		

WELL LOG

Show all important zones of porosity and contents thereof; cored intervals, and all drill-stem tests, including depth interval tested, cushion used, time tool open, flowing and shut-in pressures, and recoveries.

SHOW GEOLOGICAL MARKERS, LOGS RUN, OR OTHER DESCRIPTIVE INFORMATION.

FORMATION DESCRIPTION, CONTENTS, ETC.	TOP	BOTTOM	NAME	DEPTH
Shale and Sand Do DST's		1825'	Niobrara	1295'

USE ADDITIONAL SHEETS, IF NECESSARY, TO COMPLETE WELL RECORD.

Date Received	<p align="center"><i>Wayne Johnston</i> Signature</p> <p align="center">Wayne Johnston - Production Manager Title</p> <p align="center">8-20-80 Date</p>
---------------	--

8695L

33-4-360

WELL LOG

15-023-20059

33-4-39w

COMPANY MURFIN DRILLING COMPANY

SEC. 33 T. 4 S. R. 39 W
LOC. C NW/4

FARM SCHIELD NO. 1-33

RIG. NO. 7

TOTAL DEPTH 1825'

COMM. 12-13-77

COMP. 12-15-77

COUNTY Cheyenne
KANSAS

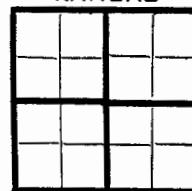

CONTRACTOR Murfin Drilling Company

CASING

20 10
15 8 7" @ 342' w/225 sx.
12 6
13 5 4½" @ 1485' w/75 sx.

ELEVATION 3516' GL

PRODUCTION

FIGURES INDICATE BOTTOM OF FORMATIONS

280' Sand & Clay
510' Shale
1825' Shale & Sand RTD