

26-5-2W ✓

KANSAS DRILLERS LOG

State Geological Survey
WICHITA, BRANCH

S. 26 T. 5 R. 21 ^R W

API No. 15 — 137 — 20,102
County Number

Loc. NE SW NE

County Norton

Operator
Kimbark Operating Co.

Address
1860 Lincoln Street Denver, Colorado

Well No. #2 Lease Name Kemper

Footage Location
1650 feet from (N) (X) line 1750 feet from (E) (V) line

Principal Contractor Helberg Drilling Company Geologist Robert C. Armstrong

Spud Date 7/10/75 Total Depth 3648' P.B.T.D. 3650'

Date Completed 7/17/75 Oil Purchaser Cities Service

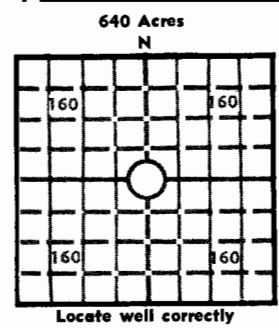

Elev.: Gr. _____

DF 2225' KB 2228'

CASING RECORD

Report of all strings set — surface, intermediate, production, etc.

Purpose of string	Size hole drilled	Size casing set (in O.D.)	Weight lbs/ft.	Setting depth	Type cement	Sacks	Type and percent additives
Surface	12 1/4	8 5/8	24	200'	Reg.	200	
Oil	7 7/8	4 1/2	15.5	3646'	Reg.	150	

LINER RECORD

PERFORATION RECORD

Top, ft.	Bottom, ft.	Sacks cement	Shots per ft.	Size & type	Depth interval
TUBING RECORD			Open Hole		
Size	Setting depth	Packer set at			
2"	3640'				

ACID, FRACTURE, SHOT, CEMENT SQUEEZE RECORD

Amount and kind of material used	Depth interval treated
500 Gal. - 15%	3646-3650
1500 Gal - 38%	3646-3650

INITIAL PRODUCTION

Date of first production 8/5/75		Producing method (flowing, pumping, gas lift, etc.) Pumping			
RATE OF PRODUCTION PER 24 HOURS	Oil 18 bbls.	Gas 3 MCF	Water 1 bbls.	Gas-oil ratio CFPB	
Disposition of gas (vented, used on lease or sold) Used			Producing interval (s) Arbuckle - 3646-50		

INSTRUCTIONS: As provided in KCC Rule 82-2-125, within 90 days after completion of a well, one completed copy of this Drillers Log shall be transmitted to the State Geological Survey of Kansas, 4150 Monroe Street, Wichita, Kansas 67209. Copies of this form are available from the Conservation Division, State Corporation Commission, 3830 So. Meridian (P.O. Box 17027), Wichita, Kansas 66217. Phone AC 316-522-2206. If confidential custody is desired, please note Rule 82-2-125. Drillers Logs will be on open file in the Oil and Gas Division, State Geological Survey of Kansas, Lawrence, Kansas 66044.

Operator

DESIGNATE TYPE OF COMP.: OIL, GAS, DRY HOLE, SWDW, ETC.:

Well No.

Lease Name

#2

Kemper

Oil

S 26 T 5S R 21 E W

WELL LOG

Show all important zones of porosity and contents thereof; cored intervals, and all drill-stem tests, including depth interval tested, cushion used, time tool open, flowing and shut-in pressures, and recoveries.

SHOW GEOLOGICAL MARKERS, LOGS RUN, OR OTHER DESCRIPTIVE INFORMATION.

FORMATION DESCRIPTION, CONTENTS, ETC.	TOP	BOTTOM	NAME	DEPTH
No Tests or Cores			Heebner	3365
			Toronto	3389
			Lansing	3408
			Base K.C.	3599
			Arbuckle	3645

USE ADDITIONAL SHEETS, IF NECESSARY, TO COMPLETE WELL RECORD.

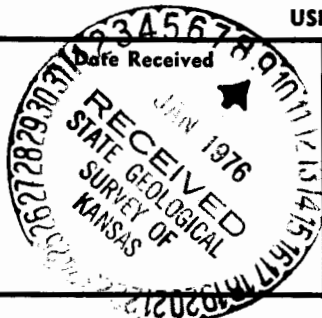

Walter K. Arbuckle

Signature

Walter K. Arbuckle

President

Title

August 6, 1975

Date

20-2-9-75