

Section 23 Township 5 Range 21W
 Well No. #5 Kemper
 Company Phillips Pet

SEC. 23 TWP. 5 R. 21W
 WELL NO. #5 Kemper FARM
 COMPANY
 CONTRACTOR Phillips Petr.
Group Explor.

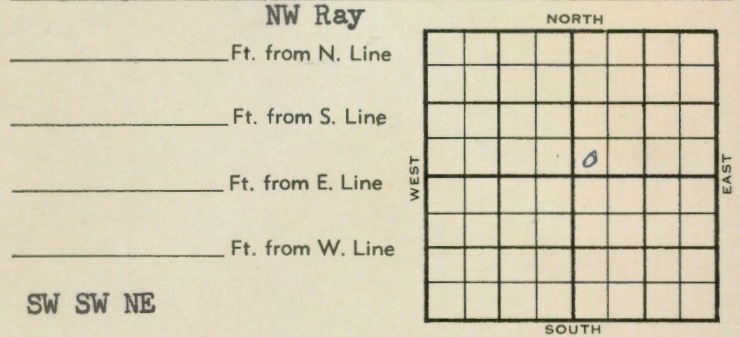
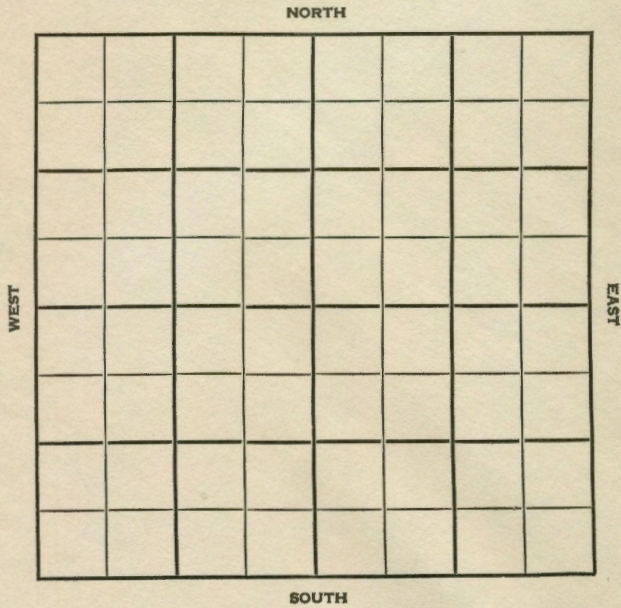

7

	ELEVATION	REPORT
1956	2197'	
3-21	Comm. 3-16-56 10" @ 399/290 Drlg. 2380	
4-18	7" @ 3623 w/675 4/ 2500 6" @ 2000 PB 25 1/4, frac, 3 bwom, CO to 3625 B/ 6 go 4 1/2 gw, 6 hrs. DD 3626 B/ 17 go 2 1/2 gw 7 hrs., 250 A S/ 16 bo, ##### 6 3/4 bw, 6 hrs. P/ 31 bopd, 4 bw, Comp. 25 bopd, 3 bw Tp. 3171 H. 3341 Tr. 3367 L. 3385 BKC 3570 A. 3621 TD 3625	
COMPLETED		

County Norton Elev. 21W
 Sec. 23 Twp. 5 Rge. 21W
 Company Phillips Pet.
 Farm Name Kemper No. 5

TOPS	DEPTH	LOG	DATUM	Loc. in Sec.
Anh.				SW SW NE
Tr.				
H.				
Tr.				
Dg.				
Bl.				
L.				Geol.
K.C.				Contr.
B.K.C.				<u>Group Explor</u>
Ce.				
C.				
M.				Pool
M.				<u>NW Ray</u>
K.				
Mz.				
Me.				
V.				
S.				
S.				
A.				
R.				
Pe.				
G.				

Date Comm. 3-16-56
10" @ 399/290 drlg. 2380

(Large handwritten mark)

County Norton Elev. 2197
 Sec. 23 Twp. 5 Rge. 21W
 Company Phillips Pet.
 Farm Name Kemper No. 5

TOPS	DEPTH	LOG	DATUM	Loc. in Sec.
Anh.				SW SW NE
Tr.	<u>3171</u>			
H.	<u>3341</u>			
Tr.	<u>3367</u>			
Dg.				
Bl.				
L.	<u>3385</u>		<u>1188</u>	Geol.
K.C.				Contr.
B.K.C.	<u>3570</u>		<u>1373</u>	<u>Group Explor</u>
Ce.				
C.				
M.				Pool
M.				<u>NW Ray</u>
K.				
Mz.				
Me.				
V.				
S.				
S.				
A.	<u>3621</u>		<u>1424</u>	
R.				
Pe.				
G.				

Date Comm. 3-16-56 APR 18 1956

10" @ 399/290 7" @ 3623/675
4/2500 6" @ 2000 PB 2544 frac
3 bwpm CO to 3625 B/6 go 4 1/2 gw
6 hr. DD 3626 B/17 go 2 1/2 gw 7 hr.
250 A S/16 bo 6 3/4 bw 6 hr.
P/31 bopd 4bw Comp. 25 bopd 3 bw

(Handwritten marks)