

IMPORTANT
Kans. Geo. Survey request
samples on this well.

17-5-28W

S. 17 T. 5S R. 28 W
Loc. 660' FSL & 660' FEL
County Decatur

API No. 15 — 039 — 20,317
County Number

Operator Shakespeare Oil Company, Inc.

Address Box 669 Salem, Illinois 62881

Well No. #1 Lease Name Steven Meitl

Footage Location 660 feet from (N) (S) line 660 feet from (E) (W) line

Principal Contractor Murfin Drilling Co. Geologist David Brierley

Spud Date 12-5-75 Total Depth 4150' P.B.T.D.

Date Completed 12-10-75 Oil Purchaser

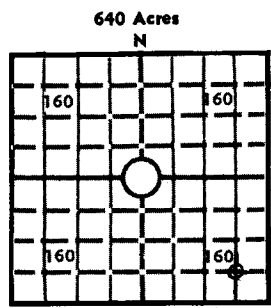

Elev.: Gr. 2735
DF _____ KB 2739

CASING RECORD

Report of all strings set — surface, intermediate, production, etc.

Purpose of string	Size hole drilled	Size casing set (in O.D.)	Weight lbs/ft.	Setting depth	Type cement	Sacks	Type and percent additives
Surface	12 1/4"	8 5/8"	24#	287'	Common	175	3% HA-5

LINER RECORD

PERFORATION RECORD

Top, ft.	Bottom, ft.	Sacks cement	Shots per ft.	Size & type	Depth interval

TUBING RECORD

Size	Setting depth	Packer set at

ACID, FRACTURE, SHOT, CEMENT SQUEEZE RECORD

Amount and kind of material used	Depth interval treated

INITIAL PRODUCTION

Date of first production	Producing method (flowing, pumping, gas lift, etc.)				
RATE OF PRODUCTION PER 24 HOURS	Oil	Gas	Water	Gas-oil ratio	
	bbls.	MCF	bbls.	CFPB	
Disposition of gas (vented, used on lease or sold)			Producing interval (s)		

INSTRUCTIONS: As provided in KCC Rule 82-2-125, within 90 days after completion of a well, one completed copy of this Drillers Log shall be transmitted to the State Geological Survey of Kansas, 4150 Monroe Street, Wichita, Kansas 67209. Copies of this form are available from the Conservation Division, State Corporation Commission, 3830 So. Meridian (P.O. Box 17027), Wichita, Kansas 66217. Phone AC 316-522-2206. If confidential custody is desired, please note Rule 82-2-125. Drillers Logs will be on open file in the Oil and Gas Division, State Geological Survey of Kansas, Lawrence, Kansas 66044.

Operator Shakespeare Oil Company, Inc. DESIGNATE TYPE OF COMP.: OIL, GAS, DRY HOLE, SWDW, ETC.:

Well No. 1 Lease Name Steven Meitl Dry Hole

S 17 T 5S R 28 W

WELL LOG

Show all important zones of porosity and contents thereof; cored intervals, and all drill-stem tests, including depth interval tested, cushion used, time tool open, flowing and shut-in pressures, and recoveries. SHOW GEOLOGICAL MARKERS, LOGS RUN, OR OTHER DESCRIPTIVE INFORMATION. Welex Induction Electric

FORMATION DESCRIPTION, CONTENTS, ETC.	TOP	BOTTOM	NAME	DEPTH
Surface soil, sand & gravel	0	200	Stone Corral	2536-73
Shale (Blue)	200	287	Dakota Sand	2900
Shale	287	470	Topeka	3746
Shale, sand stks	470	1380	Oread	3838
Shale, sand	1380	1950	Heebner	3876
Shale, sand stks	1950	2450	Toronto	3906
Shale	2450	2533	Lansing	3922
Anhydrite	2533	2574	B/KC	4120
Shale	2574	3540	TD	4150
Lime, shale	3540	3895		
Lime	3895	4150		
TD		4150		

USE ADDITIONAL SHEETS, IF NECESSARY, TO COMPLETE WELL RECORD.

Date Received

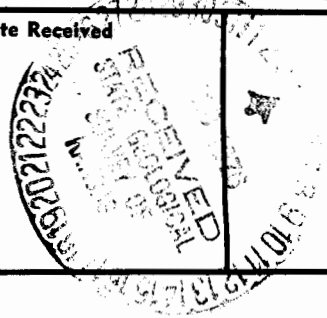

Wm F. Meyer
 Signature
 Production Manager
 Title
 January 20, 1976
 Date