

KANSAS DRILLERS LOG

API No. 15 — 153 — 20,369
County Number

S. 13 T. 5S R. 31W E
Loc. SE/SE/NW
County Rawlins, KS

Operator
MULL DRILLING COMPANY, INC.

Address
221 N Main - Suite 300, Wichita, KS 67202

Well No. 4 Lease Name WOERPEL

Footage Location
330' feet from (N) (S) line 330' feet from (E) (W) line

Principal Contractor Geologist
Blue Goose Drllg Co. Mike Kidwell

Spud Date Total Depth P.B.T.D.
4/18/80 4180 4200'

Date Completed Oil Purchaser
4/25/80

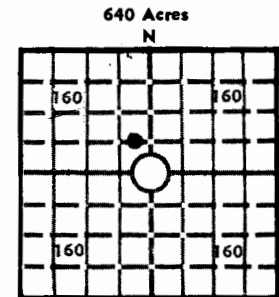

Locate well correctly
Elev.: Gr. 2905
DF _____ KB 2914

CASING RECORD

Report of all strings set — surface, intermediate, production, etc.

Purpose of string	Size hole drilled	Size casing set (in O.D.)	Weight lbs/ft.	Setting depth	Type cement	Sacks	Type and percent additives
Surface	12 1/4"	8-5/8"	20#	252'	Cmmn	160sx	3%ch 2% gel
Production	7-7/8	4-1/2	10 1/2#	4179'	60-40 poz	150	18% salt

LINER RECORD

PERFORATION RECORD

Top, ft.	Bottom, ft.	Sacks cement	Shots per ft.	Size & type	Depth interval
			8		4007-4012'

Size	Setting depth	Packer set at

ACID, FRACTURE, SHOT, CEMENT SQUEEZE RECORD

Amount and kind of material used	Depth interval treated
6/4/80 Treated w/250 gal 15% MCA	4007-4012'

INITIAL PRODUCTION

Date of first production June 30, 1980	Producing method (flowing, pumping, gas lift, etc.) Pumping
RATE OF PRODUCTION PER 24 HOURS 7/8/80 14 BOPDS/bbls.	Gas MCF Water 0 Wtr. .ls. Gas-oil ratio CFPB
Disposition of gas (vented, used on lease or sold) -----	Producing interval (s) Lansing/KC

INSTRUCTIONS: As provided in KCC Rule 82-2-125, within 90 days after completion of a well, one completed copy of this Drillers Log shall be transmitted to the State Geological Survey of Kansas, 4150 Monroe Street, Wichita, Kansas 67209. Copies of this form are available from the Conservation Division, State Corporation Commission, 3830 So. Meridian (P.O. Box 17027), Wichita, Kansas 66217. Phone AC 316-522-2206. If confidential custody is desired, please note Rule 82-2-125. Drillers Logs will be on open file in the Oil and Gas Division, State Geological Survey of Kansas, Lawrence, Kansas 66044.

Operator MULL DRILLING COMPANY, INC. DESIGNATE TYPE OF COMP.: OIL, GAS, DRY HOLE, SWDW, ETC.:

Well No. 4 Lease Name WOERPEL OIL

S 13 T 5 S R 31 W^E W

WELL LOG

Show all important zones of porosity and contents thereof; cored intervals, and all drill-stem tests, including depth interval tested, cushion used, time tool open, flowing and shut-in pressures, and recoveries.

SHOW GEOLOGICAL MARKERS, LOGS RUN, OR OTHER DESCRIPTIVE INFORMATION.

FORMATION DESCRIPTION, CONTENTS, ETC.	TOP	BOTTOM	NAME	DEPTH
Anhydrite	2615			
Heebner	3885			
Toronto	3919			
Lansing	3933			
MuncieCrkSh	4037			
B/KC	4155			
LTD	4179			
RTD	4180			
<p><u>DST #1 3993-4020' / 30-45-60-60</u> Weak, bldg xo strong blow(off bttm bkt) 22 min. Rec: 160' gas 20' clean oil 60' oil cut muddy water(19% oil/43% md/33% wtr) 300' oil cut muddy water(17% md/3%oil/80% wtr) CH-48,000 PPM Total fluid: 542 feet IHP 2250 ISIP 818 IFP 47-132 FFP 179-202 FSIP 810 FHP 2238</p>				
<p><u>DST #2 4062-4106 / 30-45-30-30</u> Very weak blow/died/1st flow 2nd flow: no blow Rec: 60' slightly oil cut mud(2% oil/98% md) IHP 2137 ISIP 967 IFP 54-54 FFP 78-78 FSIP 725 FHP 2121</p>				
<p><u>DST #3 (Straddle) 4008-4018' / 30-45-60-60</u> Weak, bldg to strong blow (off bttm bkt) 28 min. Rec: 165 feet gas 45 feet clean oil(38^ogravity) 32 feet heavy oil cut mud(40%oil/60%md) 92 feet oil cut very slightly watery md(15% oil/83%md/2%wtr) 120 feet oily slightly watery mud(6%oil/87%md/7%wtr) Total Fluid: 289 feet IHP 2274 ISIP 1204 IFP 70-101 FFP 124-140 FSIP 1133 FHP 2258</p>				

USE ADDITIONAL SHEETS, IF NECESSARY, TO COMPLETE WELL RECORD.

Date Received	<i>Robert O. Wall</i>
	Robert O. Wall Signature PRESIDENT Title
	<i>September 11, 1980</i> Date 1980