

State Geological Survey
WICHITA, BRANCH

26-6-20W

KANSAS DRILLERS LOG

S. 26 T. 6 R. 20 ^{XXX}
W

API No. 15 — 163 — 20,514
County Number

Loc. NW NE NE

County Rooks

Operator

C. Oil, Inc.
Address 842 Toh-N-Hah Trail
Wichita, Kansas

Well No. #1 Lease Name Probasco "A"

Footage Location
330 feet from (N) ~~30~~ line 990 feet from (E) ~~XX~~ line

Principal Contractor Red Tiger Drilling Co. Geologist Walter Martz

Spud Date 1-26-74 Total Depth 3715 P.B.T.D.

Date Completed 2-3-74 Oil Purchaser

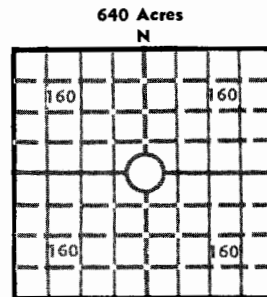

Elev.: Gr. _____
DF _____ KB _____

CASING RECORD

Report of all strings set — surface, intermediate, production, etc.

| Purpose of string | Size hole drilled | Size casing set (in O.D.) | Weight lbs/ft. | Setting depth | Type cement | Sacks | Type and percent additives |
|-------------------|-------------------|---------------------------|----------------|---------------|-------------|-------|----------------------------|
| Surface | 12 1/2 | 8 5/8 | 32# | 198 | 60/49 Poz | 170 | HA5 |
| | | | | | | | |
| | | | | | | | |
| | | | | | | | |

LINER RECORD

PERFORATION RECORD

| Top, ft. | Bottom, ft. | Sacks cement | Shots per ft. | Size & type | Depth interval |
|----------|-------------|--------------|---------------|-------------|----------------|
| None | | | None | | |

TUBING RECORD

| Size | Setting depth | Packer set at |
|------|---------------|---------------|
| None | | |

ACID, FRACTURE, SHOT, CEMENT SQUEEZE RECORD

| Amount and kind of material used | Depth interval treated |
|----------------------------------|------------------------|
| None | |
| | |
| | |

INITIAL PRODUCTION

| | | | | | |
|--|---|---------|------------------------|---------------|------|
| Date of first production | Producing method (flowing, pumping, gas lift, etc.) DRY HOLE | | | | |
| RATE OF PRODUCTION PER 24 HOURS | Oil bbls. | Gas MCF | Water bbls. | Gas-oil ratio | CFPB |
| Disposition of gas (vented, used on lease or sold) | | | Producing interval (s) | | |

INSTRUCTIONS: As provided in KCC Rule 82-2-125, within 90 days after completion of a well, one completed copy of this Drillers Log shall be transmitted to the State Geological Survey of Kansas, 4150 Monroe Street, Wichita, Kansas 67209. Copies of this form are available from the Conservation Division, State Corporation Commission, 3830 So. Meridian (P.O. Box 17027), Wichita, Kansas 66217. Phone AC 316-522-2206. If confidential custody is desired, please note Rule 82-2-125. Drillers Logs will be on open file in the Oil and Gas Division, State Geological Survey of Kansas, Lawrence, Kansas 66044.

Operator

DESIGNATE TYPE OF COMP.: OIL, GAS, DRY HOLE, SWDW, ETC.:

C Oil, Inc

Well No.

Lease Name

1

Probasco "A"

DRY HOLE

S 26 T 6 R 20 E W

WELL LOG

Show all important zones of porosity and contents thereof; cored intervals, and all drill-stem tests, including depth interval tested, cushion used, time tool open, flowing and shut-in pressures, and recoveries.

SHOW GEOLOGICAL MARKERS, LOGS RUN, OR OTHER DESCRIPTIVE INFORMATION.

| FORMATION DESCRIPTION, CONTENTS, ETC. | | TOP | BOTTOM | NAME | DEPTH |
|---------------------------------------|--|--|--|--------------|--------------|
| Log Tops | Topeka Heebner Toronto Lansing-Kansas City BKC Arbuckle RTD | 3139 3340 3363 3378 3581 3643 3715 | (-997) (-1198) (-1221) (-1236) (-1439) (-1501) (-1573) | | |
| DST #1 | 3346-3390 Weak Blow - 5 min. Recovered 10' FP: 31-42, BHP: 1056-1014. Temp.-102° | Op 30, SI 30 | Op 30, SI 30 | Op 30, SI 30 | Op 30, SI 30 |
| DST #2 | 3406-3480 Weak blow - 10 min. Recovered 15' FP: 63-74, BHP: 993-951. Temp.-104° | Op 30, SI 30 | Op 30, SI 30 | Op 30, SI 30 | Op 30, SI 30 |
| DST #3 | 3630-3653 Weak Blow - 5 min. Recovered 10 feet FP: 21-25, BHP: 42-42 Temp.-107° | Op 30, SI 30 | Op 30, SI 30 | Op 30, SI 30 | Op 30, SI 30 |
| Ran Welex Radiation-Guaed | | | | | |

USE ADDITIONAL SHEETS, IF NECESSARY, TO COMPLETE WELL RECORD.

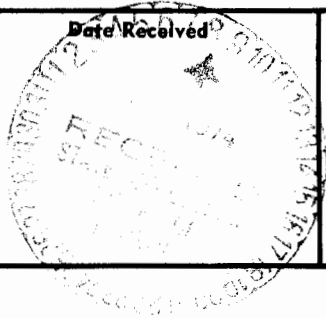

James W. ...

 Signature

President and Petroleum Engineer

Title

February 14, 1974

Date