

4/30/87
KCC

SIDE ONE

RELEASED
WELL COMPLETION OR RECOMPLETION FORM
Date: MAY 1 1987
ACO-1 WELL HISTORY
FROM CONFIDENTIAL

Operator: License # 8000
Name PANCANADIAN PETROLEUM CO.
Address Box 929
Denver, CO 80202
City/State/Zip

Purchaser Inland Crude

Operator Contact Person Tom Rubis
Phone 303-825-8371

Contractor: License # 5418
Name ALLEN DRILLING COMPANY

Wellsite Geologist Paul Laird
Phone (316) 267-4464

Designate Type of Completion
 New Well Re-Entry Workover
 Oil SWD Temp Abd
 Gas Inj Delayed Comp.
 Dry Other (Core, Water Supply etc.)

If OWWO: old well info as follows:
Operator N/A
Well Name
Comp. Date
Old Total Depth

WELL HISTORY

Drilling Method:
 Mud Rotary Air Rotary Cable
12-6-85 1-03-86 1-30-86
Spud Date Date Reached TD Completion Date
4025' 3980'
Total Depth PBDT

Amount of Surface Pipe Set and Cemented at 296 feet
Multiple Stage Cementing Collar Used? Yes No
If yes, show depth set 2035' feet
If alternate 2 completion, cement circulated
from 2035' feet depth to 0' w/ 475 SX cmt

API NO. 15-..... 065-22,287 17-6-22W
County..... Graham
..... C SE NE Sec. 17 Twp. 6 Rge. 22 East
..... X West

..... 3300 Ft North from Southeast Corner of Section
..... 660 Ft West from Southeast Corner of Section
(Note: Locate well in section plat below)

Lease Name..... Pennington Well #..... 42-17-2

Field Name..... Penn

Producing Formation..... Lansing/Kansas City

Elevation: Ground..... 2372 KB..... 2377

Section Plat

CONFIDENTIAL

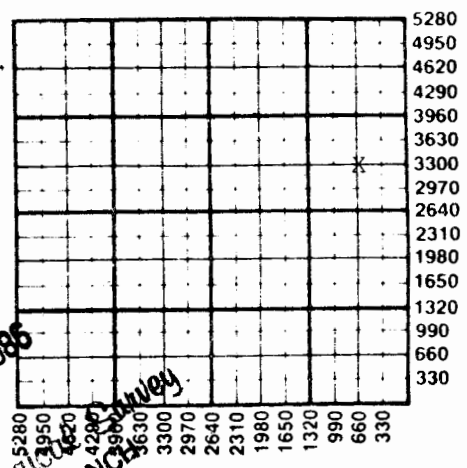

MAR 03 1986
Geological BRANCH

WATER SUPPLY INFORMATION
Disposition of Produced Water: Disposal
Docket # Repressuring

Questions on this portion of the ACO-1 call:
Water Resources Board (913) 296-3717
Source of Water:
Division of Water Resources Permit #..... T85-1112

Groundwater..... 3250 Ft North from Southeast Corner
(Well) 660 Ft West from Southeast Corner of
Sec 3 Twp 6S Rge 22 East West
 Surface Water..... Ft North from Southeast Corner
(Stream, pond etc)..... Ft West from Southeast Corner
Sec Twp Rge East West

Estimated Production Per 24 Hours	Oil	Gas	Water	Gas-Oil Ratio	Gravity
	20 Bbls	TSTM MCF	21 Bbls	TSTM CFPB	38° API

METHOD OF COMPLETION

Production Interval

Disposition of gas: Vented Open Hole Perforation
 Sold Other (Specify) LKC "D" "I"
 Used on Lease
 Dually Completed & "J" perfs

Operator Name **PANCANADIAN PETROLEUM COMPANY** Lease Name **Pennington** Well # **42-17-2**

Sec. **17** Twp. **6** Rge. **22** East West County **Graham**

WELL LOG

INSTRUCTIONS: Show important tops and base of formations penetrated. Detail all cores. Report all drill stem tests giving interval tested, time tool open and closed, flowing and shut-in pressures, whether shut-in pressure reached static level, hydrostatic pressures, bottom hole temperature, fluid recovery, and flow rates if gas to surface during test. Attach extra sheet if more space is needed. Attach copy of log.

Drill Stem Tests Taken Yes No
 Samples Sent to Geological Survey Yes No
 Cores Taken Yes No

Formation Description
 Log Sample

DST #1: 3531-68'. 22-45-60-90. Rec'd 30 OCMW, 2230' sulfur wtr. HP 1802-1781, SIP 1235-1204, IFP 164-370, FFP 473-1039.
 DST #2: 3617-30. 15-45-60-90. Rec'd 1450' SW w/oil scum on top. SIP 1028-925, HP 1792-1740, IFP 144-277, FFP 380-648.
 DST #3: 3759-93. 15-45-60-90, Rec'd 150' GIP, 60' c/n gsy oil, 60' OCM. SIP 925-823, HP 1925-1905, IFP 51-51, FFP 61-72.
 Core #1: 3763-93. Rec'd 30'. 3764-67 LS, 3767-74 sh, 3774-86 LS, 3786-93 sh.

Name	Top	Bottom
Anhydrite	2043 (+335)	
Topeka	3397 (-1019)	
Heebner	3582 (-1204)	
Toronto	3610 (9-1232)	
Lansing/KS City	3624 (-1246)	
Conglomerate	3872 (-1494)	
Arbuckle	3930 (-1552)	

CONFIDENTIAL

CASING RECORD <input checked="" type="checkbox"/> New <input type="checkbox"/> Used Report all strings set-conductor, surface, intermediate, production, etc.							
Purpose of String	Size Hole Drilled	Size Casing Set (in O.D.)	Weight Lbs/Ft.	Setting Depth	Type of Cement	#Sacks Used	Type and Percent Additives
Surface	12 1/4	8 5/8	24#	296	Class A	225	2% Gel 3% CC
Production		4 1/2	10.5	4021	Class A	825	2% Gel 3% CC
				DV @ 2035'	Class A	475	4% gel
PERFORATION RECORD Shots Per Foot Specify Footage of Each Interval Perforated				Acid, Fracture, Shot, Cement Squeeze Record (Amount and Kind of Material Used) Depth			
Two	LKC "D"	3673'-3678'		1250'	15% acid		same
Two	LKC "I"	3764'-3767'		3250'	15% acid		same
	"J"	3774'-3784'					
TUBING RECORD Size 4.70# Set At 2-3/8" 3845'. Packer at none				Liner Run <input type="checkbox"/> Yes <input checked="" type="checkbox"/> No			
Date of First Production		Producing Method					
1/30/86		<input type="checkbox"/> Flowing <input checked="" type="checkbox"/> Pumping <input type="checkbox"/> Gas Lift <input type="checkbox"/> Other (explain).....					

Date Commission Expires **10/17/88**