

112488
19-6-2ju kcc

SIDE ONE

RELEASED

FEB 1 1988
STATE CORPORATION COMMISSION OF KANSAS
OIL & GAS CONSERVATION DIVISION
WELL COMPLETION OR RECOMPLETION FORM
FROM CONFIDENTIAL
ACQ-1 WELL HISTORY

API NO. 15-065-22335

County...Graham

...C...NE...SE...Sec. 19...Twp. 6...Rge. 22... East
... X West

1980
660
Ft North from Southeast Corner of Section
Ft West from Southeast Corner of Section

(Note: Locate well in section plat below)

Lease Name...ROGERS 43-19...Well #...1

Field Name...Pen

Producing Formation...Lansing/Kansas City

Elevation: Ground...2394'...KB...2399'

Section Plat

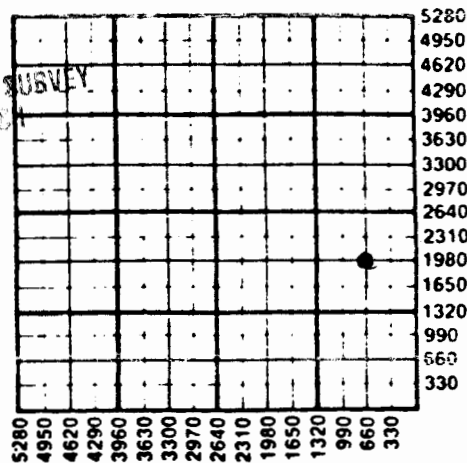

FEB 18 1988

WATER SUPPLY INFORMATION

Disposition of Produced Water: _____ Disposal
Docket # ...N/A... _____ Repressuring

Questions on this portion of the ACQ-1 call:
Water Resources Board (913) 296-3717

Source of Water:
Division of Water Resources Permit #...T86-5824...

X Groundwater...4260...Ft North from Southeast Corner
(Well) ...4260...Ft West from Southeast Corner of
Sec 20 Twp 6S Rge 22 East X West

Surface Water.....Ft North from Southeast Corner
(Stream, pond etc).....Ft West from Southeast Corner
Sec Twp Rge East West

Other (explain).....
(purchased from city, R.W.D. #)

Operator: License # 8000
PANCANADIAN PETROLEUM COMPANY
Name
Address P.O. Box 929
City/State/Zip Denver, CO 80201

Purchaser...Diamond Shamrock (pending)

Operator Contact Person J.D. Keisling
Phone (303) 825-8371

Contractor: License # 6033
Muffin Drilling Company
Name

Wellsite Geologist J.E. Holdeman
Phone (303) 825-8371

Designate Type of Completion

X New Well Re-Entry Workover
Oil SWD X Temp Abd
Gas Inj Delayed Comp.
Dry Other (Core, Water Supply etc.)

If OWNED: old well info as follows:

Operator
Well Name
Comp. Date Old Total Depth

WELL HISTORY

Drilling Method:

X Mud Rotary Air Rotary Cable

11/30/86 12/7/86 12/12/86
Spud Date Date Reached TD Completion Date

3940' 3896'
Total Depth PBTD

Amount of Surface Pipe Set and Cemented at 302 feet
Multiple Stage Cementing Collar Used? X Yes No
If yes, show depth set 2063' feet
If alternate 2 completion, cement circulated
from 2063 feet depth to surf w/ 250 SX cmt
Cement Company Name Halliburton
Invoice #

INSTRUCTIONS: This form shall be completed in triplicate and filed with the Kansas Corporation Commission, 200 Colorado Derby Building, Wichita, Kansas 67202, within 120 days of the spud date of any well. Rule 82-3-130, 82-3-107 and 82-3-106 apply.

Information on side two of this form will be held confidential for a period of 12 months if requested in writing and submitted with the form. See rule 82-3-107 for confidentiality in excess of 12 months. One copy of all wireline logs and drillers time log shall be attached with this form. Submit OP-4 form with all plugged wells. Submit CP-111 form with all temporarily abandoned wells.

Operator Name PANCANADIAN PETROLEUM COMPANY Lease Name ROGERS 43-19 Well # 1

Sec..... 19 Twp..... 6S Rge..... 22 East West County..... Graham

WELL LOG

INSTRUCTIONS: Show important tops and base of formations penetrated. Detail all cores. Report all drill stem tests giving interval tested, time tool open and closed, flowing and shut-in pressures, whether shut-in pressure reached static level, hydrostatic pressures, bottom hole temperature, fluid recovery, and flow rates if gas to surface during test. Attach extra sheet if more space is needed. Attach copy of log.

Drill Stem Tests Taken Yes No
 Samples Sent to Geological Survey Yes No
 Cores Taken Yes No

Formation Description
 Log Sample

DST #1: 3810-3774' Lansing/KC "I" and "J"
 15/45/30/30 Rec: 5 ft drlg mud w/oil specks
 IHP: 1930, IFP: 33-35, ISIP: 674, FFP: 33-33,
 FSIP: 175, FHP: 1922

Name	Top	Bottom
Stone Corral Anhydrite	2045	(+353)
Topeka	3408	(-1010)
Heebner	3607	(-1209)
Toronto	3634	(-1236)
Lansing/KC	3649	(-1251)
Conglomerate	3906	(-1508)

DST #2: 3810-3838' Lansing/KC "K" and "L"
 15/45/30/30, Rec: 3 ft drlg mud, IHP: 1963,
 IFP: 25-25, ISIP: 582, FFP: 25-25, FSIP: 158,
 FHP: 1941

Estimated Production Per 24 Hours	Oil	Gas	Water	Gas-Oil Ratio	Gravity
	0 Bbls	TSTM MCF	Swab rate	Bbls	38°

METHOD OF COMPLETION

Production Interval

Disposition of gas: Vented Open Hole Perforation 3798-3804
 Sold Other (Specify)

CASING RECORD <input checked="" type="checkbox"/> New <input type="checkbox"/> Used							
Report all strings set-conductor, surface, intermediate, production, etc.							
Purpose of String	Size Hole Drilled	Size Casing Set (in O.D.)	Weight Lbs/Ft.	Setting Depth	Type of Cement	#Sacks Used	Type and Percent Additives
Surface	12 1/4"	8-5/8"	24	302'	Cl A	205 sx	60/40 Poz w/2% gel
Production	1st 7-7/8"	4 1/2"	10.5		Cl A	265 sx	3% CaCl
	2nd 7-7/8"	4 1/2"	10.5	3939'	Lite	250 sx	w/10% gel + 1/4# sx flo-cel

PERFORATION RECORD		Acid, Fracture, Shot, Cement Squeeze Record	
Shots Per Foot	Specify Footage of Each Interval Perforated	(Amount and Kind of Material Used)	Depth
2	3798-3804'	Acid frac 2300 gal - 20% HCl 2000 gal of gelled water	3798-3804'

TUBING RECORD Size Set At Packer at Liner Run Yes No
 No tubing run none

Date of First Production 12/15/86 Producing Method Flowing Pumping Gas Lift Other (explain) swabbing..