

**State Geological Survey  
WICHITA, BRANCH**

15-065-00877

**KANSAS DRILLERS LOG**

S. 8 T. 6 R. 24 <sup>R</sup>/<sub>W</sub>

API No. 15 ————— County Owwo Number Owwo

Loc. NW NW NE

County Graham

Operator  
Liberty Enterprises, Inc.

Address  
117 East 10th Street Hays, Kansas 67601

Well No. #1 Lease Name David OWWO

Footage Location  
feet from (N) (S) line \_\_\_\_\_ feet from (E) (W) line \_\_\_\_\_

Principal Contractor Helberg Oil Company Geologist none

Spud Date April 9, 1976 Total Depth 4140 ft. P.B.T.D. \_\_\_\_\_

Date Completed April 11, 1976 Oil Purchaser Mobil

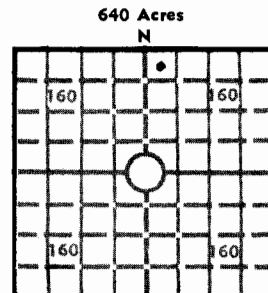

640 Acres  
N  
Locate well correctly

Elev.: Gr. \_\_\_\_\_

DF \_\_\_\_\_ KB \_\_\_\_\_

**CASING RECORD**

Report of all strings set — surface, intermediate, production, etc.

Purpose of string	Size hole drilled	Size casing set (in O.D.)	Weight lbs/ft.	Setting depth	Type cement	Sacks	Type and percent additives
surface ;	12 1/4	8 5/8	24	226	common	125	6 units quick set
production	7 7/8	4 1/2	10 1/2	3855	common	125	none

**LINER RECORD**

**PERFORATION RECORD**

Top, ft.	Bottom, ft.	Sacks cement	Shots per ft.	Size & type	Depth interval
			2	(enclosed sheet)	

**TUBING RECORD**

Size	Setting depth	Packer set at
2 3/8 "	3750 ft.	plug-BAKER 1-AA, 3750 ft.

**ACID, FRACTURE, SHOT, CEMENT SQUEEZE RECORD**

Amount and kind of material used	Depth interval treated
2000 gal. of 15% CR acid	3796-3777
3000 gal. of 15% chemical retarded acid	3663-3696 & 3696-3707

**INITIAL PRODUCTION**

Date of first production	Producing method (flowing, pumping, gas lift, etc.)
April 28, 1976	pumping
<b>RATE OF PRODUCTION PER 24 HOURS</b>	<b>Oil</b> _____ <b>Gas</b> _____ <b>Water</b> _____ <b>Gas-oil ratio</b> _____
70 bbls.	0 MCF 200 bbls. 0 CFPB
Disposition of gas (vented, used on lease or sold)	Producing interval(s)
vented	Kansas City

**INSTRUCTIONS:** As provided in KCC Rule 82-2-125, within 90 days after completion of a well, one completed copy of this Drillers Log shall be transmitted to the State Geological Survey of Kansas, 4150 Monroe Street, Wichita, Kansas 67209. Copies of this form are available from the Conservation Division, State Corporation Commission, 3830 So. Meridian (P.O. Box 17027), Wichita, Kansas 66217. Phone AC 316-522-2206. If confidential custody is desired, please note Rule 82-2-125. Drillers Logs will be on open file in the Oil and Gas Division, State Geological Survey of Kansas, Lawrence, Kansas 66044.

Operator

DESIGNATE TYPE OF COMP.: OIL, GAS, DRY HOLE, SWDW, ETC.:

Well No.

Lease Name

S \_\_\_\_\_ T \_\_\_\_\_ R \_\_\_\_\_ E \_\_\_\_\_ W \_\_\_\_\_

### WELL LOG

Show all important zones of porosity and contents thereof; cored intervals, and all drill-stem tests, including depth interval tested, cushion used, time tool open, flowing and shut-in pressures, and recoveries.

SHOW GEOLOGICAL MARKERS, LOGS RUN, OR OTHER DESCRIPTIVE INFORMATION.

FORMATION DESCRIPTION, CONTENTS, ETC.	TOP	BOTTOM	NAME	DEPTH

USE ADDITIONAL SHEETS, IF NECESSARY, TO COMPLETE WELL RECORD.

Date Received

*Royce L. Conner*  
Signature

**LIBERTY ENTERPRISES, INC.**

117 E. 10TH ST.  
HAYS, KANSAS 67501

*Miss - Pres*  
Title

*5-10-76*  
Date

# GREAT GUNS

HAYS - KANSAS

Phone (913) 625-6501

No. 8390

Date 4-19-76

## PERFORATION RECORD

Customer LIBERTY ENTERPRISES

Lease DAWN No. 1

Pipe Size 4 1/2 Weight Field

Sec. 9804 Twp. 6S Range 24W Co. OSAGE State KANSAS

Engineer GRANT Operator A. J.

Fluid Level TD

### PERFORATING

Collors	From	To	No. Shots
3597-3636 3677 3716 + 3756-3796			
Perforate - Bullet Jet	3726	3759	6
Perforate - Bullet Jet	3695	3697	4
Perforate - Bullet Jet	3661	3664	6
Perforate - Bullet Jet	3736		1
Perforate - Bullet Jet	3727		1
Other	3707		1
Other	3696		1
Other	3163		1

### PLUGS

Plug @ Ft. Plug @ Ft.  
Plug @ Ft. Plug @ Ft.

74  
20  
9  
75  
33  
34  
51

HEEDNEK

10m 195 SH.

3600

10% Para

TOROUTO

DST#1: 3025-47  
Rec. 6" MUD  
BHP: 440#

L.K.C.

A



50

B

C

DST#2: 3647-95  
Rec. 120' OCM  
80' OCM  
40' WTR  
BHA: 1200#

13%  
10%  
13%

E

F

G

3706 7/8 09  
344

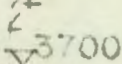

3700

11+%

7%

6.5%

DST#3: 3100-21  
Rec. 20' OIL  
70' MO  
30' HOCW M  
48' OCM  
60' WTR  
BHP: 1100#

H

I ZONE  
NOT PRESENT

J

K

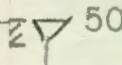

50

3800

10% Para

8.5%

12%

11+%

DST#4: 3750-1010  
Rec. 30' VSOCM  
BHP: 1280#