

State Geological Survey
WICHITA, BRANCH

KANSAS DRILLERS LOG

API No. 15 — 163 — 20,473
County Number

S. 28 T. 7S R. 16W ^E/_W

Loc. NW SE NW

County Rooks

Operator
PETROLEUM MANAGEMENT, INC.

Address
1515 Vickers KSB&T Bldg. Wichita, Ks 67202

Well No. #5 Lease Name JONES A

Footage Location
1650 North 1650 West
feet from (N) (S) line feet from (E) (W) line

Principal Contractor Red Tiger Drilling Co. Geologist W. H. Petersen

Spud Date 11-11-72 Total Depth 3307' P.B.T.D. 3140'

Date Completed 1-10-73 Oil Purchaser NCRA

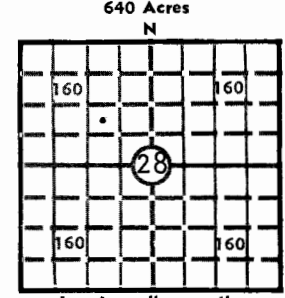

Locate well correctly
Elev.: Gr. 1901

DF 1903 KB 1906

CASING RECORD

Report of all strings set — surface, intermediate, production, etc.

| Purpose of string | Size hole drilled | Size casing set (in O.D.) | Weight lbs/ft. | Setting depth | Type cement | Sacks | Type and percent additives |
|-------------------|-------------------|---------------------------|----------------|---------------|------------------|-------|----------------------------|
| Surface Csg | 12-1/4 | 8-5/8 | 28# | 922' | Common Light | 150 | 3% Calcium Chloride |
| Production Csg | 7-7/8 | 4-1/2 | 14# | 3201' | Scavenger Pozmix | 50 | 2% Calcium Chloride |
| | | | | | | 225 | Salt Saturated |

LINER RECORD

PERFORATION RECORD

| Top, ft. | Bottom, ft. | Sacks cement | Shots per ft. | Size & type | Depth interval |
|----------|-------------|--------------|---------------|-------------|----------------|
| | | | 2 | DP Jets | 2822-26' |
| | | | 2 | DP Jets | 2850-54' |

TUBING RECORD

| Size | Setting depth | Packer set at |
|------|---------------|---------------|
| 2" | 3047' | |

ACID, FRACTURE, SHOT, CEMENT SQUEEZE RECORD

| Amount and kind of material used | Depth interval treated |
|---|------------------------|
| 1000 gal My-T-Frac 500 gal 15% Non E 500 gal MOD 303 | 2822-26' |
| 250 gal 15% Non E | 2850-54' |

INITIAL PRODUCTION

| | | | | | |
|--|---|------------------------|--|---------------------------|------|
| Date of first production <u>1-24-73</u> | Producing method (flowing, pumping, gas lift, etc.) <u>Pumping</u> | | | | |
| RATE OF PRODUCTION PER 24 HOURS | Oil <u>25</u> bbls. | Gas <u>0</u> MCF | Water <u>4</u> bbls. | Gas-oil ratio <u>-</u> | CFPB |
| Disposition of gas (vented, used on lease or sold) <u>-</u> | | | Producing interval(s) <u>2822-26 2850-54'</u> | | |

INSTRUCTIONS: As provided in KCC Rule 82-2-125, within 90 days after completion of a well, one completed copy of this Drillers Log shall be transmitted to the State Geological Survey of Kansas, 4150 Monroe Street, Wichita, Kansas 67209. Copies of this form are available from the Conservation Division, State Corporation Commission, 3830 So. Meridian (P.O. Box 17027), Wichita, Kansas 66217. Phone AC 316-522-2206. If confidential custody is desired, please note Rule 82-2-125. Drillers Logs will be on open file in the Oil and Gas Division, State Geological Survey of Kansas, Lawrence, Kansas 66044.

Operator PETROLEUM MANAGEMENT, INC.

DESIGNATE TYPE OF COMP.: OIL, GAS, DRY HOLE, SWDW, ETC.:

Well No.

#5

Lease Name

JONES A

OIL

S 28 T 7S R 16W E W

WELL LOG

Show all important zones of porosity and contents thereof; cored intervals, and all drill-stem tests, including depth interval tested, cushion used, time tool open, flowing and shut-in pressures, and recoveries.

SHOW GEOLOGICAL MARKERS, LOGS RUN, OR OTHER DESCRIPTIVE INFORMATION.

| FORMATION DESCRIPTION, CONTENTS, ETC. | TOP | BOTTOM | NAME | DEPTH |
|---------------------------------------|------|--------|------------|-------------|
| Shale - Rock | 0 | 465 | Anhydrite | 1200 + 706 |
| Shale | 465 | 780 | Base Anhy. | 1234 + 672 |
| Sand | 780 | 895 | Topeka | 2789 - 883 |
| Shale | 895 | 1200 | Deer Creek | 2837 - 931 |
| Anhydrite | 1200 | 1234 | Lecompton | 2905 - 999 |
| Shale | 1234 | 1450 | Oread | 2945 - 1039 |
| Shale - Lime | 1450 | 2015 | Heebner | 3005 - 1099 |
| Shale | 2015 | 2053 | Toronto | 3027 - 1121 |
| Lime | 2053 | 3307 | Lansing | 3048 - 1142 |
| | | | Base K.C. | 3301 - 1395 |
| | | | R.T.D. | 3307 - 1401 |

DST #1 2807-2827'

Op 60 min. SI 60 min. Op 30 min. SI 60 min. Initial flow, weak--dead in 50 min. Final flow, no blow. Recovered 30' drilling mud. Charts indicated anchor perforations plugging throughout test. IFP 48 FFP 42 ISIP 109 FSIP 1102

DST #2 2829-2880'

Op 60 min. SI 45 min. Op 30 min. SI 45 min. Initial flow, weak blow. Final flow, no blow. Recovered 30' mud with trace oil. IFP 40 FFP 54 ISIP 911 FSIP 884

USE ADDITIONAL SHEETS, IF NECESSARY, TO COMPLETE WELL RECORD.

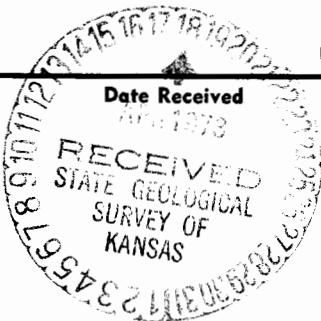

Dale Silcott
 Dale Silcott Signature
 Vice President Title
 4-4-73 Date